

GOVERNMENT CORNER RESTORATION FORM

FILED *JK*

Township 21S Range 9W Sec. 28 County DOUGLAS

State OR Date 5/20/92 No. JUN 3 1992

Corner Designation

WIT. COR
S29/S28
S32/S33

COUNTY SURVEYOR
DOUGLAS COUNTY, ORG.
Condition Report Only
 Not Found
 Renewed
 Unrecorded
 Surveyed In
 Referenced Out

MONUMENT DETAIL

Previous Renewals 1966 BLM RESURVEY #25

Monument(s) Found: (Condition and Source)

2 1/2" DIA. DCSO BRASS CAP ON A
1 1/2" O.D. IRON PIPE PROTRUDES
5" ABOVE GROUND. REN #25

COUNTY SURVEYORS OFFICE

T21S R9W
WIT. COR.

S29/S28
S32/S33

55 FT. EAST
TO COR.
1974

Accessories Found:

BAG'S + DIST TAKEN FROM DCSO WIT. COR.

18" NOW 24" DIA. HEMLOCK WITH A PARTIALLY HEALED DOUBLE
BLAZE. ILLIGIBLE SCRIBING VISIBLE, BEARS N10°W, 21.0 FT (REN 25)

24" NOW 23" DIA MAPLE WITH A PARTIALLY HEALED SINGLE
BLAZE, SCRIBING VISIBLE" WC T21S R9W S32" BEARS
S31°W, 52.2 FT. (REC. S32 1/2°W 52.2 FT) REN 25

EN. # 58
✓

Monument Set (Procedure and Description)

Monument Detail

NONE

N/A

New Accessories

60" NOW 95" DIA. D. FIR WITH A PREVIOUSLY OPENED HEALED BLAZE, BLAZE FACES SOUTHEAST, BEARS N 42 1/2° E, 49.0 FT (ORIG. BT)

35" NOW 33" DIA MAPLE WITH A FULLY HEALED DOUBLE BLAZE, BLAZE FACES NORTHEAST, BEARS S 45° E 44.1 FT (1966 BLM RE-SURVEY)

18" DIA MAPLE DOUBLE BLAZED AND SCRIBED "WC T 21 S R 2 W 5 3 3 CS BT" BEARS S 17° E 16.5 FT

Sketch of Monument, Accessories, and General Area

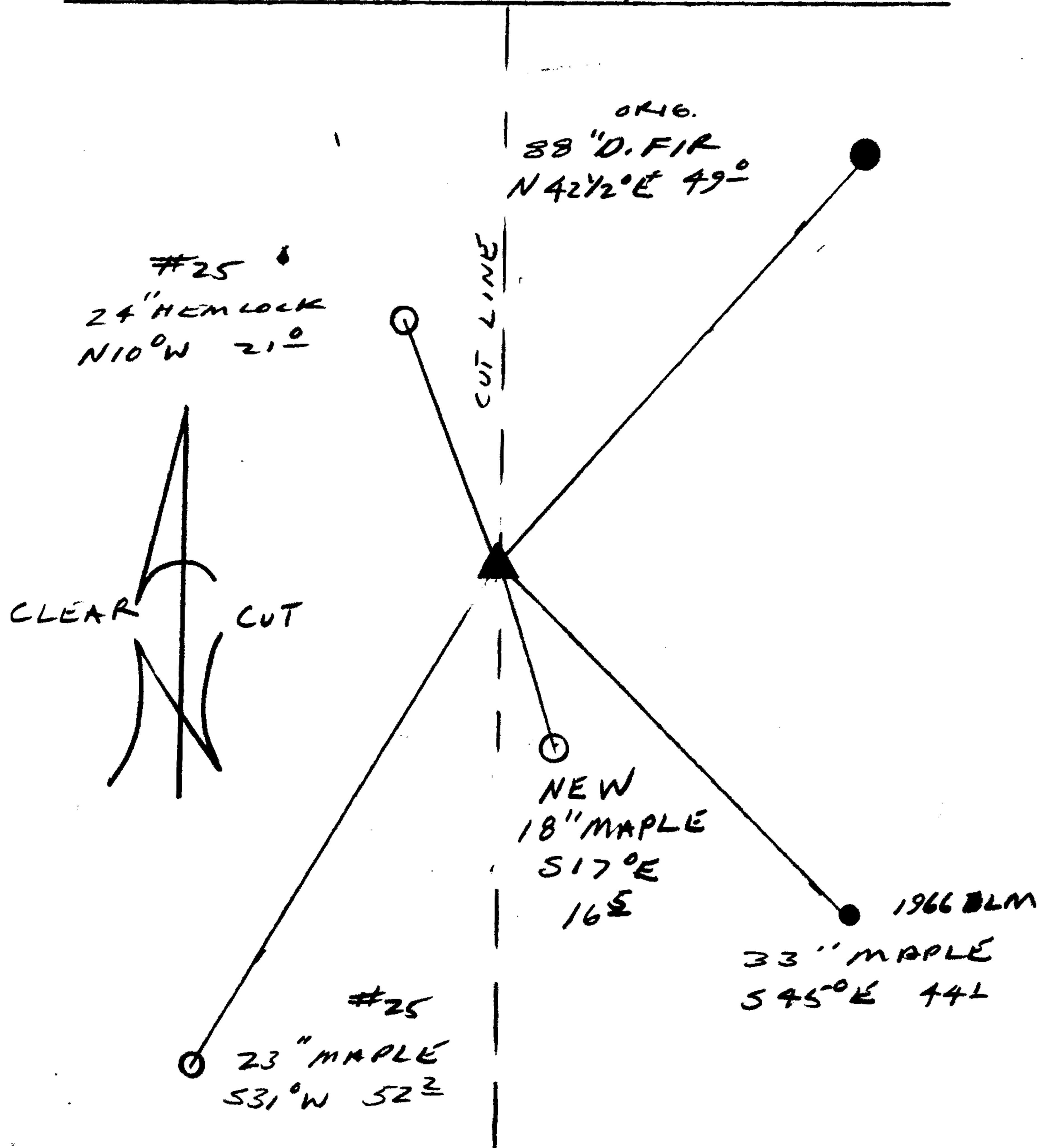

Location & Comments

Comp. Declin. 18° E
 Agency DCSD
 Party Chief RANDALL W SMITH
 Notekeeper Randall W Smith
 Witnesses JOHN PIKE

Address

REGISTERED
 PROFESSIONAL
 LAND SURVEYOR

Randall W Smith

OREGON
 JULY 25, 1990
 RANDALL W. SMITH
 2469

Surveyor's Seal