

Township 21S Range 7W Sec. 4 County DOUGLAS

State OR Date 4/7/92 No. \_\_\_\_\_

APR 10 1992

Corner Designation

55/S4  
58/S9

COUNTY SURVEYOR  
DOUGLAS COUNTY, ORE.

- Condition Report Only
- Not Found
- Renewed
- Unrecorded
- Surveyed In
- Referenced Out

Previous Renewals #26 #71

Monument(s) Found: (Condition and Source)

A 2 1/2" DIA. DCSO BRASS CAP  
ON A 1 1/4" O.D. IRON PIPE, #71  
PROTRUDING 5" ABOVE GROUND

A HAINES T IRON PROTRUDING  
9" ABOVE GROUND, #26. T. IRON  
BEARS S 16° W 8.4 FT FROM  
DCSO BC/IP.

HAINES T IRON WAS SET  
AT AN INTERSECTION OF ORIG.  
DISTANCES ORIG. BT'S BEAR  
S 81° E 26.4 FT  
N 23 1/2° W 12.1 FT

Accessories Found:

BRG'S + DIST'S TAKEN FROM 1962 DCSO BC/IP  
30" NOW 44" DIA. CEDAR WITH A PREVIOUSLY OPENED  
ORIG. BLAZE SCRIBING VISIBLE "T 22 B" AND A PARTIALLY  
HEALED RESCRIBING "S R 7W S 9". BT BEARS S 60° E,  
26.4 FT. (AGREES WITH REC.) ORIG. BT

30" NOW 50" DIA. CEDAR A PARTIALLY HEALED RESCRIBING  
ILLEGIBLE SCRIBING VISIBLE, BEARS N 50° W, 12.5 FT  
(AGREES WITH REN #71) ORIG. BT

12" NOW 18" DIA. D. FIR WITH A FULLY HEALED SINGLE  
BLAZE, BEARS N 79° E, 78.5 (REC. N 79° E 78.1  
DIST IS TO CNT TRUNK)

COUNTY SURVEYORS OFFICE

T 21S

55/S4

58/S9

R 7W

1962

#118 ✓

Monument Set (Procedure and Description)

NONE

Monument Detail

N/A

New Accessories

NONE

Sketch of Monument, Accessories, and General Area

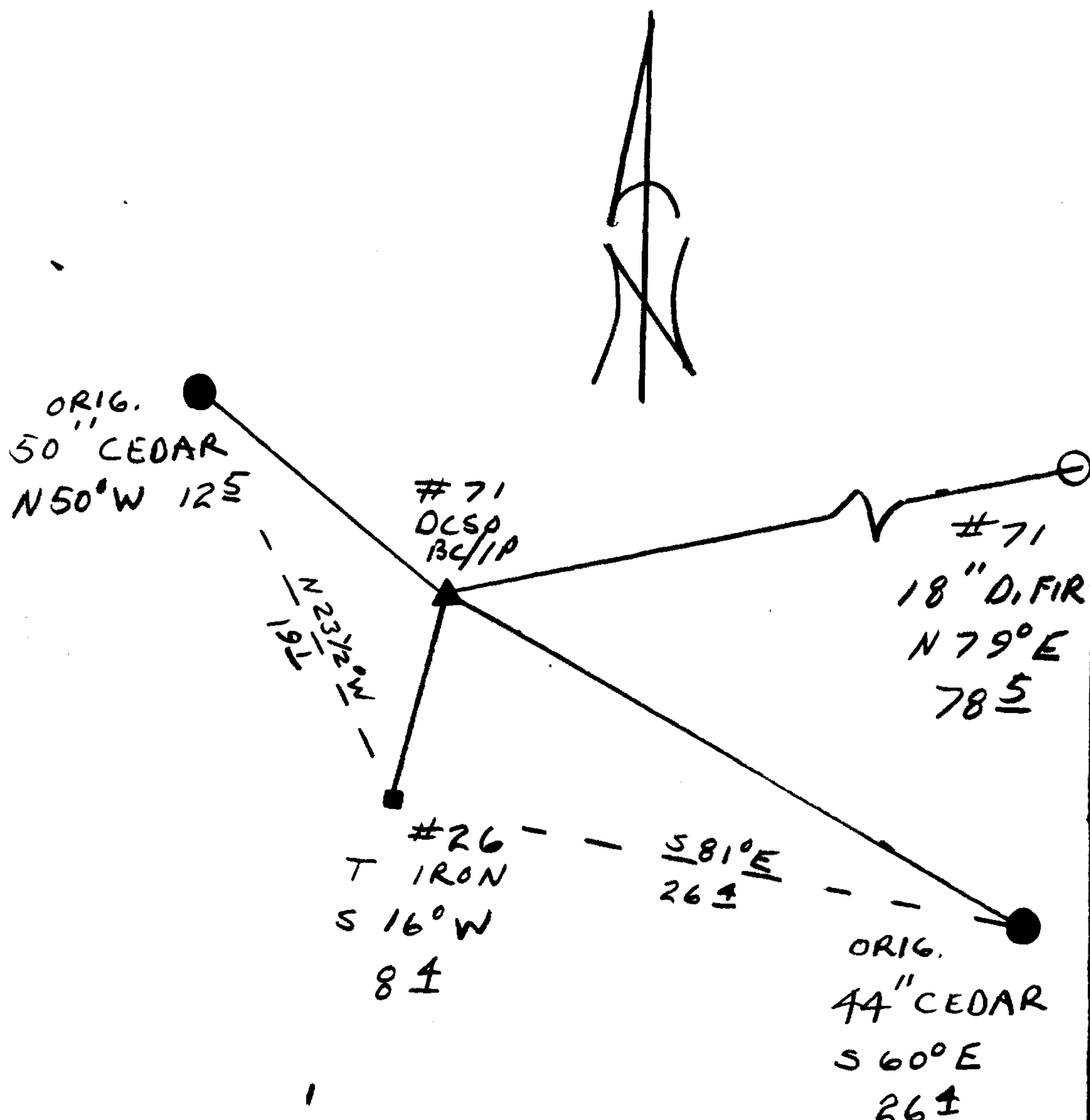

Location & Comments

CORNER LIES APPROX 150 FT EAST OF SMITH RIVER.

Comp. Declin. 18°E  
 Agency DCSG  
 Party Chief RANDALL W SMITH  
 Notekeeper Randall W Smith  
 Witnesses STEPHEN J FLAUSE  
TERRIE FRANSEN

Address

Surveyor's Seal  
 REGISTERED  
 PROFESSIONAL  
 LAND SURVEYOR

*Randall W Smith*

OREGON  
 JULY 25, 1990  
 RANDALL W. SMITH  
 2468