

GOVERNMENT CORNER RESTORATION FORM

FILED

Township 29S Range 7W Sec. 35 County DOUGLAS

State OR Date 12/19/91 No. _____

DEC 24 1991

COUNTY SURVEYOR
DOUGLAS COUNTY, ORE

Corner Designation _____

S34	S35
S3	S2

Condition Report Only
 Not Found
 Renewed
 Unrecorded
 Surveyed In
 Referenced Out

Previous Renewals 1924 GLO, #10 AND #151, 1964 GLO

Monument(s) Found: (Condition and Source) #37 T30-7

A 3 1/2" DIA GLO BRASS CAP ON
A 3" O.D. IRON PIPE PROTRUDING
14" ABOVE GROUND (1924 GLO SURVEY)

U.S. GENERAL LAND

T29 1/2 S	T29 S
R7W	
S34	S35
S3	S2
T30 S	R7W

1924
OFFICE SURVEY

Accessories Found:

16" NOW 27" DIA D. FIR WITH A FULLY HEALED
DOUBLE BLAZE, BEARS N52 1/2° E, 44.9 FT (REC.
N54° E, 44.9 FT) 1924 GLO

1924 GLO S75° E 27.7 FT BT IS GONE

8" NOW 11" DIA. 2 FT HIGH CEDAR STUMP, TREE IS
DOWN ALONG SIDE STUMP, SCRIBING VISIBLE "R7"
BEARS S26° W, 13.9 FT (AGREE WITH REC) 1924 GLO

30" NOW 36" DIA D. FIR WITH A FULLY HEALED DOUBLE
BLAZE, BEARS N27 1/2° W, 56.8 FT (AGREES WITH REC) 1924 GLO

6" NOW DOWN AND ROTTING 6" D. FIR WITH ILLEGIBLE
SCRIBING VISIBLE, BEARS N34° E, 25.1 FT (AGREES WITH REC)
REN #10 AND #151

13" NOW 12" DIA. 7' HIGH D. FIR STUMP WITH A FULLY HEALED
SINGLE BLAZE, BEARS S51° E, 13.9 FT (REC S54° E,
45.9 FT) (TAGGED BY B. MOYER IN 1958 TAG READS
N24 1/2° E, 21 LKS) UNSURE OF REASON FOR BAD BEC'S + DIST'S.
1964 GLO

8" NOW 13" DIA. W. FIR WITH A FULLY HEALED SINGLE BLAZE,
BEARS S36° W, 25.5 FT (REC. S36° W 26.1 FT DIST TO CENTER OF TRUNK)
1964 GLO

C.S. File No. 67/21-14

#A1 T30-7X
#291e T29-7

Monument Set (Procedure and Description)

Monument Detail

NONE

N/A

New Accessories

8" D. FIR DOUBLE BLAZED AND SCRIBED "T29S R7W S35 CS BT" BEARS N43°E, 8.4 FT.

Sketch of Monument, Accessories, and General Area

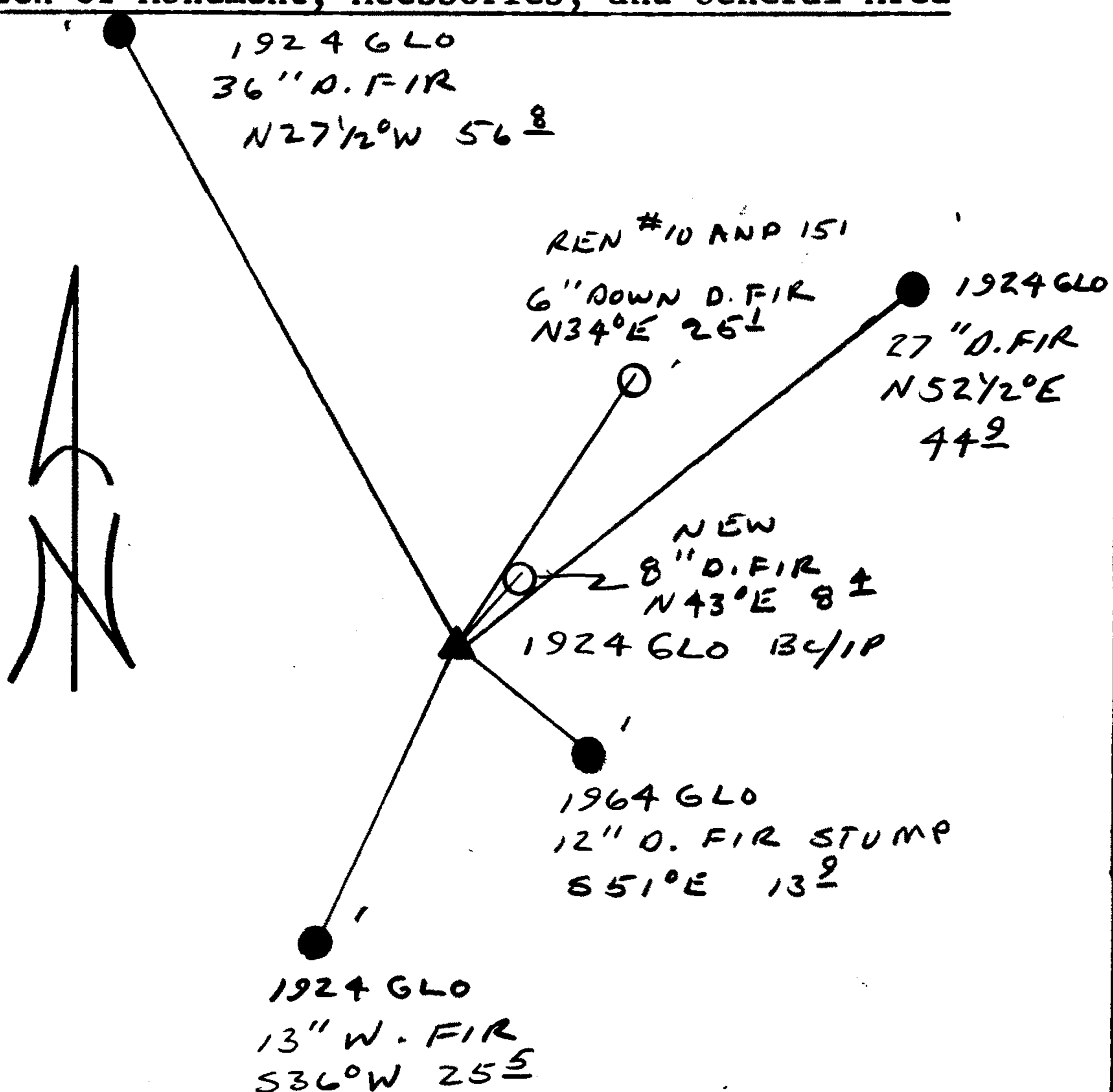

Location & Comments

CORNER LIES AT THE INTERSECTION OF A SOUTH AND EAST RUNNING GUT LINES, CLEAR CUT TO THE SOUTHEAST. APPROX 125' NORTH OF A GRAVEL ROAD.

Comp. Declin. 18°E
Agency DC SO
Party Chief RANDALL W SMITH
Notekeeper Randall W Smith
Witnesses STEPHEN J FLANK

Address

Surveyor's Seal

REGISTERED PROFESSIONAL LAND SURVEYOR

Randall W Smith

OREGON
JULY 25, 1990
RANDALL W. SMITH
2469