

GOVERNMENT CORNER RESTORATION FORM

FILED

Township 29S Range 1E Sec. 8 County DOUGLAS

*zh*

State OR Date 9/18/91 No. \_\_\_\_\_

OCT 3 1991

Corner Designation

COUNTY SURVEYOR  
DOUGLAS COUNTY, ORE.

HES  
144  
COR  
1

- Condition Report Only
- Not Found
- Renewed
- Unrecorded
- Surveyed In
- Referenced Out

Previous Renewals # 27

MONUMENT DETAIL

Monument(s) Found: (Condition and Source)

24" NOW 36" DIA 36" HIGH  
D. FIR STUMP WITH HEALED  
BLAZES ON FOUR SIDES. (ORIG.)

NOTE: STUMP IS SOUND

*N/A*

Accessories Found:

15" NOW 36" DIA. 3 1/2 FT HIGH D. FIR STUMP WITH A  
FULLY HEALED SINGLE BLAZE, BEARS N 18 1/2° E, 15.2 FT  
(AGREES WITH ORIG. REC. NOTE BRG MIXUP IN REN # 27)  
ORIG. BT

9" NOW 10" DIA 1 FT HIGH BATTED HEMLOCK STUMP  
NO SCRIBING OR BLAZES VISIBLE, BEARS S 30 1/2° W, 25.1 FT  
ORIG BT

10" NOW 13" DIA HEMLOCK WITH A PARTIALLY HEALED  
SINGLE BLAZE ILLEGIBLE SCRIBING VISIBLE, BEARS S 47° W,  
19.5 FT (REC S 47° W, 19.5 FT) REN # 27

2 1/2" DIA DESS BRASS CAP ON A 1 3/8" O.D. IRON PIPE  
PROTRUDING 15" ABOVE GROUND IS MARKED " T 295  
HES 144 BO COR # 1 RIE 1969" BEARS S 78° E, 2.5 FT  
(REC. EAST 3.0 FT) REN # 27

# 194 x  
ADD

C.S. File No. 6417-80

Monument Set (Procedure and Description)

Monument Detail

NONE

N/A

New Accessories

6" DIA. D. FIR DOUBLE BLAZED AND SCRIBED "1 HES 144 CS BT" BEARS S 8° W, 13.6 FT.

15" DIA. HEMLOCK DOUBLE BLAZED AND SCRIBED "1 HES 144 CS BT" BEARS N 17° W, 19.6 FT.

Sketch of Monument, Accessories, and General Area

Location & Comments

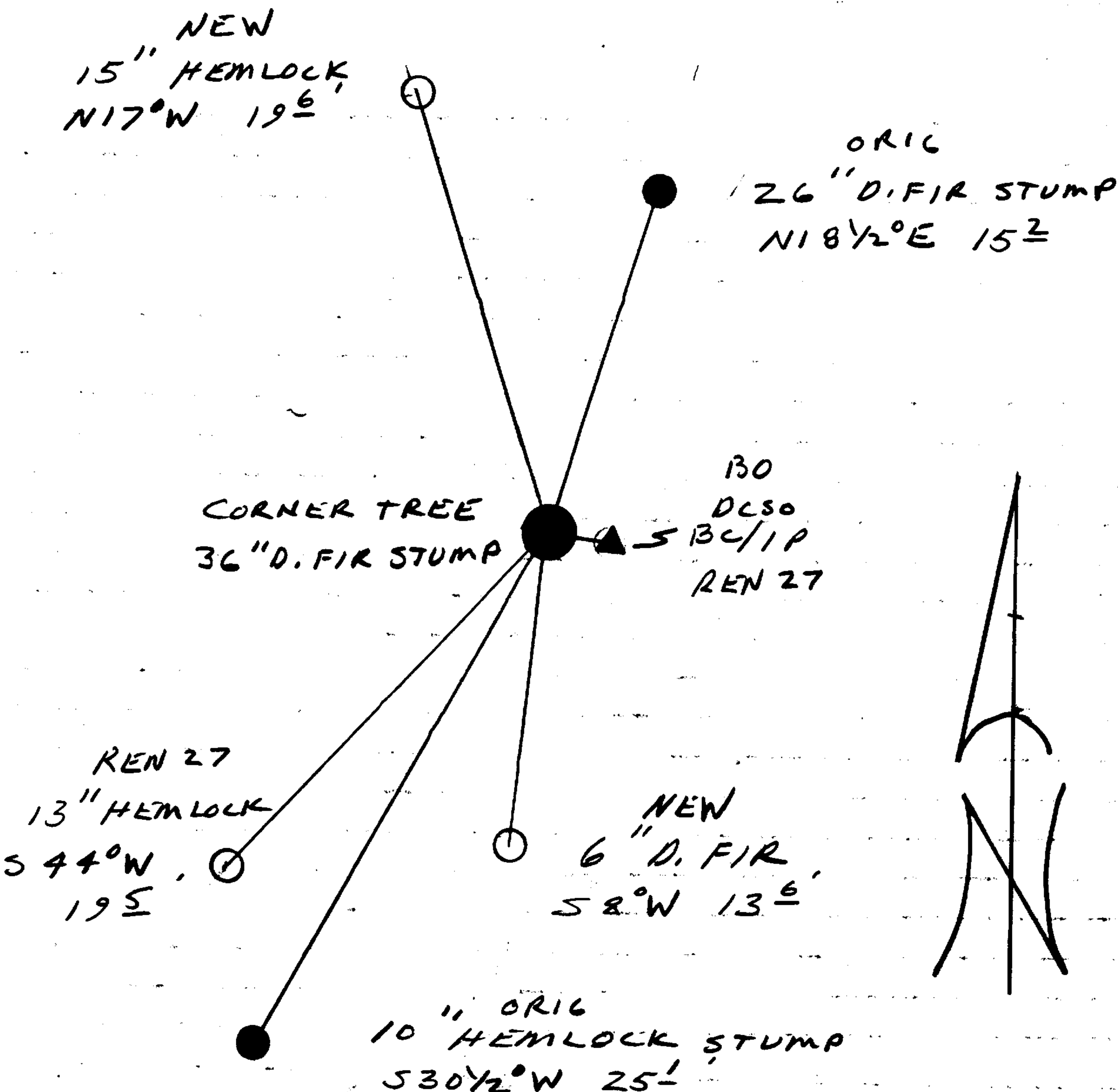

Comp. Declin. 18° E  
 Agency DCSO  
 Party Chief RANDALL W. SMITH  
 Notekeeper *Randall W. Smith*  
 Witnesses STEPHEN J. FLAUSE

Address

Surveyor's Seal

REGISTERED  
PROFESSIONAL  
LAND SURVEYOR

*Randall W. Smith*

OREGON  
JULY 25, 1990  
RANDALL W. SMITH  
2469