

GOVERNMENT CORNER RESTORATION FORM

FILED

JH

AUG 19 1991

Township 225 Range 8W Sec. 9 County DOUGLAS

State OREGON Date AUG 6, 1991 No. \_\_\_\_\_

COUNTY SURVEYOR  
DOUGLAS COUNTY, ORE.

Corner Designation

T225 R8W

DLC47

- Condition Report Only
- Not Found
- Renewed
- Unrecorded
- Surveyed In
- Referenced Out

Previous Renewals #18, #124, BLM 1963 RESURVEY

Monument(s) Found: (Condition and Source)

MONUMENT DETAIL

A RUSTED AND BENT 22 INCH LONG 1 1/2 INCH O.D. IRON PIPE FOUND OUT OF GROUND AND OUT OF POSITION APPROX. 533°W, 31 FEET DISTANT FROM CORNER LOCATION DETERMINED FROM FOUND B.T.'S. IRON PIPE MONUMENT IN RENEWAL #18 DESCRIBED AS 1 1/2 x 24 INCHES.

FOUND MONUMENT AND MISSING MONUMENT PROBABLY DISTURBED BY ROAD WORK TO NEARBY CLEAR-CUT.

N/A

Accessories Found:

EVIDENCE OF 2 ORIGINAL BEARING TREES FOUND.

A FIR 30 IN. DIA. NOW A ROTTED 40 INCH DIAM. 36 INCH TALL FIR STUMP WITH NO SCRIBING OR FACE EVIDENT; BEARS S07°E 69<sup>3</sup> FEET DISTANT (AS PER RECORD).

A FIR 9 IN DIA NOW FORKED FIR 45 INCHES D.B.H. WITH A FULLY HEALED BLAZE; BEARS S75°W, 11<sup>2</sup> FEET DISTANT (AGREES WITH BLM AND SUBSEQUENT RENEWALS ORIGINAL RECORD S60°W, 11<sup>2</sup> FEET.)

FROM RENEWAL #18 POSSIBLE EVIDENCE OF A 24" FIR, LATER CALLED A FIR 30 INS DIAM. IN BLM RESURVEY, NOW A BROKEN ROTTED 30 INCH DIAMETER 36 INCH TALL FIR STUMP WITH NO BLAZES OR SCRIBING FOUND; BEARS N45°W, 9<sup>2</sup> FEET DISTANT (BLM RESURVEY RECORD N40°W, 9<sup>2</sup> FEET DISTANT)

FROM 1963 BLM RESURVEY EVIDENCE OF RENEWAL B.T. FOUND. A FIR, 9 INS. DIAM. NOW A 36 INCH DIAMETER 12 INCH TALL FIR STUMP WITH THE POSSIBLE REMAINS OF A PARTIAL LOWER BLAZE BEARS S77 1/2°E, 48<sup>2</sup> FEET DISTANT AS PER RECORD.

#1744

Case File No. 64/17-30

Monument Set (Procedure and Description)

Monument Detail

AT LOCATION DETERMINED BY INTERSECTING DISTANCE MEASUREMENT FROM FOUND B.T.S AS NOTED ABOVE A 2 3/8 INCH DIAMETER BRASS CAP (MARKED AS AT RIGHT) ON A 1 1/4 INCH DO. 31 INCH LONG IRON PIPE IS FIRMLY SET PROTRUDING APPROX. 6 INCHES ABOVE THE GROUND. THE FOUND 1 1/2 INCH IRON PIPE IS SET ON THE SOUTH EDGE OF THE B.C. MONUMENT AND PROTRUDES 4 INCHES ABOVE GROUND.

DOUGLAS COUNTY SURVEYORS OFFICE

T22S R0W

S9 C47

1963

1991

Corrected  
5/13/97  
DCSO

New Accessories

A 4 INCH D.B.H. DOUGLAS FIR SCRIBED "X BT" ON A DOUBLE BLAZE; BEARS N180°E, 28 1/2 FEET DISTANT.

A 5 INCH P.B.H. DOUGLAS FIR SCRIBED "T22S R0W C47 CS BT" ON A DOUBLE BLAZE; BEARS S34°W, 53 1/2 FEET DISTANT.

Sketch of Monument, Accessories, and General Area

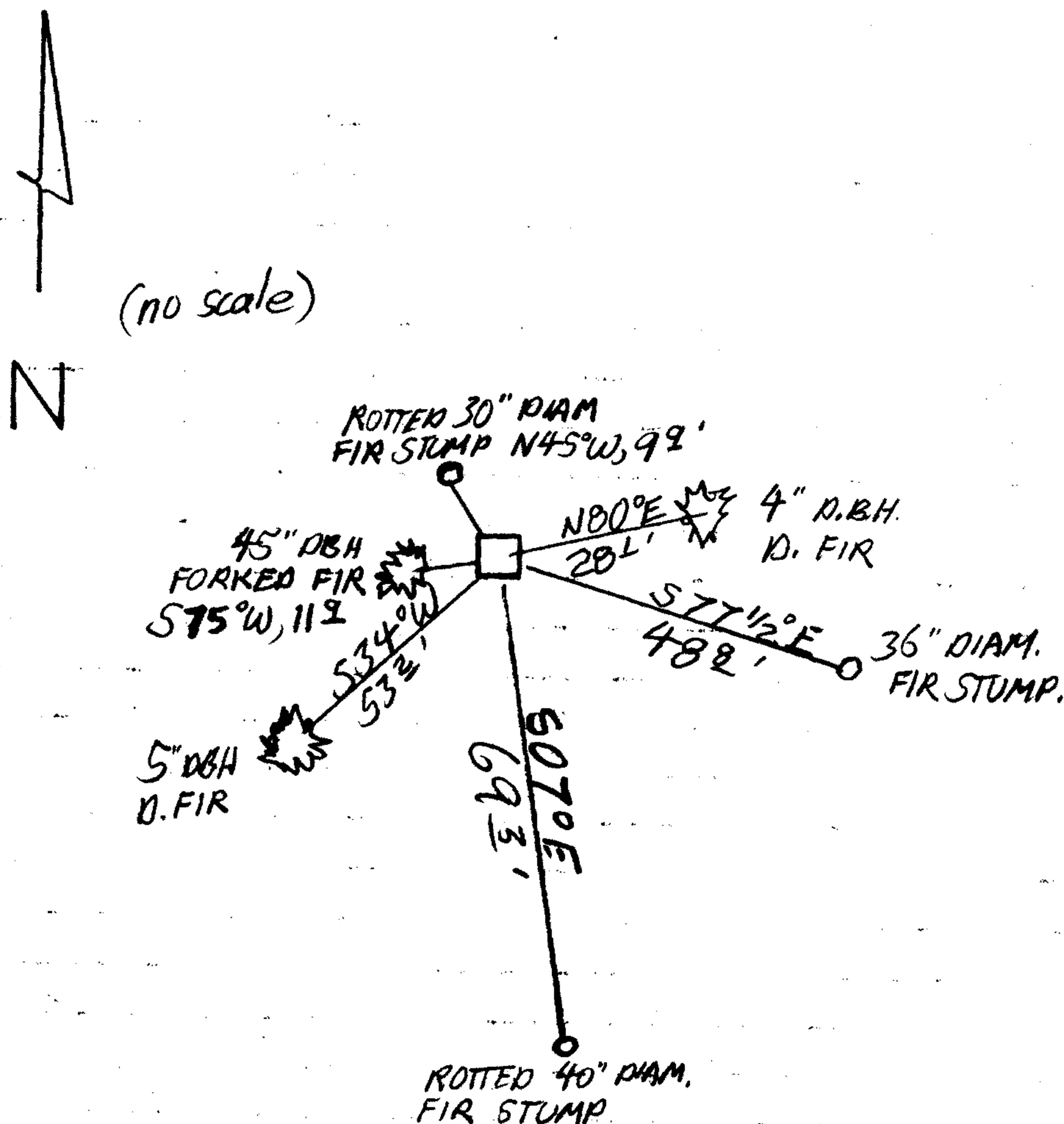

Location & Comments

APPROX 320 FEET SOUTHERLY ALONG SPUR ROAD FROM BLM RD. # 22-B-9.1

AT EDGE OF OLDER REPROD UNIT ON WIDE BENCH AND NEAR EDGE OF RECENT CLEAR CUT UNIT.

Comp. Declin. 18°E  
 Agency DCSO  
 Party Chief Stephen John Flause  
 Notekeeper S.J. FLAUSE  
 Witnesses T R FRANSSSEN

Address

SURVEYOR'S SEAL  
 REGISTERED  
 PROFESSIONAL  
 LAND SURVEYOR

Larry E. Monrean

OREGON  
 JULY 13, 1979  
 LARRY E. MONREAN  
 #1830