

GOVERNMENT CORNER RESTORATION FORM

FILED

*JK*

Township 30S Range 6W Sec. 17 County DOUGLAS

JUN 28 1991

State OR Date 5/7/91 No. \_\_\_\_\_

COUNTY SURVEYOR  
DOUGLAS COUNTY, ORE.

Corner Designation

S18 | S17  
S19 | S20

- Condition Report Only
- Not Found
- Renewed
- Unrecorded
- Surveyed In
- Referenced Out

Previous Renewals #33 #91 #181 #184

MONUMENT DETAIL

Monument(s) Found:	(Condition and Source)
A 2 1/2" O.C.S.O BRASS CAP ON A 1 1/2" O.D. IRON PIPE PROTRUDING 4" ABOVE GROUND (MARKED AS AT RIGHT)	
2 1/2" DIA BRASS CAP MARKED "T 30S R6W"	
18   17	
19   20	
2880 1957	
IS FLUSH WITH GROUND BEARS S 80° W 51.3 FT FROM 1964 O.C.S.O BC/IP. (REN #181)	
Accessories Found:	

COUNTY SURVEYORS OFFICE

T 30S

S18 | S17

S19 | S20

R 6W

1964

- 16" NOW 21" DIA. PINE WITH A FULLY HEALED DOUBLE BLAZE, BEARS N 82° W, 8.2 FT (REC S 83° W, 8.2 FT) REN #184
- 14" NOW 15" DIA PINE WITH 5 FT OF FILL AROUND BASE OF TREE, NO BLAZES VISIBLE, BEARS S 8° E 10.9 FT (AGREES WITH RECORD) REN #184
- 15" NOW 24" DIA PINE WITH A FULLY HEALED DOUBLE BLAZE, BEARS N 44° W, 70.5 FT (REC. N 44° W, 76.5 FT) REN #184
- 38" PINE BEARING N 23 1/2° E, 92.4 IN REN #184 IS GONE
- 18" NOW 22" DIA. PINE WITH A FULLY HEALED DOUBLE BLAZE BEARS N 88 1/2° W 34 ± FT (REC. N 86 1/2° W 29.7 FT) REN #91
- 24" NOW DOWN AND ROTTED PINE WITH STUMP OF INDETERMINABLE SIZE NO BLAZES OR SCRIBING VISIBLE BEARS N 22 3/4° E, 88 ± FT (REC. N 27 1/2° E, 92.4 FT.) REN #33.

#2544

RENEWAL

Monument Set (Procedure and Description)

NONE

Monument Detail

N/A

New Accessories

NONE

Sketch of Monument, Accessories, and General Area

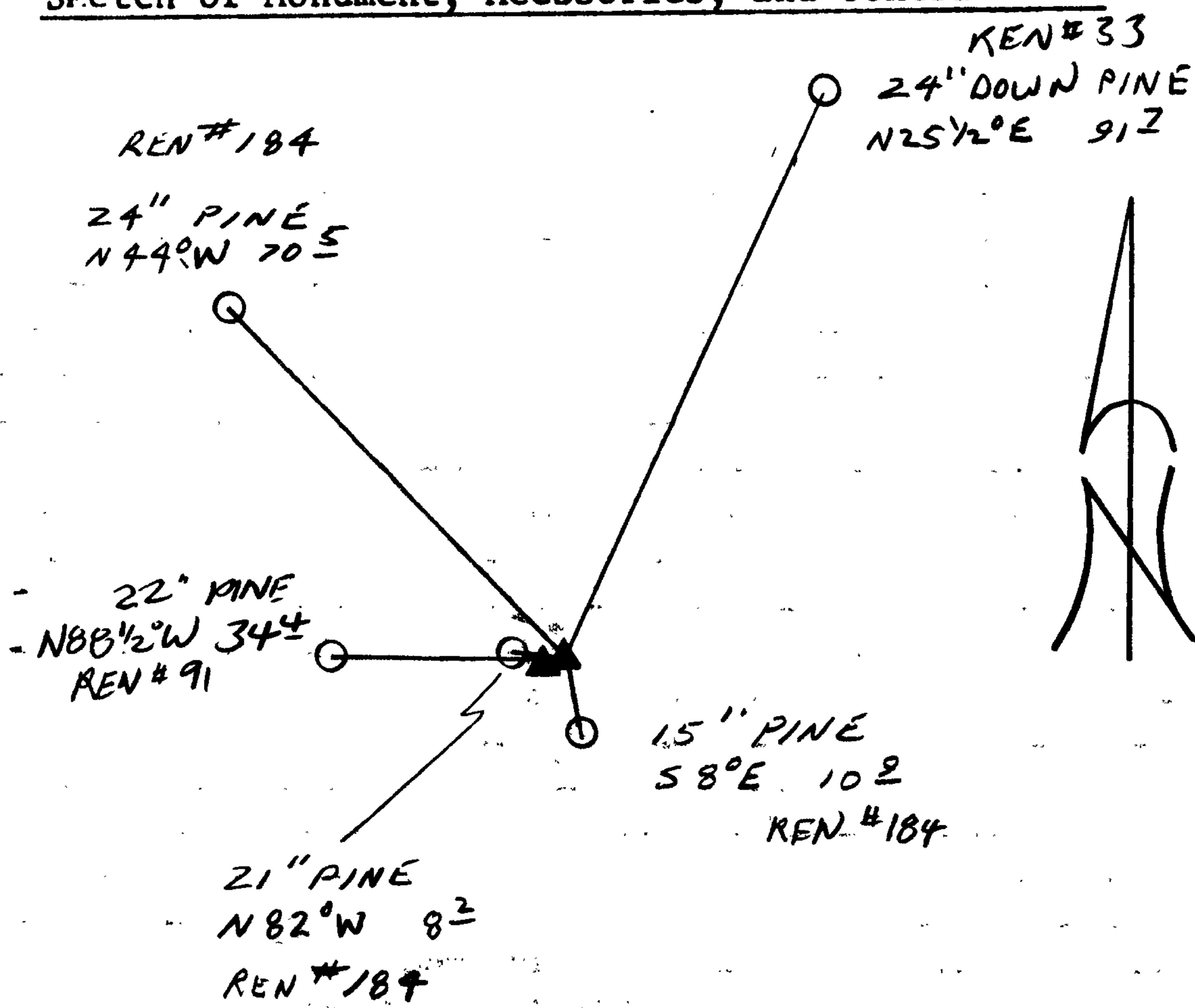

Location & Comments

Comp. Declin. 18° E  
 Agency DLSO  
 Party Chief RANDALL W SMITH  
 Notekeeper Randall W Smith  
 Witnesses STEPHEN J FLAKE  
TERRIE BRANSEN

Address

Surveyor's Seal  
 REGISTERED  
 PROFESSIONAL  
 LAND SURVEYOR

*Randall W Smith*

OREGON  
 JULY 25, 1990  
 RANDALL W. SMITH  
 2469