

GOVERNMENT CORNER RESTORATION FORM

FILED

JS

Township 30S Range 6W Sec. 28 County DOUGLAS

MAY 9 1991

State OREGON Date 4/29/91

No. _____

COUNTY SURVEYOR
DOUGLAS COUNTY, OREGON

Corner Designation _____

- Condition Report Only
- Not Found
- Renewed
- Unrecorded
- Surveyed In
- Referenced Out

Previous Renewals 1, 69, 156, 203

MONUMENT DETAIL

Monument(s) Found: (Condition and Source)

A 2 1/2 INCH DIAM BRASS CAP (MARKED AS AT RIGHT) ON A 1 3/8 INCH OD IRON PIPE FIRMLY SET, LEANING APPROX. 0.35 FEET SOUTHWESTERLY FROM PLUMB, AND PROTRUDING 12 INCHES ABOVE GROUND (REN#203)

THE BRASS CAP IRON PIPE MONUMENT DESCRIBED RENEWAL # 69 IS FOUND LOOSE ON GROUND SURFACE 4 FEET SOUTHWEST FROM ABOVE FOUND MONUMENT. IRON PIPE IS BROKEN, REMAINING PIPE AND BRASS CAP MEASURES APPROXIMATELY 12 INCHES LONG.

COUNTY SURVEYORS OFFICE
T30S R6W

NW COR
D.L.C. # 49
1969

(ACCESSORIES ARE CHECKED FROM PLUMB POSITION OF BC MONUMENT)

Accessories Found:

NO EVIDENCE OF ORIGINAL BEARING TREES REMAINS, SAME TREES REN#1.

FROM RENEWAL # 69 ONE BEARING TREE IS FOUND. NORTH EAST BEARING TREE REMOVED BY ROAD WORK. A 12 INCH FIR NOW BURNED FIR BARK AND ROOTS IN A STUMPHOLE BEARS WEST, 30' FEET DISTANT AS PER RECORD.

NO BEARING TREES DESCRIBED AS NEW IN RENEWAL # 156 ARE FOUND.

FROM RENEWAL # 203 TWO DESCRIBED BEARING TREES ARE FOUND

A 38 INCH W. OAK NOW A 39 INCH D.B.H. BLACK OAK WITH THE SCRIBING "C 49" VISIBLE IN A PARTIALLY HEALED DOUBLE BLAZE BEARS SOUTH 171.5 FEET DISTANT (AS PER RECORD).

A 42" W. OAK NOW A 44 INCH D.B.H. BLACK OAK WITH A FULLY HEALED DOUBLE BLAZE BEARS N 83 1/2 ° E, 124' FEET DIST (AS PER RECORD).

#250
251 ✓

RENEWAL

Monument Set (Procedure and Description)

Monument Detail

FOUND MONUMENT FROM RENEWAL # 203 IS RETURNED TO PLUMB POSITION. BROKEN MONUMENT FROM RENEWAL # 69 IS DEPOSITED ON WEST EDGE OF ABOVE MONUMENT.

New Accessories

AN 8 INCH D.B.H. MADRONE SCRIBED NW DLC 49 CS BT ON A DOUBLE BLAZED BEARS S 61° E, 41 1/2 FEET DISTANT

A 10 INCH P.B.H. JEFFREY PINE SCRIBED NW DLC 49 CS BT ON A DOUBLE BLAZE BEARS S 30° E, 33 1/2 FEET DISTANT.

Sketch of Monument, Accessories, and General Area

Location & Comments

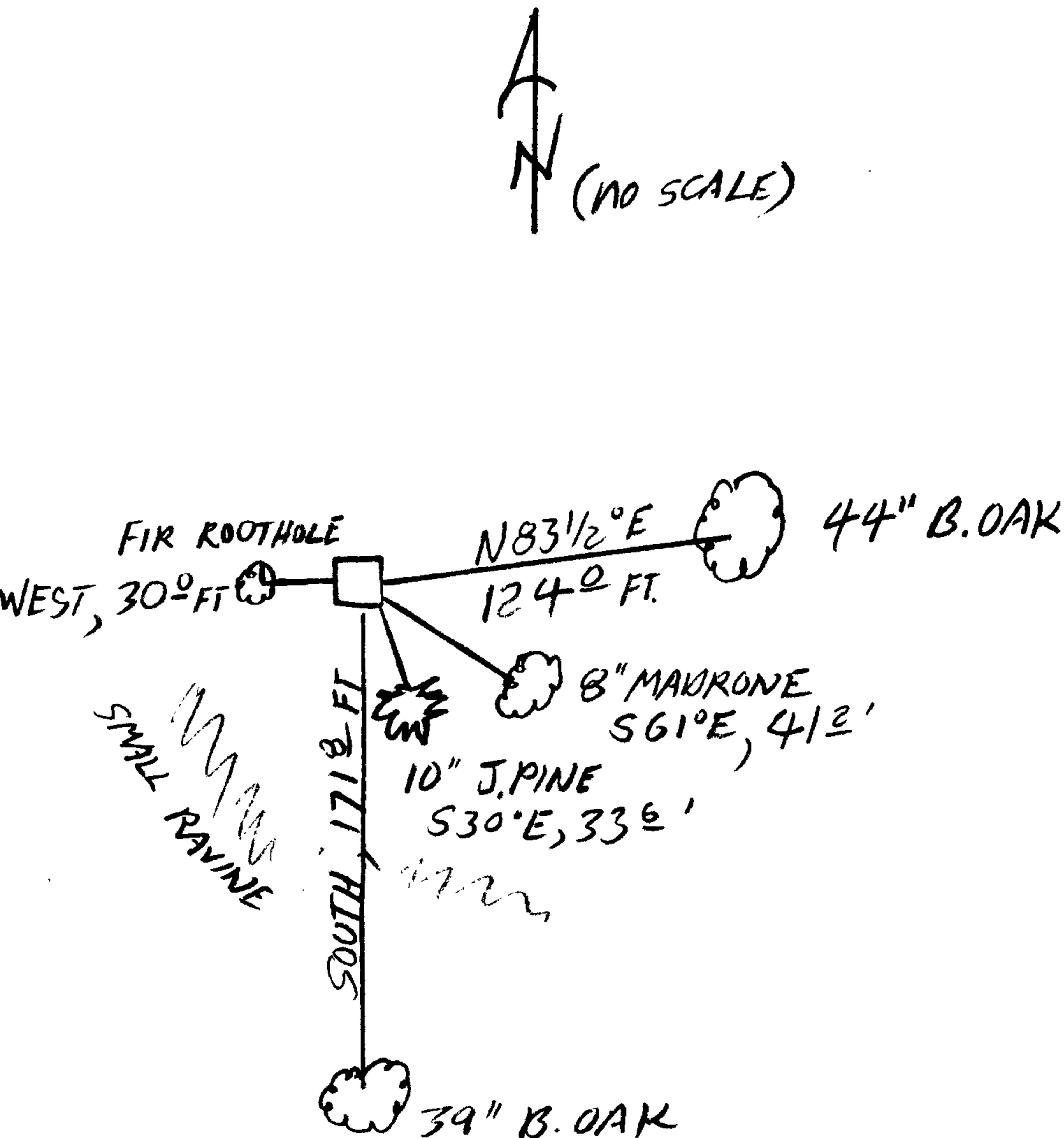

IN SCRUB AREA NORTHWEST FROM OPEN PASTURES.

Comp. Declin. 18° E
 Agency DCSD
 Party Chief S.J. FLAUSE
 Notekeeper Stephen John Flause
 Witnesses T.B. FRANSEN

Address

Surveyor's Seal
 REGISTERED
 PROFESSIONAL
 LAND SURVEYOR

Larry E. Monrean

OREGON
 JULY 13, 1979
 LARRY E. MONREAN
 #1930