

GOVERNMENT CORNER RESTORATION FORM

FILED

Township 30 Range 5W Sec. 33 County DOUGLAS

State OREGON Date 4/19/91 No. _____

Corner Designation

1/4
33 | 34

COUNTY SURVEYOR
DOUGLAS COUNTY, OREGON

- Condition Report Only
- Not Found
- Renewed
- Unrecorded
- Surveyed In
- Referenced Out

Previous Renewals DCSO SURVEY M15-33

Monument(s) Found: (Condition and Source)

A 2 1/2 INCH BRASS CAP MARKED AS AT RIGHT ON A 1 1/4 INCH O.D. IRON PIPE FIRMLY SET AND PROTRUDING APPROXIMATELY 14 INCHES ABOVE SOIL

COUNTY SURVEYORS OFFICE

T30S R5W

1/4 COR 533 | 534

1959

Accessories Found:

ALL ACCESSORIES DESCRIBED IN DCSO MAP M15-33 ARE FOUND. 6 1/2" CEDAR IS NOW A 22 INCH DBH CEDAR WITH A FULLY HEALED DOUBLE BLAZE; AN 18" LAUREL NOW A 20 INCH DIAMETER 24 INCH TALL MADRONE STUMP WITH A HEALED BLAZE FACE; AND A 1 INCH I.D. IRON PIPE IN A FENCELINE.

#321X

64/13-29C

RENEWAL

Monument Set (Procedure and Description)

Monument Detail

NA

33 POSITION FOR FOUND 1/4 CORNER MONUMENT (M15-53) IS DETERMINED TO BE IN ERROR AFTER BLM DEPENDENT RESURVEY OF A PORTION OF THE NORTH BOUNDARY OF T31S, R5W. THE BRASS CAP IS REMOVED FROM THE FOUND MONUMENT AND THE IRON PIPE IS LEFT IN THE POSITION DETERMINED BYRON; IT NOW PROTRUDES 10 INCHES ABOVE GROUND.

New Accessories

NONE

Sketch of Monument, Accessories, and General Area

Location & Comments

MONUMENT IS IN AREA OF ROAD WORK AND OLD CLEARINGS MUCH EVIDENCE OF OLD TREES HAS BEEN REMOVED FROM SITE SOUTH AND EAST FROM BYRON'S MON.

Comp. Declin. 19° E
 Agency NCSO
 Party Chief Stephen John Flause
 Notekeeper G.U. FLAUSE
 Witnesses T.R. FRANSSSEN

Address

Surveyor's Seal

REGISTERED
 PROFESSIONAL
 LAND SURVEYOR

Larry E. Monrean

OREGON
 JULY 13, 1979
 LARRY E. MONREAN
 #1830

Rm. 205 JUSTICE HALL
ROSEBURG, OR 97470

DOUGLAS COUNTY SURVEYOR

PH. 440-4272

CORNER RENEWAL REQUEST

Section 30 Twp. 5 Rge. 33

Date 1/11/91

1/4 Cor 33/34

Condition of Corner and Accessories: Cap # 156

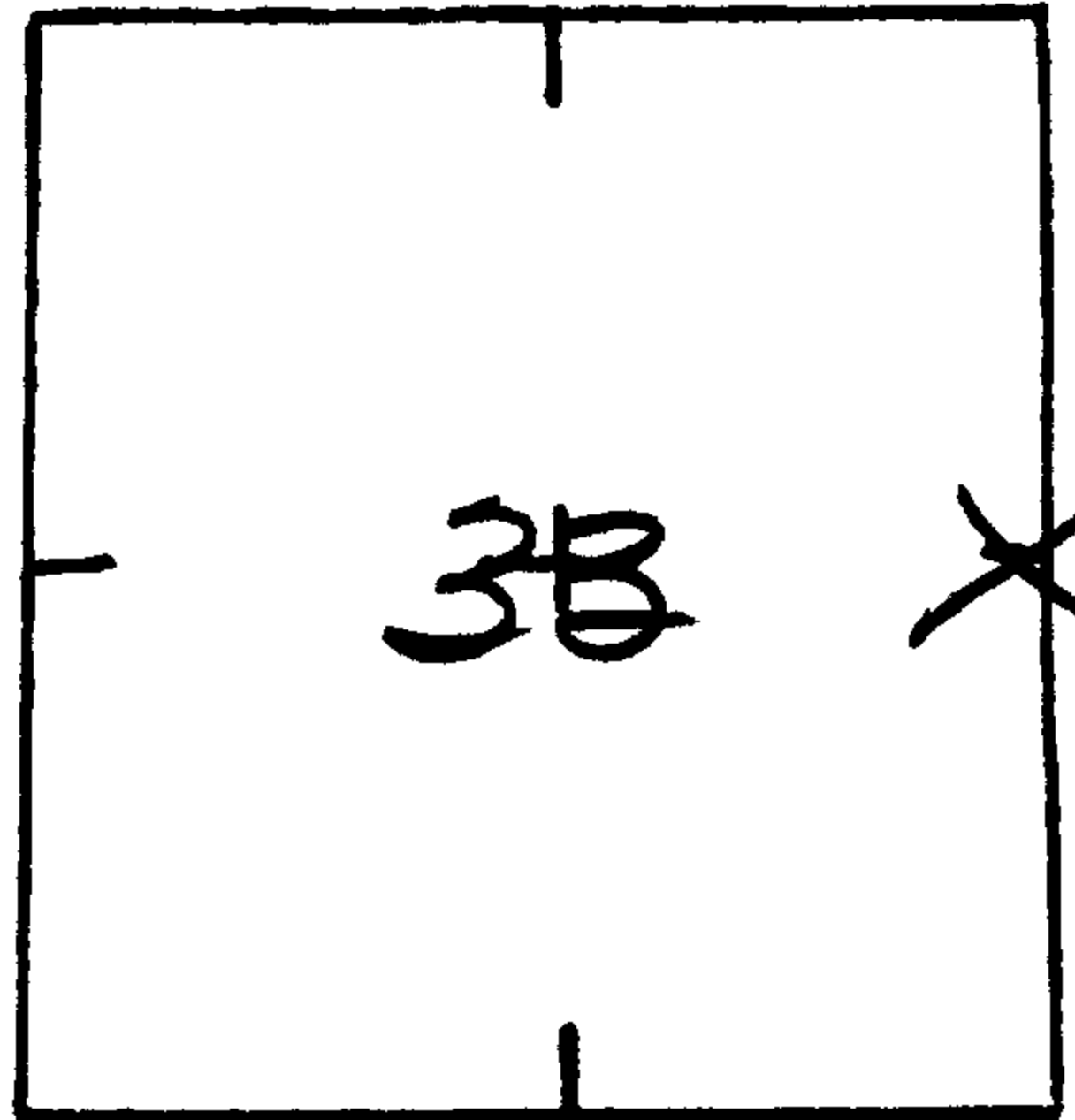

Please Investigate Byron Corner proportioned
on M 15-33 1959.

Cut Cap off per Fitz. Inappropriately set by
Byron - 11
(Look for evidence re: 1/4 Cor. (??))

0564/13

TO REACH: (Please show approximate distances, clearcuts, roads, fences, etc.) _____

Notify immediately prior to renewal visit? Yes _____ No _____

Notify following renewal visit? Yes _____ No _____

Is corner in immediate danger of being lost or disturbed? Yes _____ No _____

Name Vigoren (Fitz)
Address _____

Telephone _____

ADDITIONAL COMMENTS _____

