

GOVERNMENT CORNER RESTORATION FORM

FILED

Township 29S Range 5W Sec. 21 County DOUGLAS

APR 16 1991

State OR Date 4/12/91 No. \_\_\_\_\_

COUNTY SURVEYOR  
DOUGLAS COUNTY, OR

Corner Designation

$\frac{1}{4}$   $\frac{S21}{S28}$

- Condition Report Only
- Not Found
- Renewed
- Unrecorded
- Surveyed In
- Referenced Out

MONUMENT DETAIL

Previous Renewals #5 #29 #127 #159

Monument(s) Found: (Condition and Source)

A 2 1/2" DIA. DCSO BRASS CAP ON A  
1 1/4" O.D. IRON PIPE PROTRUDING  
14" ABOVE GROUND. (REN #127)

1991 DCSO BC/IP (NW COR DLG 45)  
BEARS EAST 93.7 FT (AGREES WITH REC)

COUNTY SURVEYORS OFFICE

T29S R5W

$\frac{1}{4}$   $\frac{S21}{S28}$

1962

Accessories Found:

8" NOW 6" DIA TIPPED OVER DEAD OAK NO SCRIBING VISIBLE  
BEARS S38°E, 73.9 FT (AGREES WITH REC.) REN #29

24" NOW 24" DIA. B/OAK. NOW ROOT HOLE  
WITH DECAYED WOOD, BEARS N41°W, 22.7 FT (AGREES WITH REC) REN #29

10" NOW 17" DIA W. OAK WITH A FULLY HEALED DOUBLE  
BLAZE, BEARS S23 3/4°W, 30.4 FT (AGREES WITH REN #5  
J. POWELL REC. OF S20°W, 33.0 FT IS THE REC. OF AN ORIG. BT)  
REN #5

18" NOW 33" SHELL OF A BURNT OUT 2 FT HIGH OAK, BEARS  
N63°E, 29.4 FT (REC. N59°E, 29.4 FT) ORIG BT

ORIG. SOUTHWEST BT IS GONE

6" NOW 10" DIA MADRONE WITH A FULLY HEALED DOUBLE BLAZE  
BEARS, N23°W, 53.6 FT (REC N20°W, 53.6 FT) REN #127

6" NOW 10" DIA MADRONE WITH A PARTIALLY HEALED DOUBLE BLAZE,  
SCRIBING VISIBLE "S28 CS BT" BEARS S42 1/2°E, 10.4 FT  
(AGREES WITH REC) REN #159

#229X

C.S. File No. 64/13-220

RENEWAL

Monument Set (Procedure and Description)

NONE

Monument Detail

N/A

New Accessories

8" DIA MADRONE DOUBLE BLAZED AND SCRIBED "Y4 S21 CS BT"  
BEAR N 7°E, 8.6 FT

Sketch of Monument, Accessories, and General Area

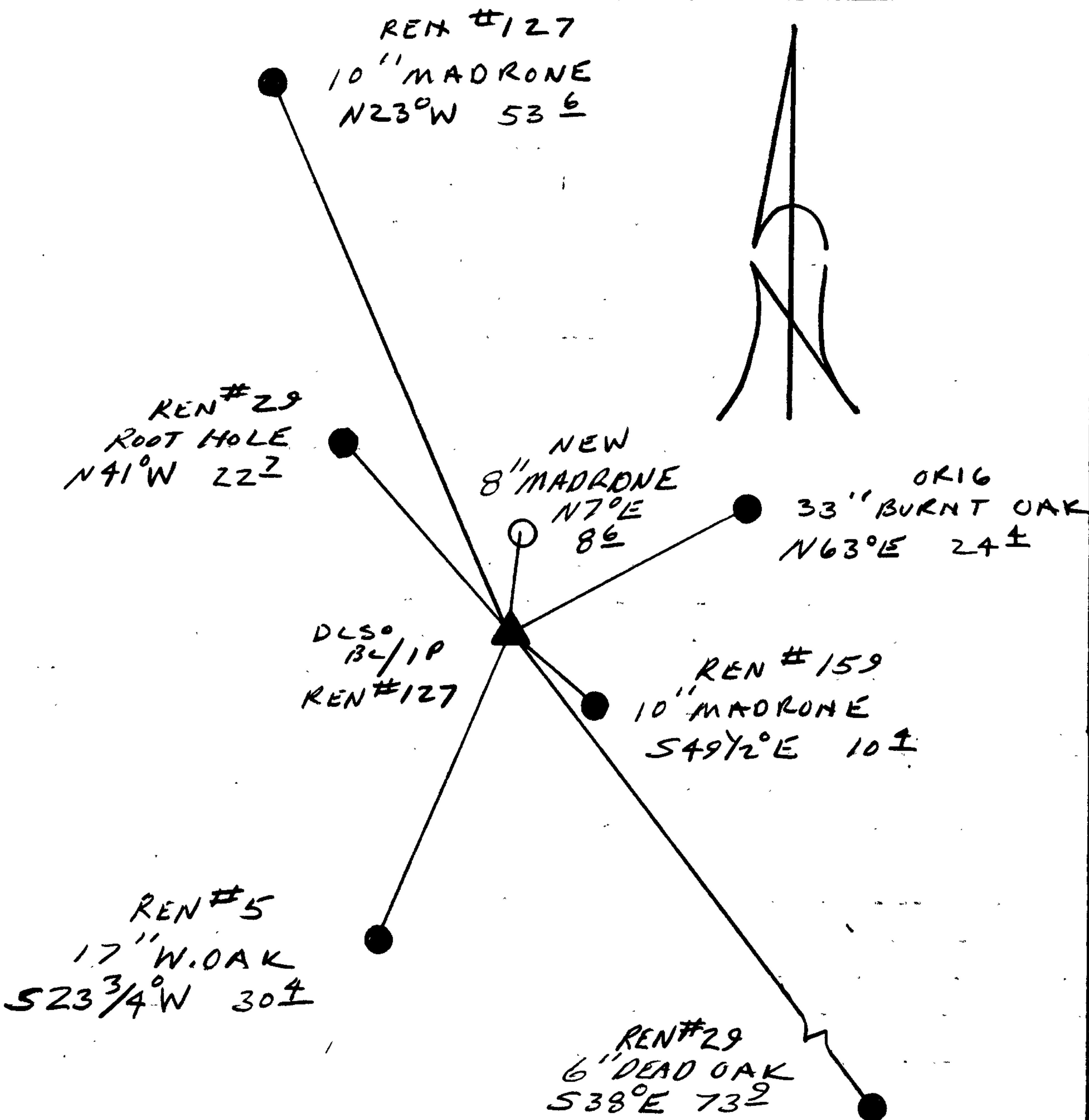

Location & Comments

Comp. Declin. 18°E  
 Agency DCSO  
 Party Chief RANDALL W SMITH  
 Notekeeper Randall W Smith  
 Witnesses TERRIE FRANSSEN

Address

Surveyor's Seal

REGISTERED  
PROFESSIONAL  
LAND SURVEYOR

*Randall W Smith*

OREGON  
JULY 25, 1990  
RANDALL W. SMITH  
2469