

GOVERNMENT CORNER RESTORATION FORM

FILED

Township 30S Range 2W Sec. 20 County DOUGLAS

MAR 27 1991

State OR Date 3/22/91 No. \_\_\_\_\_

Corner Designation \_\_\_\_\_

COUNTY SURVEYOR  
DOUGLAS COUNTY, OR

1/4 S 20 | ONLY

- Condition Report Only
- Not Found
- Renewed
- Unrecorded
- Surveyed In
- Referenced Out

Previous Renewals #178, #249

Monument(s) Found: (Condition and Source)

2 1/2" DIA. DCSO BRASS CAP ON  
A 1 1/4" O.D. X 36" LONG IRON PIPE  
TIPPED OVER EAST OF PLUMB, 1 FT  
BELOW GROUND. CREW #178

MONUMENT DETAIL

COUNTY SURVEYORS OFFICE

T30S R2W

1/4 S 20 |

1970

Accessories Found:

72" NOW 60" DIA. 7 FT HIGH CHARGED D. FIR STUMP  
WITH BLAZES, BEARS N 62° W, 47.5 FT (ORIG)

6" NOW 12" DIA. 2 1/2 FT TALL D. FIR STUMP TIPPED ON FACE  
OUT OF POSITION, NEAR REC. MARK (N 14° W, 51.1 FT) IS IN A SLIDE. REN #178

7" NOW 9" DIA. 5 FT HIGH HEMLOCK STUMP, SCRIBING  
VISIBLE ON AN UNHEALED BLAZE "1/4 S 20 CS" BEARS  
N 40° W, 27.4 FT. REN #249

#276 x

RENEWAL

Monument Set (Procedure and Description)

Monument Detail

DCSO BL/IP RETURNED TO PLUMB,  
NOW PROTRUDES 8 IN ABOVE STONES,  
(CORNER IS IN A ROCK SLIDE).

N/A

New Accessories

12" DIA. 12 FT HIGH PISTOL BUTT MAPLE STUMP WITH A PK NAIL  
SET THROUGH BT TAG ON SOUTH SIDE OF STUMP, 2 FT  
ABOVE GROUND, PK NAILS BEARS S 40° W, 3.4 FT.

12" DIA 3 FT HIGH MAPLE STUMP WITH A BOAT SPIKE STAMPED  
"B01" SET THROUGH BT TAG NEAR CENTER OF STUMP, BS  
BEARS N 2° E, 65.1 FT

Sketch of Monument, Accessories, and General Area

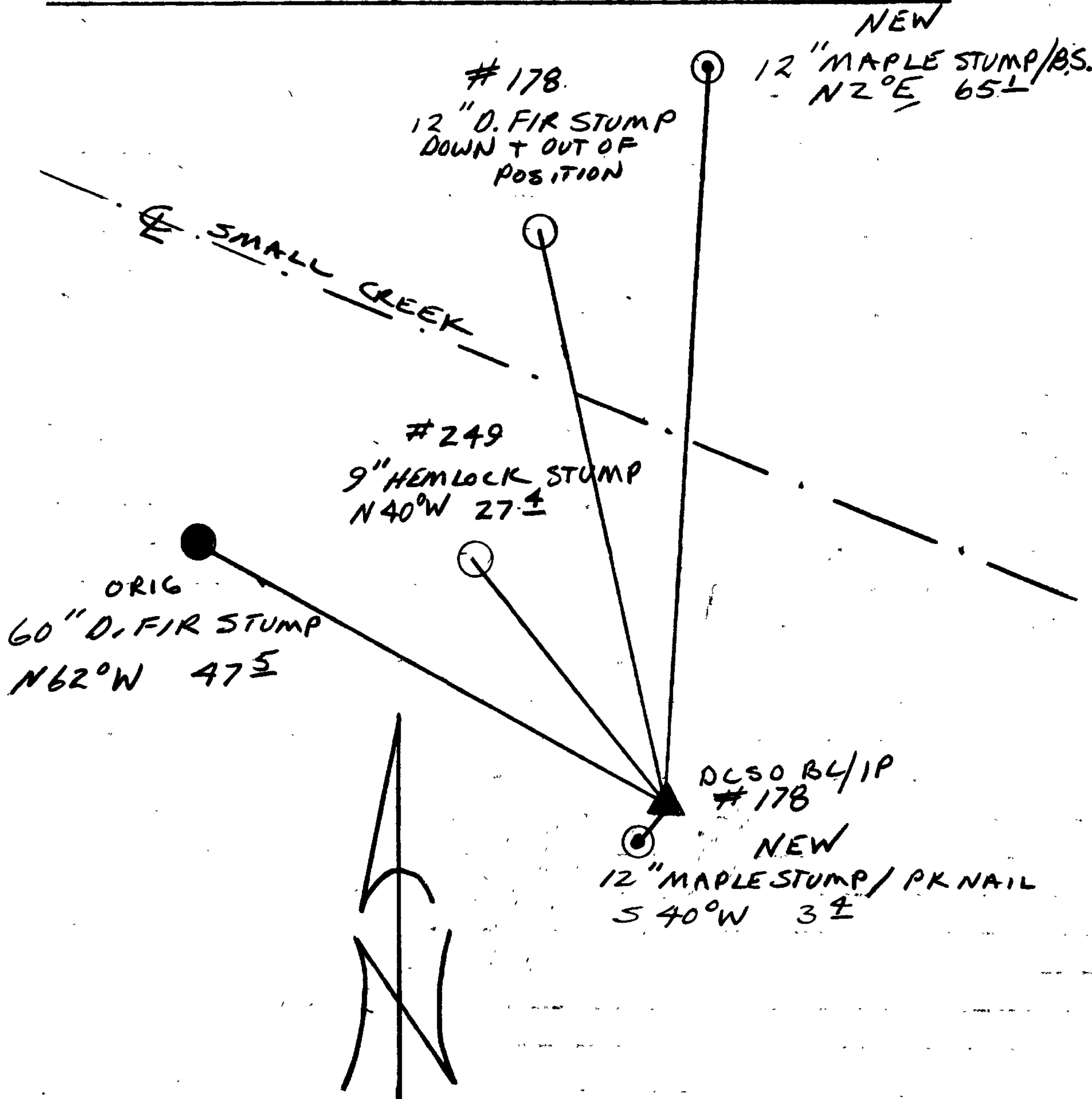

Location & Comments

Comp. Declin. 18° E  
Agency DCSO  
Party Chief RANDALL W SMITH  
Notekeeper Randall W Smith  
Witnesses STEPHEN J FLAUS  
TERRIE FRANSEN

Address

REGISTERED  
PROFESSIONAL  
LAND SURVEYOR

*Randall W Smith*

OREGON  
JULY 25, 1990  
RANDALL W. SMITH  
2469