

GOVERNMENT CORNER RESTORATION FORM

FILED

Township 24S Range 5W Sec. 1 County DOUGLAS

SK

MAR 11 1991

State OR Date 3/4/91 No. _____

Corner Designation _____

COUNTY SURVEYOR
DOUGLAS COUNTY, ORE.

Condition Report Only

Not Found

Renewed

Unrecorded

Surveyed In

Referenced Out

MONUMENT DETAIL

S2 | S1
S11 | S12

Previous Renewals #48

Monument(s) Found: (Condition and Source)

A 2 1/2" DIA. DCSO BRASS CAP. ON.

A 1/4" O.D. IRON PIPE, PROTRUDES

1/4" ABOVE GROUND. FROM REN #48

COUNTY SURVEYOR'S OFFICE

T24 S R5W

S2 | S1
S11 | S12

1960

Accessories Found:

9" NOW 23" DIA. W. OAK WITH A FULLY HEALED BLAZE,
BEARS N26°E, 63.5 FT (AGREES WITH REC.) ORIG. BT

40" NOW 32" DIA. 1 FT HIGH OAK STUMP WITH A ROTTED
OUT CENTER, BEARS S42 1/2°W, 27.1 FT (AGREES WITH REC.) ORIG. BT

NO OTHER ORIG. BT'S FOUND

8" NOW 11" DIA. W. OAK WITH A FULLY HEALED BLAZE, BEARS
N72°W, 4.9 FT (AGREES WITH REC.) REN #48

12" NOW 16" DIA. W. OAK WITH A FULLY HEALED BLAZE, BEARS
S39°E, 18.8 FT (AGREES WITH REC.) REN #48

8" NOW 13" DIA. W. OAK WITH A FULLY HEALED BLAZE, BEARS
S18°W, 43.7 FT (AGREES WITH REC.) REN #48

#1154

RENEWAL

Monument Set (Procedure and Description)

NONE

Monument Detail

N/A

New Accessories

NONE

Sketch of Monument, Accessories, and General Area

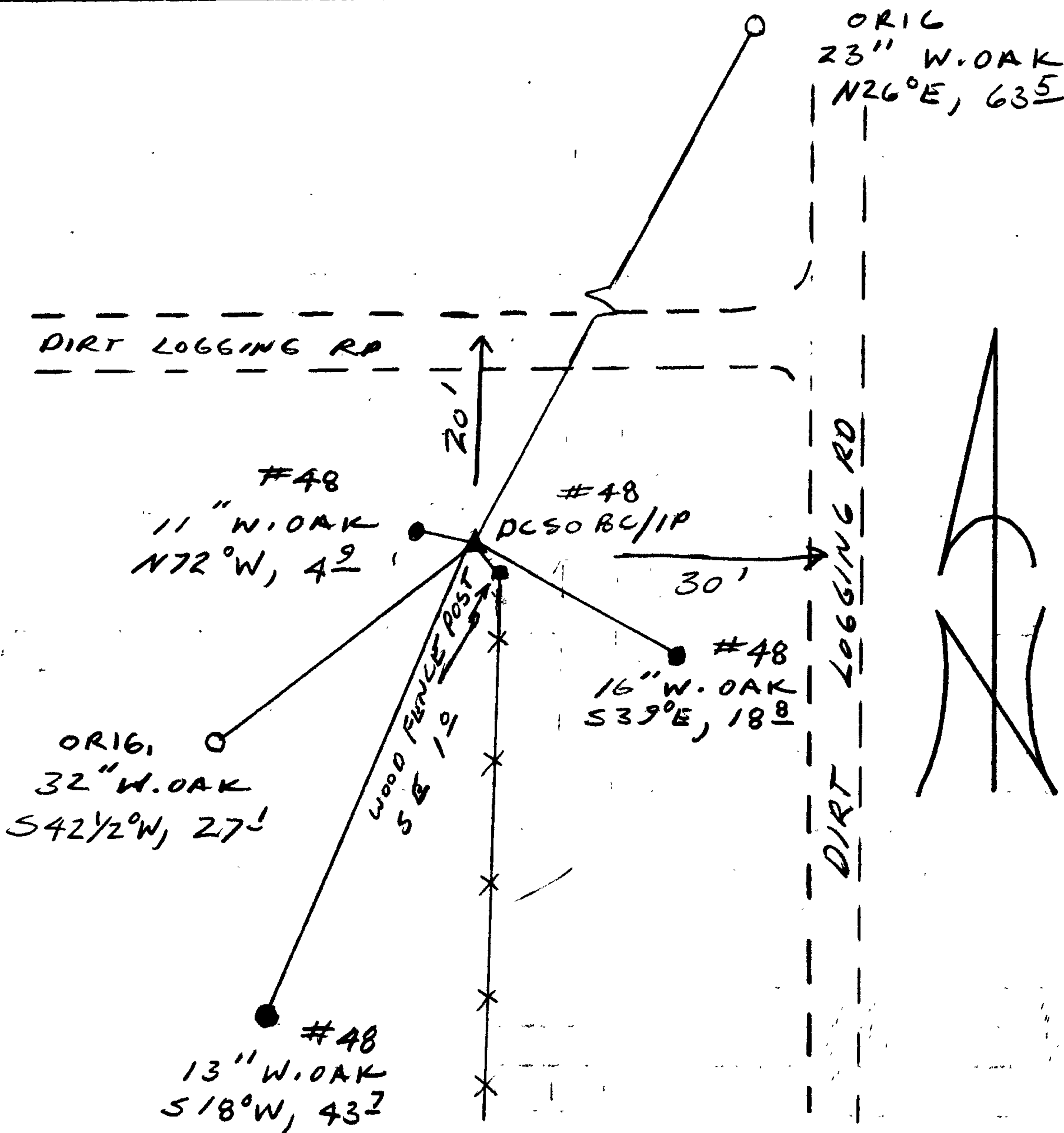

Location & Comments

CORNER LIES AT THE END OF A SOUTH RUNNING FENCE LINE, NEAR THE INTERSECTION OF DIRT LOGGING ROADS

Comp. Declin. 18°E
 Agency DLSO
 Party Chief RANDALL W SMITH
 Notekeeper Randall W Smith
 Witnesses STEPHEN J. FLAUSE
TERRIE FRANSSEN

Address

Surveyor's Seal

REGISTERED
 PROFESSIONAL
 LAND SURVEYOR

Randall W Smith

OREGON
 JULY 25, 1998
 RANDALL W. SMITH
 2469