

GOVERNMENT CORNER RESTORATION FORM

FILED

Township 25S Range 7W Sec. 33 County DOUGLAS

FEB 1 1991

State OR Date 1/17/91 No. \_\_\_\_\_

COUNTY SURVEYOR  
DOUGLAS COUNTY, ORE.

Corner Designation

33 | 34  
4 | 3

- \_\_\_\_\_ Condition Report Only
- \_\_\_\_\_ Not Found
- Renewed
- \_\_\_\_\_ Unrecorded
- \_\_\_\_\_ Surveyed In
- \_\_\_\_\_ Referenced Out

Previous Renewals (T25-7) (#27 & 75 T26-7)  
#45, #81, 1975 BLM RESURVEY

MONUMENT DETAIL

Monument(s) Found: (Condition and Source)

2 1/2" DIA. DCSD BRASS CAP ON A  
1 1/2" O.D. IRON PIPE, PROTRUDING  
14" ABOVE GROUND. (REN #81)

1 1/8" O.D. AXLE SHAFT PROTRUDES  
3" ABOVE GROUND (REN #45)  
AXLE SHAFT IS SOUTH 0.4 FT  
FROM DCSD B.C./IP.

COUNTY SURVEYORS OFFICE

T25S

S33/S34 R  
7  
S4/S3 W  
T26S  
1966

Accessories Found:

NO ORIGINAL BT'S

15" NOW 24" DIA. 5 FT HIGH D. FIR STUMP WITH A FULLY HEALED  
DOUBLE BLAZE, BEARS S25°W, 8.6 FT (REC. S30 1/2°W, 8.6 FT  
IN BLM RESURVEY) REN #45

BT'S FROM REN #81 ARE GONE

14" NOW 20" DIA. D. FIR WITH A FULLY HEALED SINGLE BLAZE,  
BEARS S71 1/2°E, 96.0 FT (REC. S66°E, 96.0 FT) 1975 BLM  
RESURVEY

#146 T25-7 ✓  
#120 T26-7 ✓

RENEWAL

Monument Set (Procedure and Description)

NONE

Monument Detail

N/A

New Accessories

A MULTI TRUNKED ELDER BERRY DOUBLE BLAZED AND SCRIBED "X BT" ON 12" DIA. NEAR TRUNK, BEARS N 41 1/2° E, 83.2 FT.  
 5" DIA. B. OAK DOUBLE BLAZED AND SCRIBED "X BT" BEARS S 78° W, 17.4 FT.  
 7" DIA. PISTOL BUTT MAPLE DOUBLE BLAZED AND SCRIBED "T 255 R 7W S 33 CS BT" BEARS N 59° W, 104.5 FT TO CENTER OF TRUNK AT UPPER BLAZE.

Sketch of Monument, Accessories, and General Area

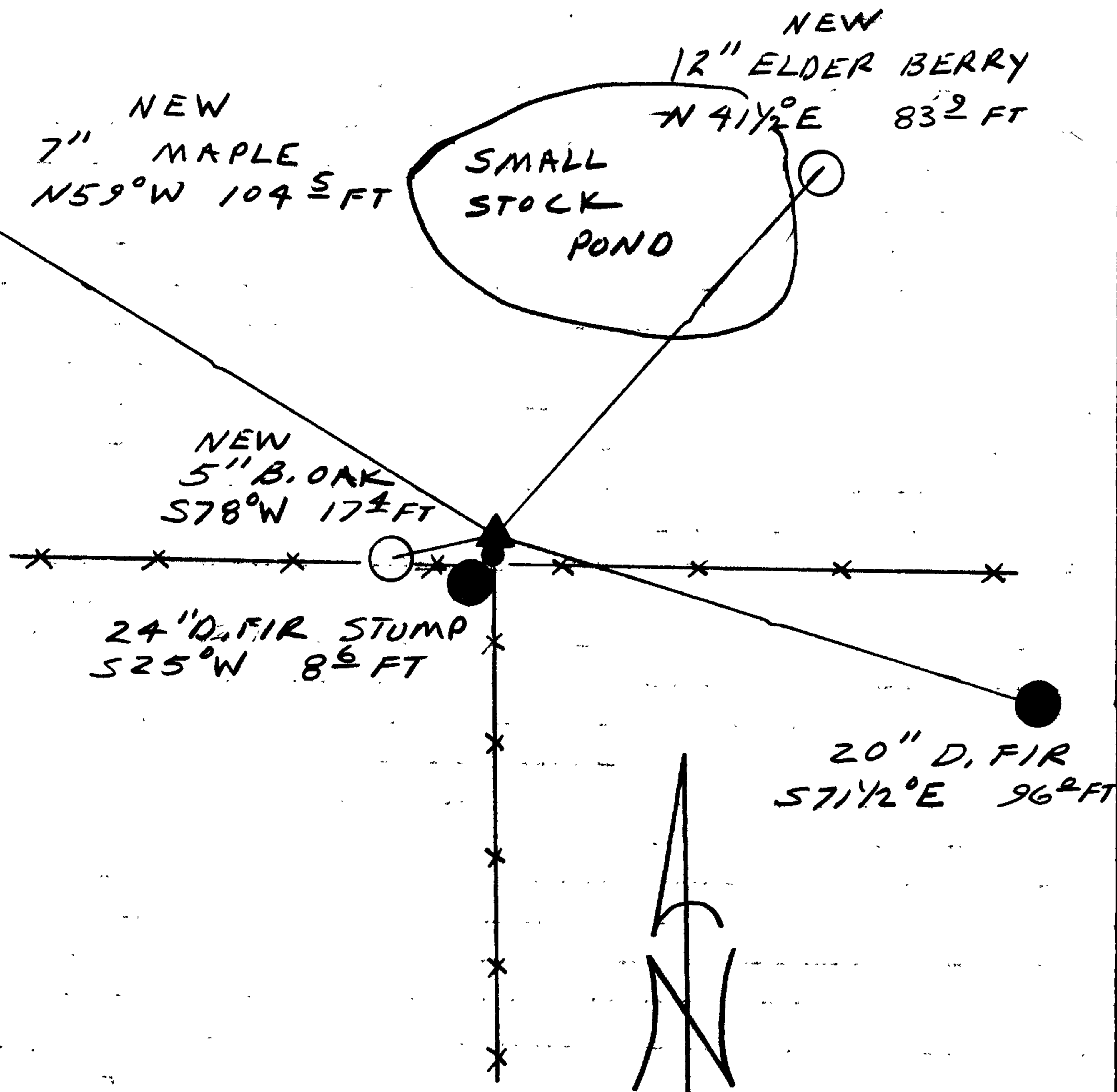

Location & Comments

Comp. Declin. 18° E  
 Agency DLCSO  
 Party Chief RANDALL W. SMITH  
 Notekeeper Randall W. Smith  
 Witnesses STEPHEN J. FLAUS  
TERRIE FRANSSEAL

Address

Surveyor's Seal

REGISTERED  
 PROFESSIONAL  
 LAND SURVEYOR

*Randall W. Smith*

OREGON  
 JULY 25, 1990  
 RANDALL W. SMITH  
 2469