

GOVERNMENT CORNER RESTORATION FORM

FILED

AUG 20 1990

Township 25S Range 2W Sec. 27 County DOUGLAS

State OR Date 8/16/90 No. _____

COUNTY SURVEYOR
DOUGLAS COUNTY, ORE.

Corner Designation

1/4 528 | 527

- _____ Condition Report Only
- _____ Not Found
- Renewed
- _____ Unrecorded
- _____ Surveyed In
- _____ Referenced Out

Previous Renewals 1962 BLM SURVEY

Monument(s) Found: (Condition and Source)

A 3/2" DIA. BLM BRASS CAP ON
2 1/2" DIA. IRON PIPE PROTRUDING
10" ABOVE GROUND (1962 BLM SURVEY)

U.S. DEPT. OF THE INTERIOR

1/4
 528 | 527
 T25S R2W
 1962

BUR. OF LAND MANAGEMENT

Accessories Found:

36" NOW 43" DIA. D. FIR WITH A FULLY HEALED SINGLE BLAZE,
BEARS S42°E, 17.8 FT (AGREES WITH RECORD), ORIG. BT
(THIS BT TO BE CUT IN FUTURE TIMER SALE).

18" NOW 18" DIA. DEAD HEMLOCK WITH A PARTIALLY HEALED BLAZE,
SCORING IS VISIBLE "S 28 B", BEARS N10°W, 16.5 FT (RECORD
N10°W, 15.8 FT) 1962 BLM

RENEWAL

Monument Set (Procedure and Description)

NONE

Monument Detail

N/A

New Accessories

- 3" DIA. HEMLOCK DOUBLE BLAZED AND SCRIBED "X BT" BEARS S46°W, 50.1 FT
- 7" DIA. R. CEDAR DOUBLE BLAZED AND SCRIBED "1/4 S27 CS BT" BEARS N15 3/4°E, 32.6 FT
- 8" DIA. R. CEDAR DOUBLE BLAZED AND SCRIBED "1/4 S27 CS BT" BEARS N69°E, 19.3 FT

Sketch of Monument, Accessories, and General Area

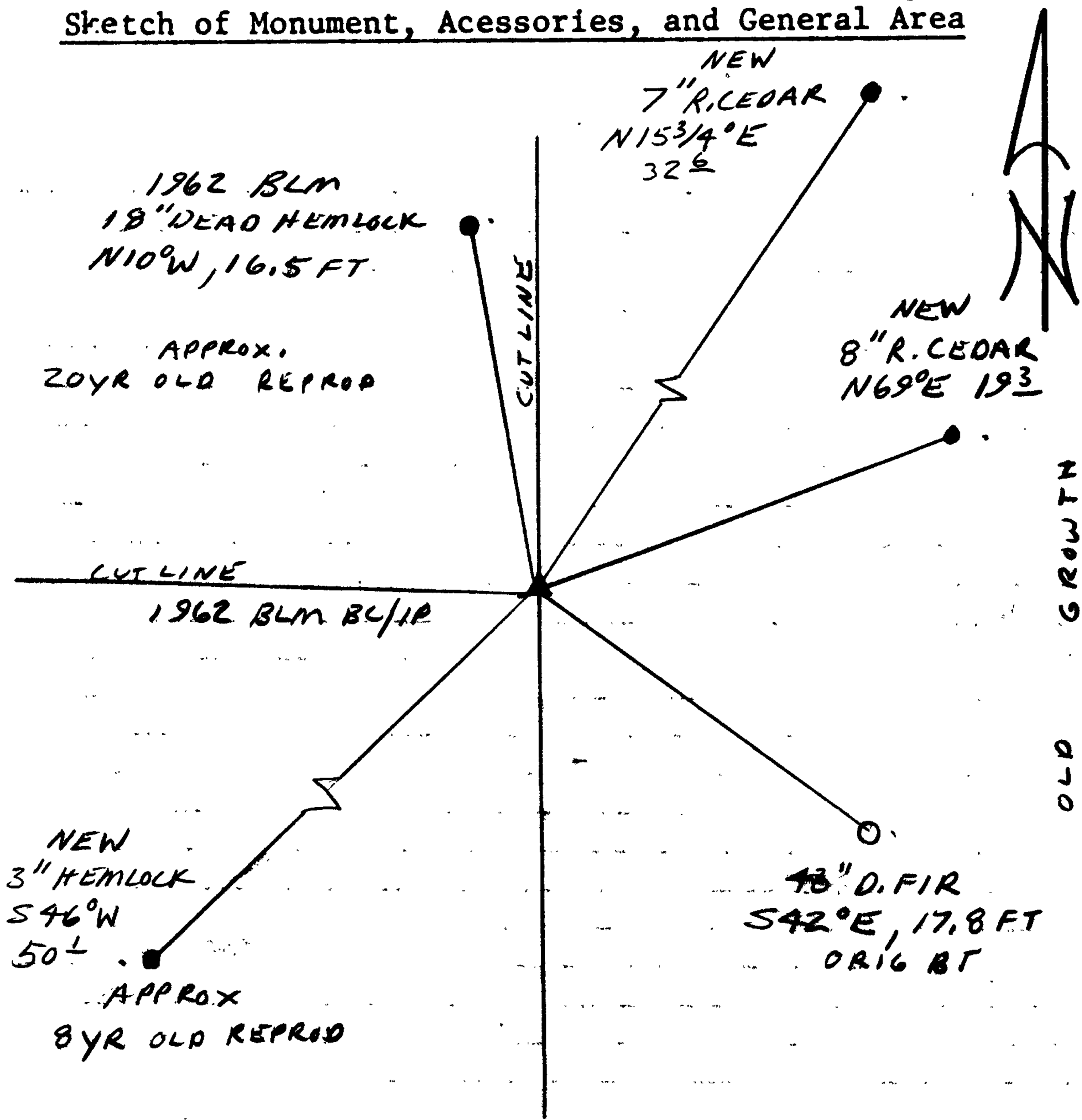

Location & Comments

CORNER LIES ON A STEEP WEST SLOPE APPROX 150 FT EAST OF A NORTHERLY RUNNING CREEK.

Comp. Declin. 18°E
 Agency DCSO
 Party Chief RANDALL W SMITH
 Notekeeper Randall W Smith
 Witnesses STEPHEN J FLAUSE
TERRIE FRANSEN

Address

Surveyor's Seal

REGISTERED
 PROFESSIONAL
 LAND SURVEYOR

Randall W Smith

OREGON
 JULY 25, 1990
 RANDALL W. SMITH
 2469

Rm. 122 - COURT-HOUSE
ROSEBURG, OR 97470

DOUGLAS COUNTY SURVEYOR

PH. 672-3311
EXT. 114

CORNER RENEWAL REQUEST

Section 27 Twp. 25S Rge. 2W

Date 8-3-90

Condition of Corner and Accessories: BC OK is on fire trail

steep side slope.

hemlock BT dead (recently)

45" DF BT in sec. 27 OK but will be cut
if our T.S. is sold. "Pond View Sale"

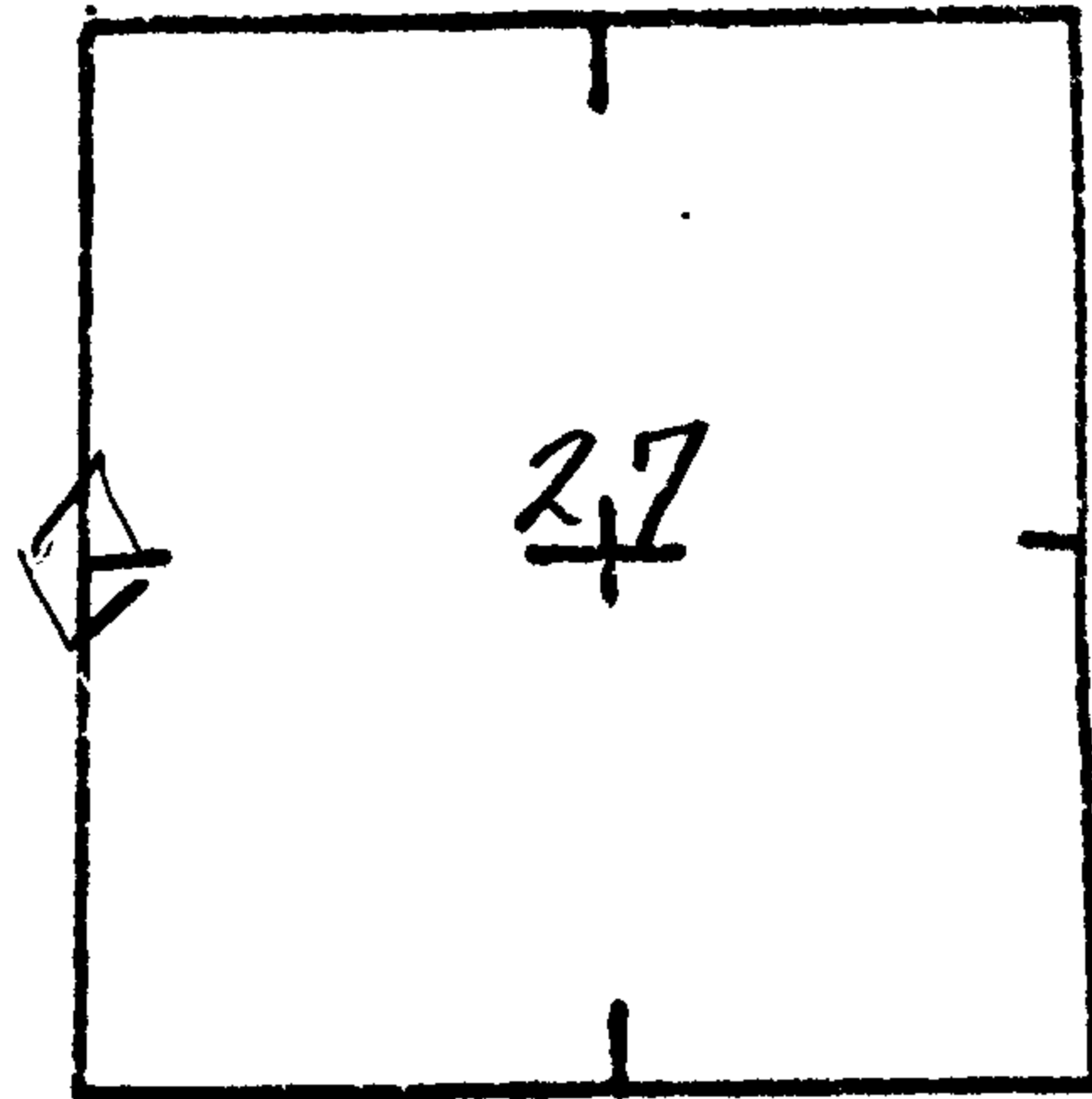

TO REACH: (Please show approximate distances, clearcuts, roads, fences, etc.) About 500 FT NW
of landing @ end of BLM road 25-2-27.3. See map on back
and photo xerox attached.

Notify immediately prior to renewal visit? Yes No

Notify following renewal visit? Yes No

Is corner in immediate danger of being lost or disturbed? Yes No

Name Bill May

Address BLM

Telephone _____

ADDITIONAL COMMENTS _____

1" DOH RFD CERAP

11

3" DOH HEMLOCK SURGER X BT
LEANS S46°W, 50 L FT

