

RENEWAL

Monument Set (Procedure and Description)

NONE

Monument Detail

N/A

New Accessories

7" DIA. PISTOL BUTT D. FIR DOUBLE BLAZED AND SCRIBED "1/4 S26 CS BT"
BEARS N 62°W, 22.2 FT. TO ROOT CROWN.

14" DIA. MAPLE DOUBLE BLAZED AND SCRIBED "1/4 S25 CS BT"
BEARS S 07°E, 3.6 FT.

Sketch of Monument, Accessories, and General Area

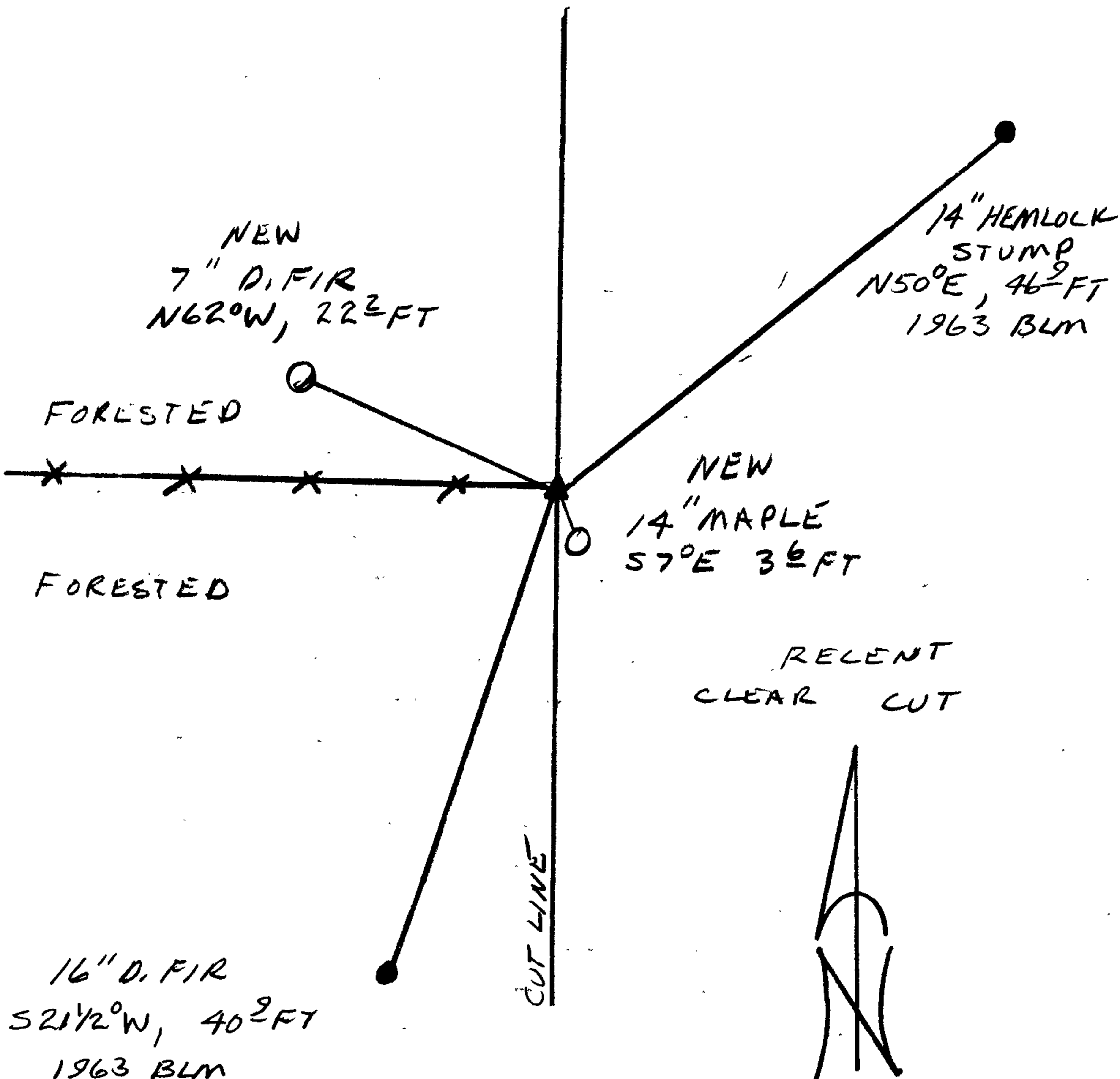

Location & Comments

Comp. Declin. 18°E
 Agency DCSO
 Party Chief RANDALL W SMITH
 Notekeeper Randall W Smith
 Witnesses STEPHEN J FLAUSE

Address

Surveyor's Seal

REGISTERED
 PROFESSIONAL
 LAND SURVEYOR

Randall W Smith

OREGON
 JULY 25, 1990
 RANDALL W. SMITH
 2469

Rm. 122 - COURTHOUSE
ROSEBURG, OR 97470

DOUGLAS COUNTY SURVEYOR

PH. 672-3311
EXT. 114

CORNER RENEWAL REQUEST

Section 25 Twp. 24S Rge. 4W

Date 7-20-90

Condition of Corner and Accessories: Hemlock BT a high stump that
is rotting. I put a new BT tag on it.
DF BT is badly fire scarred but still alive.
The BC is just North of fairly large forked Maple
tree which has fencing on it.
This location was burned by slash fire around 1985?

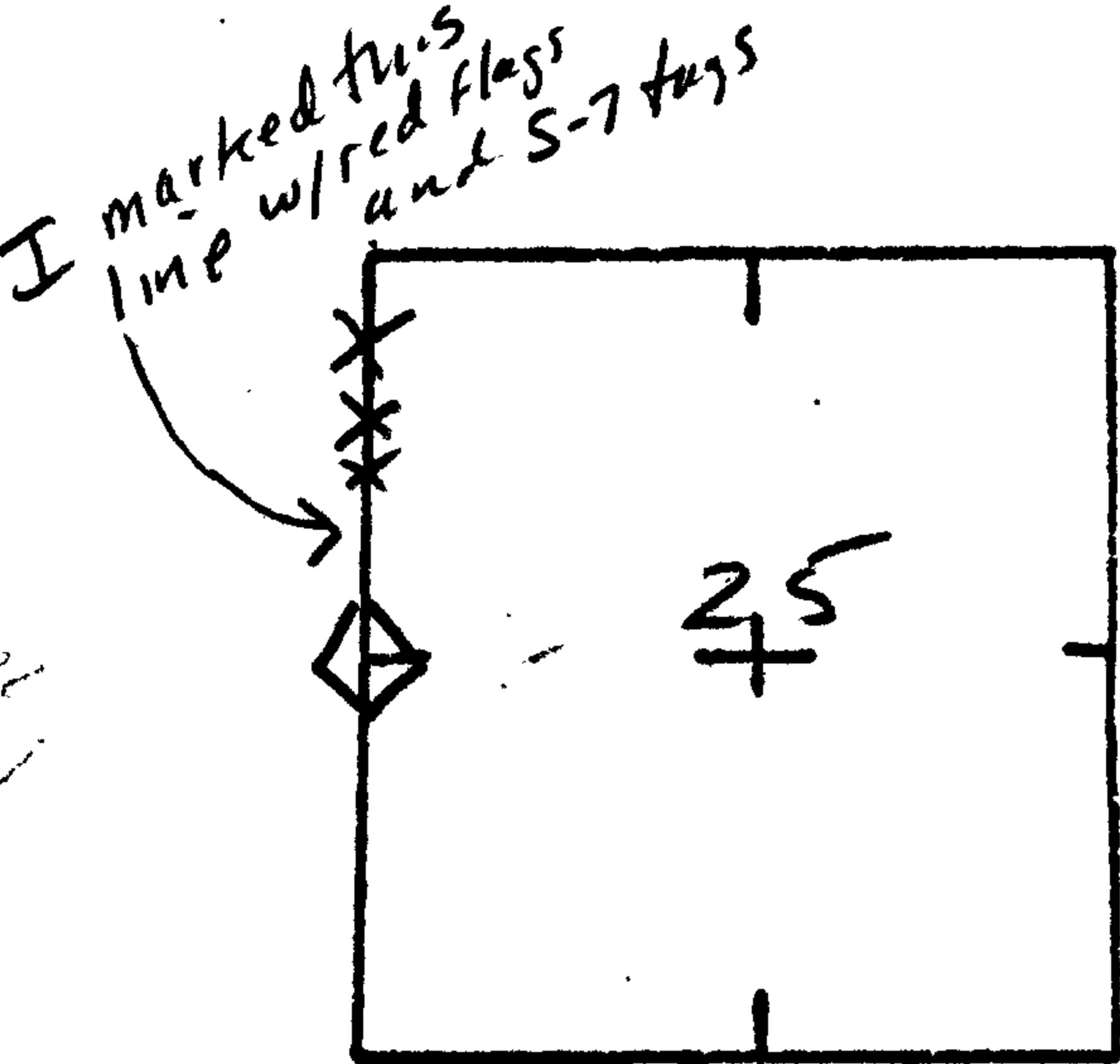

X-X Fence

TO REACH: (Please show approximate distances, clearcuts, roads, fences, etc.) There is no nice
way to get to this corner. See back of sheet.

Notify immediately prior to renewal visit? Yes No
Notify following renewal visit? Yes No
Is corner in immediate danger of being lost or disturbed? Yes No

Name Bill May
Address 777 NW Garden Valley
Roseburg Blm
Telephone 672-4491 #206

ADDITIONAL COMMENTS

Need key to get in gate @ 1000 ft, 11. #712
Please return.

