

GOVERNMENT CORNER RESTORATION FORM

FILED

Township 24S Range 1W Sec. 15 County DOUGLAS

AUG 13 1990

State OREGON Date JULY 22, 1990 No. \_\_\_\_\_

COUNTY SURVEYOR  
DOUGLAS COUNTY, ORE.

Corner Designation

$\frac{1}{4}$   
S16 | S15

- Condition Report Only
- Not Found
- Renewed
- Unrecorded
- Surveyed In
- Referenced Out

Previous Renewals 50

MONUMENT DETAIL

Monument(s) Found: (Condition and Source)

A 3x3x2 FOOT TALL BOULDER, EAST SIDE SPALLED NO MARKS FOUND. A 1 3/8 IN X 36 INCH IRON PIPE WITH A 2 1/2 INCH DIAM. BRASS CAP MARKED AS AT RIGHT IS FOUND LOOSE FROM GROUND AND IN SCATTERED ROCK MOUND ON EAST EDGE OF ABOVE BOULDER.

COUNTY SURVEYORS OFFICE

T24S

$\frac{1}{4}$  S16 | S15

RIW

1966

Accessories Found:

MEAS. TO EAST SIDE OF BOULDER NEAR NORTH END. TWO ORIGINAL BEARING TREES FOUND. A FIR 16 INS. DIAM. NOW A 21 INCH DBH 40 FOOT TALL D. FIR SNAG WITH A PREVIOUSLY OPENED DOUBLE BLAZE WITH THE SCRIBING "1/4 S BT" VISIBLE BEARS S38°E 20° FT. DIST. (RECORD S38°E, 21 1/2 FT DIST. THIS IS A SLOPE DISTANCE). A FIR 24 INS DIAM. NOW A 30 INCH DBH D. FIR WITH A FULLY HEALED DOUBLE BLAZE BEARS N67°W, 5 1/2 FT. DIST (RECORD N67°W, 5 1/2 FT. DIST THIS IS A SLOPE DISTANCE)

FROM RENEWAL # 50 ONE RENEWAL BT IS FOUND. A 14" D. FIR NOW A 14 INCH DBH D. FIR BEARS N 78 1/2° E, 23 1/2 FT DIST. (RECORD N 74 1/2° 26 1/2 FT THIS BEARING IS TO NEAR VERTICAL SECTION OF TRUNK (NOT ROOTCROWN) AND DISTANCE IS A SLOPE DIST.)

#153x

C.S. File No. 64/10-1 C

RENEWAL

Monument Set (Procedure and Description)

Monument Detail

POINT DESCRIBED ABOVE NEAR NORTH END OF BOULDER AND ON MOST EASTERLY SIDE AGREES WELL WITH ORIGINAL BEARINGS AND ALL SLOPE DISTANCES AGREE TO THIS POSITION. THE BRASS CAP MONUMENT IS POSITIONED DIRECTLY ALONG THE EAST EDGE OF BOULDER AND PARTIALLY UNDEROVER HANG OF SAID BOULDER. THE BRASS CAP POSITION IS THE SAME AS THE ABOVE MENTIONED MEASURED TO POSITION ON THE BOULDER. THE MARKS "RESET 1990" ARE ADDED TO THE BRASS CAP AS AT RIGHT. A MOUND OF STONE APPROX. 32 X 14 X 17 INCHES TALL IS PILED ON EAST EDGE OF BC MONUMENT MONUMENT IS FLUSH WITH TOP OF STONE MOUND.

COUNTY SURVEYORS OFFICE

T245

1/4 516 | S15

RIW

RESET 1990

1966

New Accessories

A 4 INCH DBH HEMLOCK SCRIBED "X BT" ON A DOUBLE BLAZE BEARS N42°E, 27 2/3 FEET DISTANT.

A 10 INCH DBH LIMBER PINE SCRIBE "1/4 S16 CS BT" ON A DOUBLE BLAZE BEARS N09°14'W, 35 1/2 FEET DISTANT.

Sketch of Monument, Accessories, and General Area

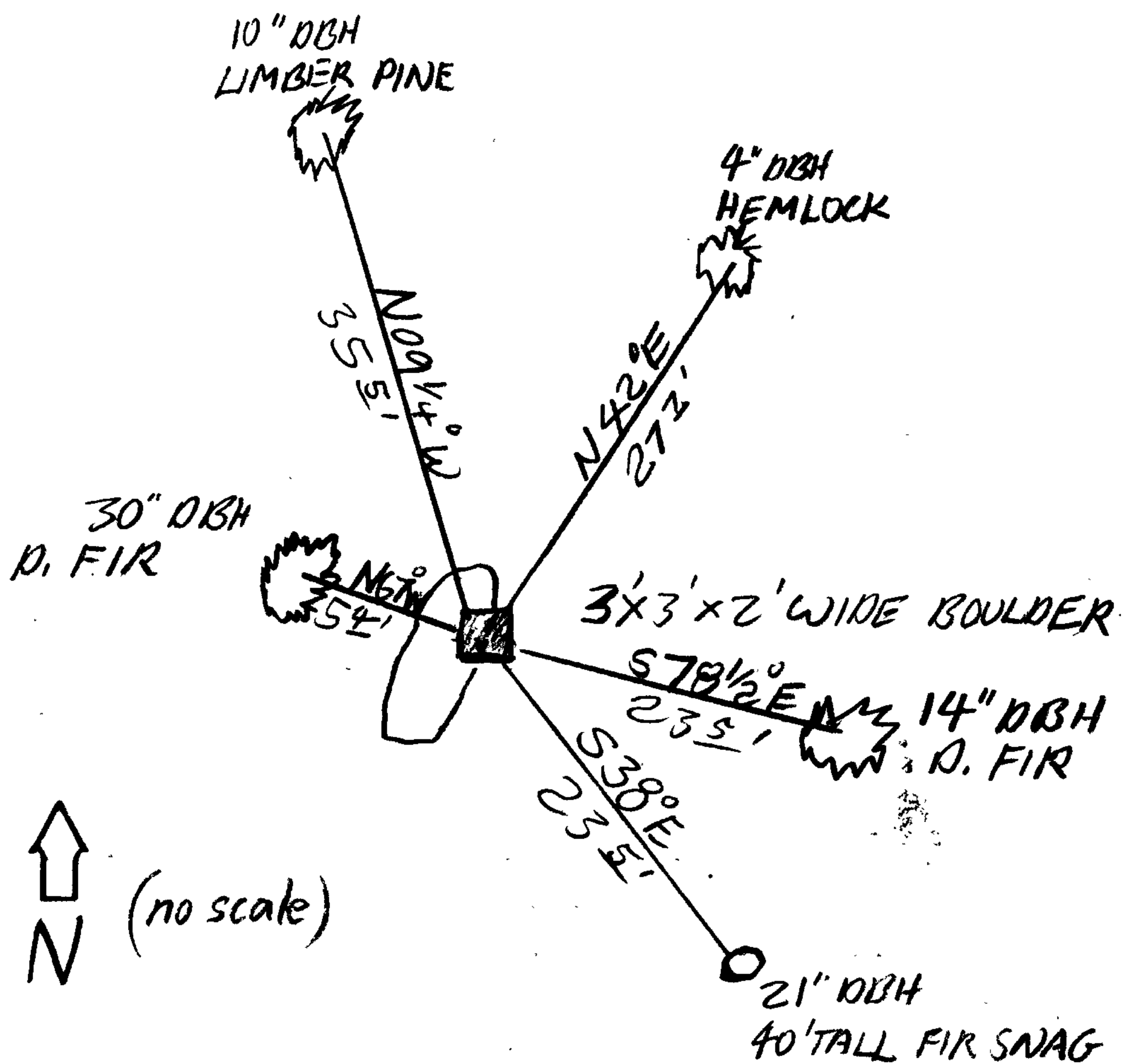

Location & Comments

CORNER LIES ON SLEEP EAST SLOPE APPROX 200 FT SOUTHWESTERLY FROM RIDGE BACK TRAIL RUNNING NORTH EASTERLY

Comp. Declin. 18°E  
 Agency DCSO  
 Party Chief S.J. FLAUSE  
 Notekeeper Stephen John Flause  
 Witnesses TERRIE FRANSEN

Address

Surveyor's Seal

REGISTERED  
 PROFESSIONAL  
 LAND SURVEYOR

*Surveyor's Signature*

OREGON  
 JULY 13, 1979  
 LARRY E. MONREAN  
 #1830