

GOVERNMENT CORNER RESTORATION FORM

FILED

JH

Township 25S Range 5W Sec. 35 County DOUGLAS

JUL 11 1990

State OR Date 6/28/90 No. \_\_\_\_\_

COUNTY SURVEYOR  
DOUGLAS COUNTY, ORE.

Corner Designation

S35 | S36  
S2 | S1

- Condition Report Only
- Not Found
- Renewed
- Unrecorded
- Surveyed In
- Referenced Out

MONUMENT DETAIL

Previous Renewals #72 <sup>T25-5</sup>, 1960 BLM SURVEY #58 T26-5

Monument(s) Found: (Condition and Source)

A 2 1/2" DIA. DCSO BRASS CAP ON A 1 1/4"  
O.D. IRON PIPE, PROTRUDING 17"  
ABOVE GROUND (REN #72).

COUNTY SURVEYOR'S OFFICE  
T25S R5W  
S35 | S36  
S2 | S1  
T26S R5W  
1960

Accessories Found:

24" NOW 54" DIA D.FIR WITH A FULLY HEALED PREVIOUSLY OPENED  
BLAZE BEARS S 42 1/2° E, 4.6 FT (AGREES WITH REC) ORIG. BT

10" NOW 12" DIA. DOWN AND ROTTED MADRONE BEARS N 7 1/2° E, 63.4 FT  
ORIG. BT.

20" NOW 40" DIA 25 FT HIGH MADRONE SNAG WITH A ROTTED CENTER,  
BEARS N 40 1/2° W, 55.5 FT (REC N 40 1/2° W, 58.1 FT) ORIG. BT

18" NOW 27" DIA. D.FIR WITH A FULLY HEALED DOUBLE BLAZE,  
BEARS N 51° E, 12.5 FT (AGREES WITH BLM REC.) REN #72

11" NOW 16" DIA. MAPLE WITH A FULLY HEALED DOUBLE BLAZE,  
BEARS N 37° W, 10.1 FT (AGREES WITH REC) REN #72

10" NOW 12" DIA. DOWN D.FIR WITH A FULLY HEALED DOUBLE  
BLAZE, ROOT HOLE BEARS S 20° W, 58.7 FT (AGREES WITH  
BLM REC). REN #72

#151 T25-5 ✓  
#160 T26-5 ✓

RENEWAL

Monument Set (Procedure and Description)

NONE

Monument Detail

N/A

New Accessories

10" DIA. D. FIR. DOUBLE BLAZED AND SCRIBED "T265 R 5 W S 2 C S B T"  
BEARS S 16 1/2° W, 50.5 FT

Sketch of Monument, Accessories, and General Area

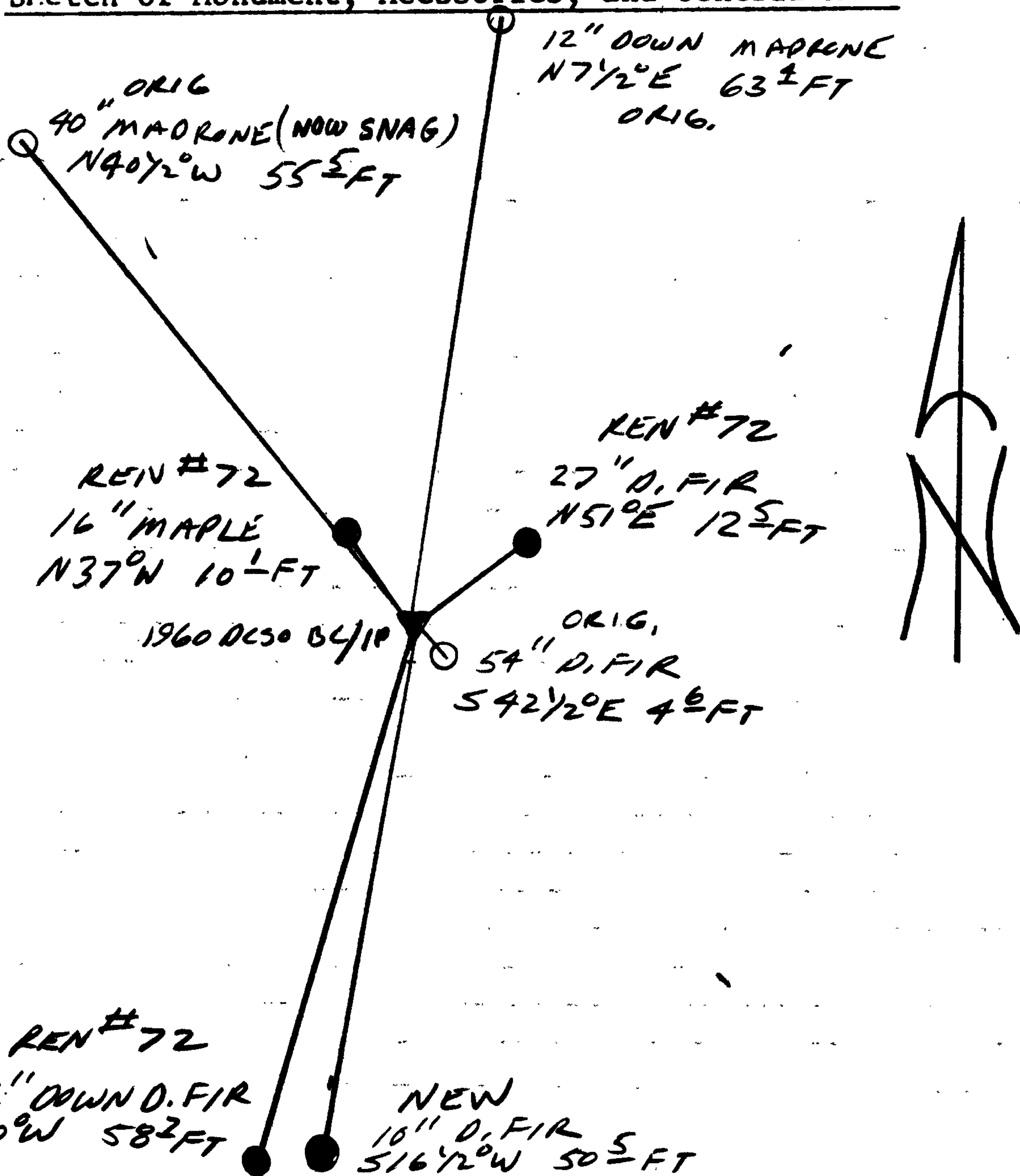

Location & Comments

Comp. Declin. 18° E  
 Agency DCSO  
 Party Chief RANDALL W SMITH  
 Notekeeper Randall W Smith  
 Witnesses TERRIE FRANSSEN

Address

Surveyor's Seal

REGISTERED  
PROFESSIONAL  
LAND SURVEYOR

*Larry E. Monrean*

OREGON  
JULY 13, 1979  
LARRY E. MONREAN  
#1830