

GOVERNMENT CORNER RESTORATION FORM

FILED

JUN 6 1990

Township 24S Range 7W Sec. 22 County DOUGLAS

State OR Date 6/4/90 No. \_\_\_\_\_

COUNTY SURVEYOR  
DOUGLAS COUNTY, ORE.

Corner Designation

1/4 S22 | S23

- Condition Report Only
- Not Found
- Renewed
- Unrecorded
- Surveyed In
- Referenced Out

Previous Renewals 1973 BLM D. RESURVEY

Monument(s) Found: (Condition and Source)

A 3 1/4" DIA BLM BRASS CAP ON A  
2 1/4" O.D. IRON PIPE PROTRUDING  
6" ABOVE GROUND. (1973 BLM)

U.S. DEPT. OF THE INTERIOR

1/4

S22 | S23

T24S R7W

1973

BUR. OF LAND MANAGEMENT

Accessories Found:

16" NOW 20" DIA. D. FIR WITH A FULLY HEALED SINGLE BLAZE  
BEARS N86°E, 13.5 FT (AGREES WITH REC.) 1973 BLM

12" NOW 18" DIA 5 FT HIGH D. FIR STUMP WITH A FULLY HEALED  
SINGLE BLAZE, BEARS N24 1/2°W, 38.9 FT (AGREES WITH REC) 1973 BLM

#160 ✓

RENEWAL

Monument Set (Procedure and Description)

Monument Detail

NONE

N/A

New Accessories

- 6" DIA MADRONE BARK SCRIBED "1/4 S 23 CS BT" BEARS S 11 1/2° E, 33.1 FT.
- 7" DIA D. FIR DOUBLE BLAZED AND SCRIBED "1/4 S 22 CS BT" BEARS N 49 1/2° W, 31.6 FT.
- 8" DIA D. FIR DOUBLE BLAZED AND SCRIBED "1/4 S 22 CS BT" BEARS S 87 1/2° W, 25.2 FT.

Sketch of Monument, Accessories, and General Area

Location & Comments

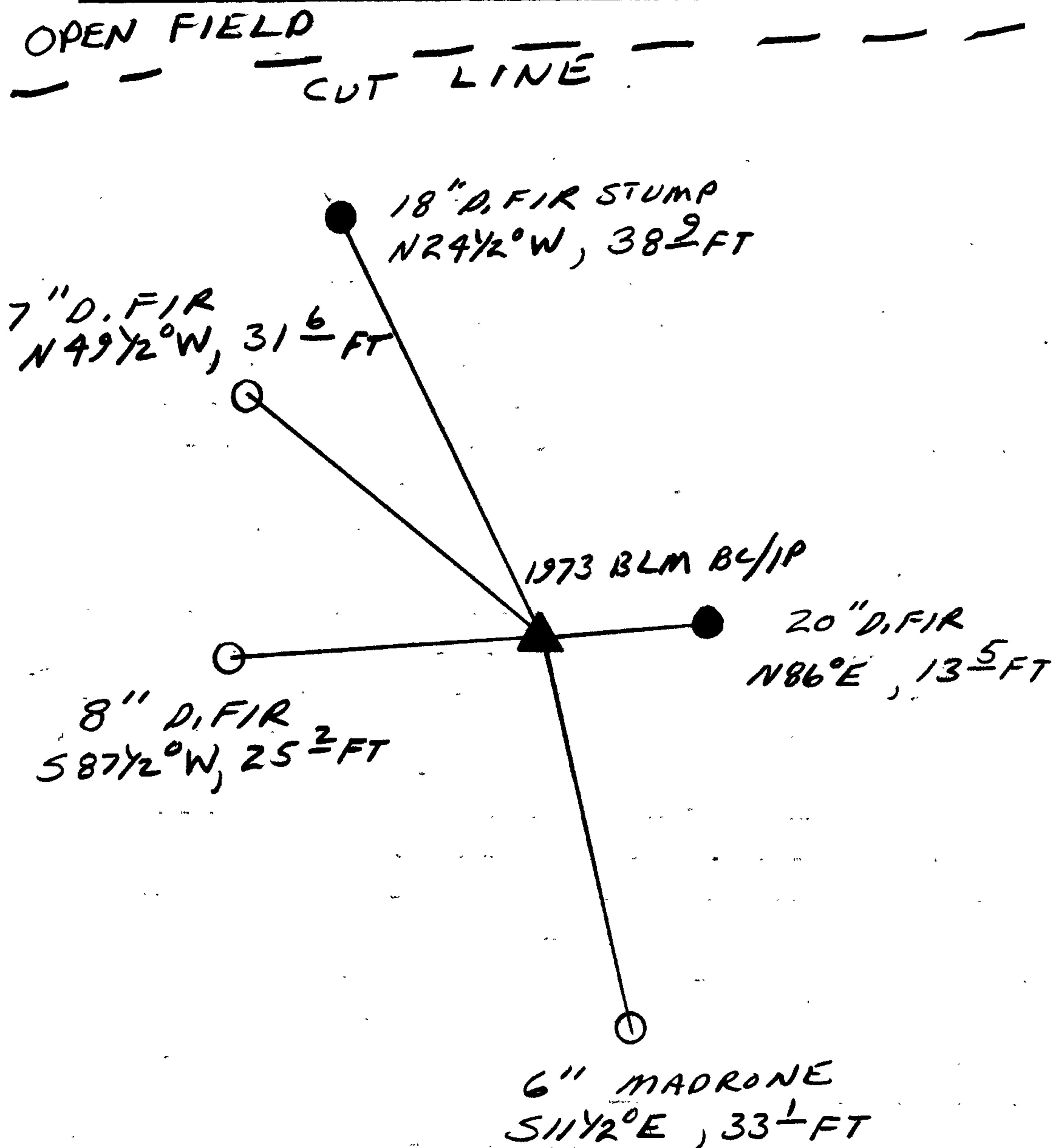

OPEN FIELD  
 --- CUT LINE ---

Comp. Declin. 18° E  
 Agency DLSO  
 Party Chief RANDALL W SMITH  
 Notekeeper Randall W Smith  
 Witnesses STEPHEN J FLAISE

Address \_\_\_\_\_

Surveyor's Seal

REGISTERED  
 PROFESSIONAL  
 LAND SURVEYOR

*Larry E. Monrean*

OREGON  
 JULY 13, 1979  
 LARRY E. MONREAN  
 #1830