

GOVERNMENT CORNER RESTORATION FORM

FILED

JK

Township 27S Range 3W Sec. 10

County DOUGLAS

FEB 26 1990

State OR

Date 2/19/90

No. \_\_\_\_\_

COUNTY SURVEYOR  
DOUGLAS COUNTY, ORE.

Corner Designation \_\_\_\_\_

$\frac{1}{4} \frac{S10}{S15}$

- Condition Report Only
- Not Found
- Renewed
- Unrecorded
- Surveyed In
- Referenced Out

Previous Renewals #40

Monument(s) Found: (Condition and Source)

A 2 1/2" DIA DCSO BRASS CAP ON  
A 1 1/2" O.D. IRON PIPE PROTRUDING  
16" ABOVE GROUND. BC/IP IS FOUND  
LEANING 0.3 FT SOUTH OF PLUMB.

COUNTY SURVEYOR'S OFFICE  
T27S

$\frac{1}{4} \frac{S10}{S15}$   
R3W  
1957

Accessories Found:

12" NOW 24" DOWN AND ROTTED CEDAR SHOWS EVIDENCE  
OF BEING PREVIOUSLY OPENED NO SCRIBING VISIBLE  
ROOTS BEAR S 2° W, 11.5 FT. (ROOT HOLE NOT VISIBLE  
SNOW ON GROUND) (REC. S 20° W, 13.2 FT) ORIG. BT

14" NOW 17" DIA J. CEDAR WITH A FULLY HEALED DOUBLE  
BLAZE BEARS S 13 3/4° E, 45.2 FT (REC. S 12° E, 44.8 FT)  
REN #40

12" NOW 18" DIA 2 FT HIGH CEDAR STUMP, NO BLAZES  
OR SCRIBING VISIBLE BEARS N 60° E, 52.0 FT  
(AGREES WITH RECORD). REN #40

#157

RENEWAL

Monument Set (Procedure and Description)

DCSO BC/1P RETURNED TO PLUMB POSITION.  
A MOUND OF DIRT IS PLACED AROUND  
BC/1P. BRASS CAP NOW PROTRUDES  
6 IN ABOVE MOUND OF DIRT.

Monument Detail

N/A

New Accessories

14" DIA. W. FIR DOUBLE BLAZED AND SCRIBED "1/4 S 10 CS BT"  
BEARS N52°E, 6.6 FT  
6" DIA. D. FIR DOUBLE BLAZED AND SCRIBED "1/4 S 15 CS BT"  
BEARS S53 1/2°E, 9.7 FT  
9" DIA. D. FIR DOUBLE BLAZED AND SCRIBED "1/4 S 10 CS BT"  
BEARS N58°W, 18.0 FT

Sketch of Monument, Accessories, and General Area

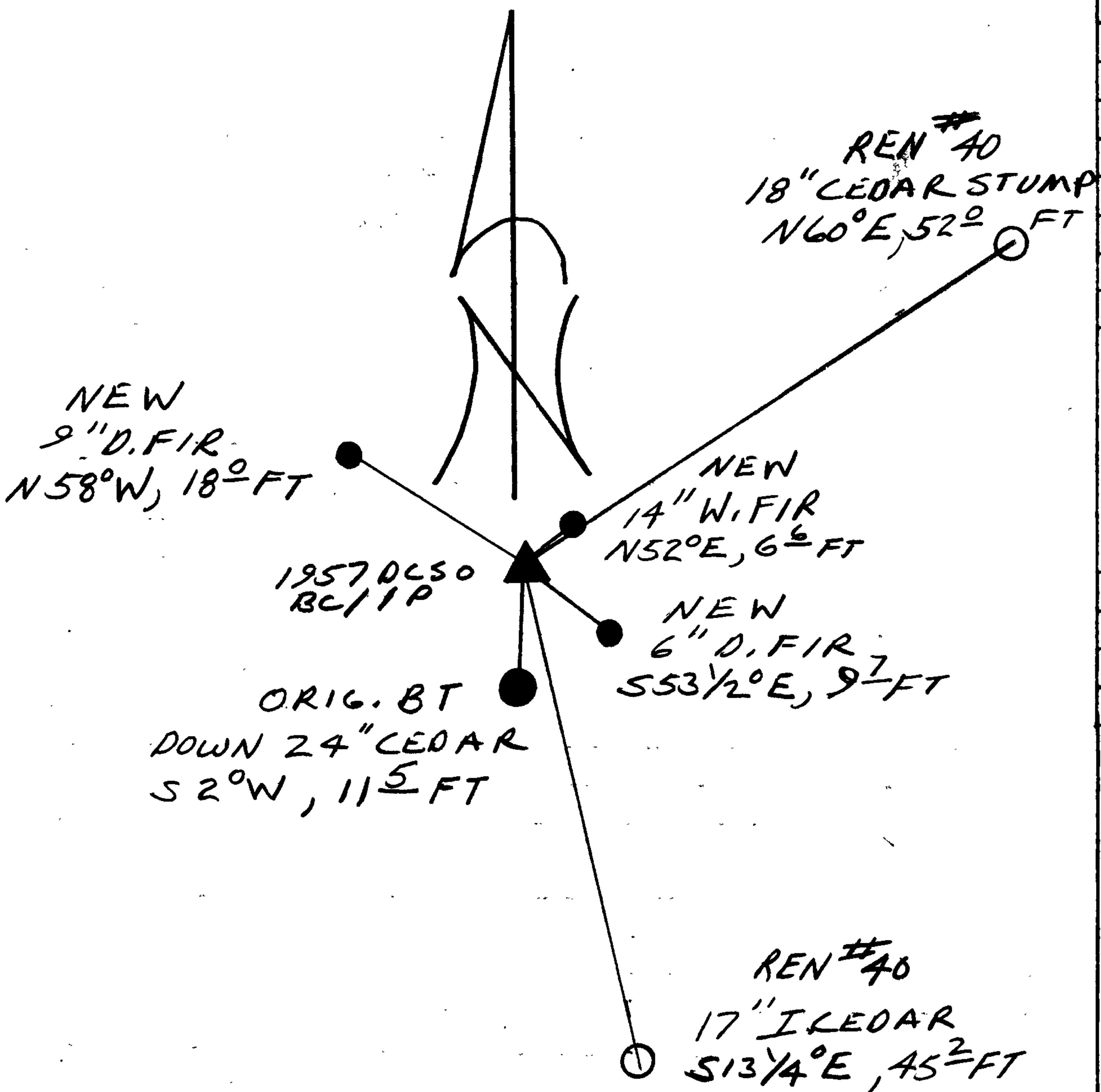

Location & Comments

CORNER LIES APPROX. 125 FT  
NORTH OF A GRAVEL ROAD.

Comp. Declin. 18° E  
Agency DCSO  
Party Chief RANDALL W. SMITH  
Notekeeper Randall W. Smith  
Witnesses STEPHEN J. FLAUSE

Address

Surveyor's Seal  
REGISTERED  
PROFESSIONAL  
LAND SURVEYOR

*Larry E. Monrean*

OREGON  
JULY 13, 1979  
LARRY E. MONREAN  
#1830