

GOVERNMENT CORNER RESTORATION FORM

Township 30 S Range 9 W Sec. 2 County DOUGLAS DEC 18 1989

State OR Date 12/11/89 No. _____ COUNTY SURVEYOR DOUGLAS COUNTY, ORE.

Corner Designation

1/4 S3/S2

- Condition Report Only
- Not Found
- Renewed
- Unrecorded
- Surveyed In
- Referenced Out

Previous Renewals #21, #36, #96, #104, #105

Monument(s) Found: (Condition and Source)

A 1973 DCSO 2 1/2" DIA. BRASS CAP ON A 1 3/8" O.D. IRON PIPE, LEANING 1/2 FT SOUTH OF PLUMB.

COUNTY SURVEYORS OFFICE

T30S R9W

1/4 S3/S2

1973

Accessories Found:

30" NOW 18" DIA. 2 FT HIGH BURNT AND ROTTED D. FIR STUMP, NO BOAT SPIKE SEEN, BEARS N34°W 29.4 FT (AGREES WITH RECORD) REN #96

28" NOW 24" DIA. 5 FT HIGH BURNT AND ROTTED D. FIR STUMP, WITH BOAT SPIKE IN TOP NEAR CENTER, B.S., BEARS N7°E, 31.5 FT (REC. N7°E, 32.0 FT) REN #96

10" NOW 11" DIA. TIPPED OUT TO NORTH DOWN AND BURNT CEDAR, SCRIBING VISIBLE "1/4 S3 BT" BEARS S75°E, 27.0 TO REMAINS OF ROOTS, (AGREES WITH RECORD, FIRST NOTED IN REN #105) SOURCE UNKNOWN

12" NOW 18" DIA. CEDAR WITH A PARTIALLY HEALED SINGLE BLAZE, SCRIBING VISIBLE "1/4 S3 BT", BEARS N89 1/2°W, 124.9 FT (RECORD N88 1/2°W, 122.6 FT) REN #105

NORTH EAST CEDAR BT FROM REN #105 IS GONE

14" NOW BROKEN, SHATTERED, ROTTED REMAINS OF INDETERMINABLE SIZE NEAR RECORD BEARING (N70°E, 21.8 FT) POSSIBLE ORIG. BT.

146 ✓

C.S. File No. 64/3-8

C

RENEWAL

Monument Set (Procedure and Description)

Monument Detail

PLUMBED POSITION OF 1973 DCSO BC/IP IS REFERENCED, IRON PIPE MEASURED 36 IN. LONG. THE STAMPING "RESET 1989" IS ADDED TO BRASS CAP. BC/IP IS RETURNED TO REFERENCED POSITION AND NOW PROTRUDES 6 IN. ABOVE GROUND.

COUNTY SURVEYORS OFFICE
T30S R9W
1/4 S3 | S2
RESET 1989
1973

New Accessories

7" DIA. D. FIR DOUBLE BLAZED AND SCRIBED "1/4 S3 CS BT" BEARS S 7 1/2° W, 35.9 FT.
7" DIA. MADRONE BARK SCRIBED "1/4 S2 CS BT" BEARS S 59 1/2° E, 67.4 FT
4" DIA. D. FIR DOUBLE BLAZED AND SCRIBED "X BT" BEARS NORTH, 43.1 FT.

Sketch of Monument, Accessories, and General Area

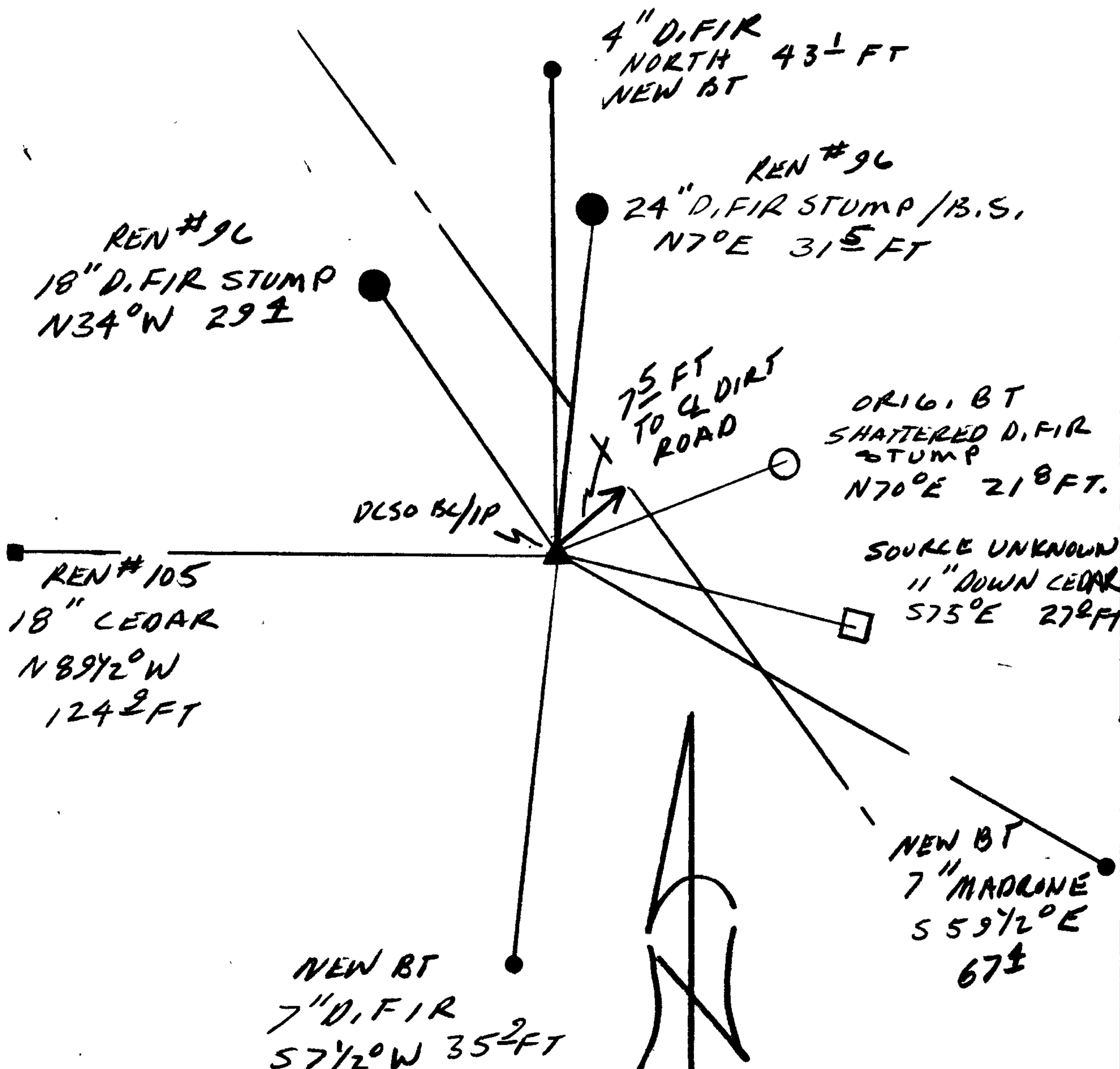

Location & Comments

CORNER LIES ALONG
SOUTHWEST EDGE OF A
DIRT ROAD
Comp. Declin. 18° E
Agency DCSO
Party Chief RANDALL W SMITH
Notekeeper Randall W Smith
Witnesses STEPHEN J. FLAUSE

Address

Surveyor's Seal

REGISTERED
PROFESSIONAL
LAND SURVEYOR

Larry E. Monrean

OREGON
JULY 13, 1979
LARRY E. MONREAN
#1830