

## GOVERNMENT CORNER RESTORATION FORM

FILED

Township 255 Range 7W Sec. 16 County DOUGLASState OR Date 11/17/89 No. \_\_\_\_\_

NOV 27 1989

Corner Designation

 $\frac{1}{4} \frac{516}{521}$ COUNTY SURVEYOR  
DOUGLAS COUNTY, ORE.

Condition Report Only

Not Found

 Renewed

Unrecorded

Surveyed In

Referenced Out

MONUMENT DETAIL

Previous Renewals 1968 BLM D. RESURVEY

Monument(s) Found: (Condition and Source)

A 3 1/2" DIA. BLM BRASS CAP ON A  
2 1/2" O.D. IRON PIPE PROTRUDING 8 IN.  
ABOVE GROUND (FROM 1968 BLM D. RESURVEY)U.S. DEPT OF THE INTERIOR  
7255 RTW $\frac{1}{4} \frac{516}{521}$ 

1968

BUR OF LAND MANAGEMENT

Accessories Found:

12" NOW 24" DIA. W. OAK, ILLEGIBLE REVERSE SCRIBE MARKS  
SEEN FROM A PREVIOUSLY OPENED UNHEALED BLAZE. BEARS  
N 45° E, 12.5 FT (AGREES WITH RECORD) ORIG. BT18" OAK NOW A ROOT HOLE. AN APPROX. 30" DIA. ROTTED, UPROOTED  
AND DOWN OAK, NO BLAZES OR SCRIBING SEEN (DID NOT OPEN),  
FOUND APPROX. 10 FT DOWN HILL OF ROOT HOLE. ROOT HOLE  
BEARS S 48° E, 65.3 FT (AGREES WITH RECORD) ORIG. BT12" NOW 17" DIA. 1 FT HIGH D. FIR STUMP WITH AN  
ILLEGIBLE SCRIBE MARK FD BEARS N 75° W 17.4 FT  
(REC. N 75° W 18.2 FT), FROM 1968 BLM D. RESURVEY12" NOW 12" DIA. W. OAK WITH A FULLY HEALED SINGLE  
BLAZE, BEARS S 73 1/2° E, 27.3 FT (REC. S 24 3/4° E, 28.0 FT)  
FROM 1968 BLM D. RESURVEY

#139x

MAP FILE C.S. 64/3-3

RENEWAL

Monument Set (Procedure and Description)

Monument Detail

N/A

N/A

New Accessories

8" DIA PISTOL-BUTT D.FIR DOUBLE BLAZED AND SCRIBED "Y4 S21 CS BT"  
BEARS S49 1/2° E 12.3 FT.

12" DIA, W. OAK DOUBLE BLAZED AND SCRIBED "Y4 S16 CS BT"  
BEARS N 32 1/2° W, 22.2 FT.

Sketch of Monument, Accessories, and General Area

Location & Comments

CORNER LIES ON A STEEP  
SOUTH WEST SLOPE

Comp. Declin. 18° E  
Agency DLSO  
Party Chief RANDALL W SMITH  
Notekeeper Randall W Smith  
Witnesses STEPHEN J FLAUSE

Address

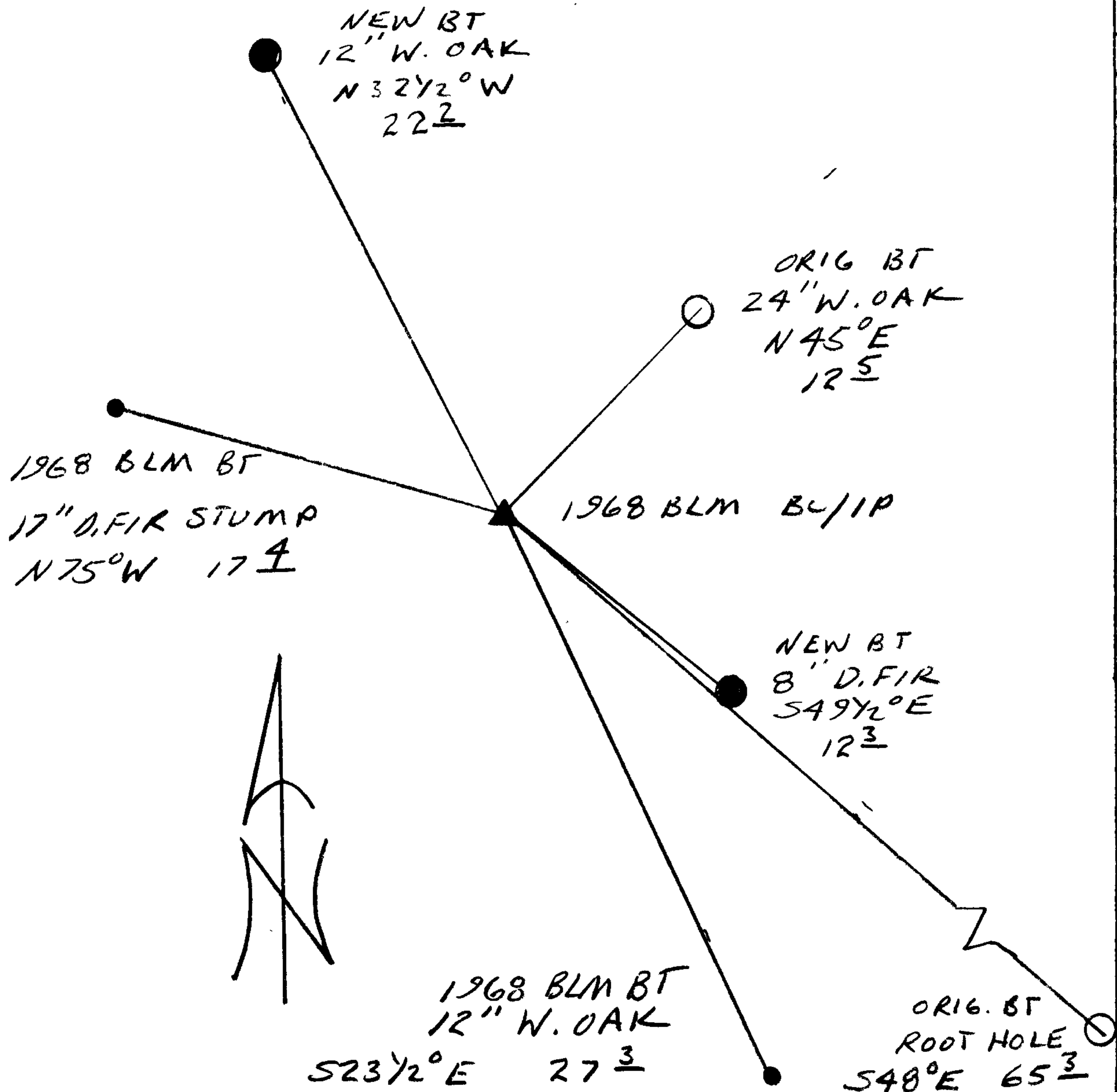

Surveyor's Seal  
REGISTERED  
PROFESSIONAL  
LAND SURVEYOR

*Larry E. Monrean*

OREGON  
JULY 13, 1979  
LARRY E. MONREAN  
#1836