

GOVERNMENT CORNER RESTORATION FORM

Township 30 S Range 3 W Sec. 7 County DOUGLAS
State OR Date 8/9/89 No. _____

Corner Designation

$\frac{1}{4}$ $\frac{S 7}{S 18}$

- _____ Condition Report Only
- _____ Not Found
- Renewed
- _____ Unrecorded
- _____ Surveyed In
- _____ Referenced Out

Previous Renewals #66, 1965 BLM SURVEY, REN #221

Monument(s) Found: (Condition and Source)

3/4" DIA. BLM BRASS CAP (MARKED AS AT RIGHT) ON A 2" DIA. IRON PIPE PROTRUDING 2" ABOVE GROUND. (FROM 1965 BLM RESURVEY)

5/8" I.P., 1" I.P. AND ORIG. STONE SET BELOW GROUND IN RENEWAL #221 NOT LOOKED FOR.

U.S. DEPT. OF THE INTERIOR
T 30 S R 3 W
 $\frac{1}{4}$ $\frac{S 7}{S 18}$
1965

MONUMENT DETAIL

BUR. OF LAND MANAGEMENT

Accessories Found:

- 7" NOW 8" DIA. D. FIR SNAG WITH A PREVIOUSLY OPENED BLAZE, SCRIBING VISIBLE "1/4 S" BEARS N41 1/2° E, 9.9 FT (AGREES WITH REN #221) ORIG. BT
- 30" NOW 46" DIA. 5 FT HIGH D. FIR STUMP WITH FULLY HEALED DOUBLE BLAZE BEARS S75° E 22.2 FT (AGREES WITH REN #221) PK NAIL SET AT WEST BASE BEARS S76° E, 19.3 FT (RECORD S76° E, 19.8 FT PER REN #221) ORIG. BT
- 12" NOW 15" DIA. D. FIR WITH FULLY HEALED DOUBLE BLAZE BEARS N38 1/2° W, 22.6 FT (REC. N38 1/2° W, 23.8 FT IN REN #221) PK NAIL SET AT SOUTHEAST BASE BEARS N40° W, 22.5 FT (AGREES WITH RECORD, FROM REN #221) BT FROM REN #66
- 24" NOW 30" DIA. 3 FT HIGH D. FIR STUMP WITH PK NAIL AT SOUTHEAST BASE, PK BEARS N22 1/2° E, 40.1 FT (AGREES WITH RECORD PER REN #221)
- 48" NOW 49" DIA. D. FIR WITH LARGE OPENING ON EAST TRUNK, PK NAIL SET AT SOUTHEAST BASE, PK BEARS S71 1/2° W, 49.2 FT (AGREES WITH RECORD PER REN #221).

#2394

C.S. File No. 64/1-15 C

RENEWAL

Monument Set (Procedure and Description)

Monument Detail

NONE

N/A

New Accessories

30" DIA. 2 1/2 FT HIGH D. FIR STUMP WITH BOAT SPIKE DRIVEN IN TOP NEAR CENTER OF STUMP, STAMPED "B01", BS BEARS N19 1/4° E, 40.4 FT (A PK NAIL RENEWAL TREE FROM REN #221)

4" DIA MADRONE WITH PREVIOUS BARK SCRIBING "JBSS" WE DOUBLE BLAZE AND SCRIBE "X BT" BEARS S67 3/4° W, 5.4 FT.

Sketch of Monument, Accessories, and General Area

Location & Comments

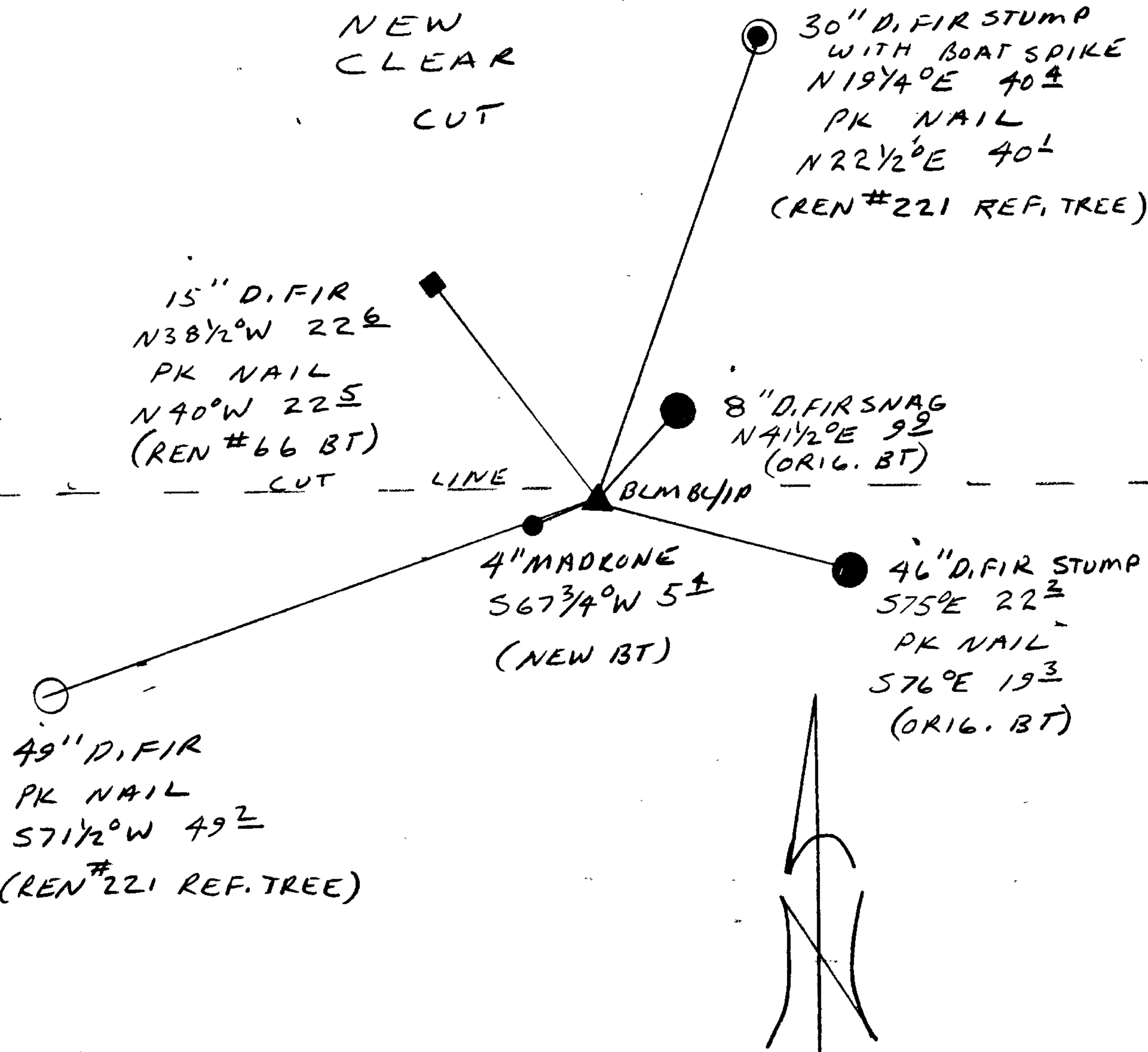

CORNER LIES ON A STEEP WEST SLOPE APPROX 75 FT WEST OF A NORTH-SOUTH RIDGE TOP ROAD, AT THE SOUTH EDGE OF A RECENT CLEAR CUT.

Comp. Declin. 18° E
 Agency DCSO
 Party Chief RANDALL W SMITH
 Notekeeper Randall W Smith
 Witnesses STEPHEN J FLAUSK

Address

Surveyor's Seal

REGISTERED
 PROFESSIONAL
 LAND SURVEYOR

Larry E. Monrean

OREGON
 JULY 13, 1979
 LARRY E. MONREAN
 #1830

T 30 S R 3 W

DATE: MARCH 5, 1981

$\frac{1}{4} \frac{57}{518}$

- Condition Report Only
- Not Found
- Renewed
- Unrecorded
- Surveyed In
- Referenced Out

11
 A - DE 6/2
 10/86 RWL

Previous Renewal #'s 66 & 1965 RESURVEY

Monument(s) Found: (Condition and Source) FOUND ORIGINAL 8x11x4

(REC. 14x12x4) STONE MARKED " $\frac{1}{4}$ " LAYING ON TOP OF GROUND ALONG
 BRASS CAP
 NORTHERLY SIDE OF IRON PIPE MON DESCRIBED BELOW. FD 1" IRON PIPE PER REN. NO.
 66 ALONG NORTHERLY EDGE OF IRON PIPE MON DESC BELOW.
 ALSO FOUND BLM BRASS CAP MARKED " $\frac{1}{4} \frac{57}{518} 1965$ "

Accessories Found: (Condition and Source) ORIGINAL 7" NOW AN 8" ^{FIR} SNAG

PREVIOUSLY OPENED
 SCABBED " $\frac{1}{4}$ S" ON UNHEALED BLAZE BEARS N41 $\frac{1}{2}$ ° E 9 $\frac{3}{4}$ FT (REC. N36 $\frac{1}{2}$ °
 9 $\frac{3}{4}$ FT) ORIGINAL 30" NOW A 16" DIA. FIR WITH HEALED BLAZE
 BEARS N57 $\frac{1}{2}$ ° E 22 $\frac{3}{4}$ FEET (REC 23 $\frac{1}{2}$ FEET) TREE PER REN #66
 A FIR 12 NOW 14 INCH DIAM. BEARS N38 $\frac{1}{2}$ ° W 23 $\frac{3}{4}$ FEET
 (REC N41 $\frac{1}{2}$ ° W OK AT TOP OF BLAZE) BLAZE IS WELL HEALED.

✓ #22/14

~~C. & P. No. 57/30~~

Now
CS 64/1

THIS AREA SOON TO BE LOGGED WE REFERENCE AS FOLLOWS

WE REFERENCE POSITION OF B.L.M. CAP AND DIG UP CAP.

WE SET AT 1/4 COR POSITION A 5/8" BY 30" IRON ROD

18 INCHES BELOW SURFACE, WE SET 1" X 18" IRON PIPE (FROM

RENEWAL # 66) 12" BELOW SURFACE DIRECTLY OVER IRON ROD

SET ORIGINAL STONE ALONG NORTH EDGE OF IRON PIPE 12
INCHES BELOW SURFACE.

RENEWAL

Monument Set: (Procedure and Description) RESET BLM BRASS

CAP AT REFERENCED POSITION WITH CAP 2 INCHES ABOVE

SURFACE

New Accessories: (Description) SET 4 PK NAILS IN NOTCHED ROOTS AS FOLLOWS

A 48" DIA FIR, PK BEARS S 71 1/2° W 49² FT (TREE HAS LARGE OPENING IN EAST FACE)

A 14" DIA FIR (BT FOUND NO. 3) PK BEARS N 40° W 22⁵ FT.

A 24" DIA FIR PK BEARS N 22 1/2° E 40¹ FT.

A 46" DIA (BT FOUND NO. 2) PK BEARS S 76° E 19⁸ FT.

Location and Comments: 19° E Compass Declination

DOUGLAS CO. SURV. OFF

Agency

LARRY E. MONREAN

Party Chief

Jerry S. Mann

Notekeeper

G. E. QUIDELL

Witnesses

D. L. STEWART



Now
C 564/11

DATE: MARCH 5, 1981

T 30 S R 3 W

$\frac{1}{4} \frac{57}{518}$

Condition Report Only
 Not Found
 Renewed
 Unrecorded
 Surveyed In
 Referenced Out

Previous Renewal #'s 66 & 1965 RESURVEY

Monument(s) Found: (Condition and Source) FOUND ORIGINAL 8 X 11 X 4

(REC. 14 X 12 X 4) STONE MARKED " $\frac{1}{4}$ " LAYING ON TOP OF GROUND ALONG
 BRASS CAP
 NORTHERLY SIDE OF IRON PIPE MON. DESCRIBED BELOW. FD 1" IRON PIPE PER REN. NO.
 66 ALONG NORTHERLY EDGE OF IRON PIPE MON. DESC. BELOW.

ALSO FOUND B L M BRASS CAP MARKED " $\frac{1}{4} \frac{57}{518} 1965$ "

Accessories Found: (Condition and Source) ORIGINAL 7" NOW AN 8" ^{FIR} SNAG

SCABBED " $\frac{1}{4}$ S" ON ^{PREVIOUSLY OPENED} UNHEALED BLAZE BEARS N 41 1/2° E 9² FT (REC. N 36 1/2°
 9² FT). 2) ORIGINAL 30" NOW A 46" DIA. FIR WITH HEALED BLAZE
 BEARS N 57 1/2° E 22² FEET (REC 23¹ FEET) 3) TREE PER REN # 66
 A FIR 12 NOW 14 INCH DIAM. BEARS N 38 1/2° W 23⁸ FEET
 (REC. N 41 1/2° W OK AT TOP OF BLAZE) BLAZE IS WELL HEALED.

✓ #2214

NOW C.S. 64/1
C.S. No. 59/30

THIS AREA SOON TO BE LOGGED WE REFERENCE AS FOLLOWS:

WE REFERENCE POSITION OF B.L.M CAP AND DIG UP CAP.

WE SET AT 1/4 COR POSITION A 5/8" BY 30" IRON ROD

18 INCHES BELOW SURFACE, WE SET 1" X 18" IRON PIPE (FROM

RENEWAL # 66) 12" BELOW SURFACE DIRECTLY OVER IRON ROD.

SET ORIGINAL STONE ALONG NORTH EDGE OF IRON PIPE 12 INCHES BELOW SURFACE.

RENEWAL

Monument Set: (Procedure and Description) RESET BLM BRASS

CAP AT REFERENCED POSITION WITH CAP 2 INCHES ABOVE

SURFACE

New Accessories: (Description) SET 4 PK NAILS IN NOTCHED ROOTS AS FOLLOWS

A 48" DIA FIR, PK BEARS S 71 1/2° W 49² FT (TREE HAS LARGE OPENING IN EAST FACE)

A 14" DIA FIR (BT FOUND NO. 3) PK BEARS N 40° W 22⁵ FT.

A 24" DIA FIR PK BEARS N 22 1/2° E 40¹ FT.

A 46" DIA (BT FOUND NO. 2) PK BEARS S 76° E 19⁸ FT.

Location and Comments:

19° E

Compass Declination

DOUGLAS Co. SURV. OFF

Agency

LARRY E. MONREAN

Party Chief

Jerry E. Mann

Notekeeper

G. E. QUIBEI

Witnesses

D. L. STEWART