

*V.R.J.*

TRAVERSE

PROJECT TITLE T28S R71/28&8W  
DATE 8-8-89

BEARING	DISTANCE	LATITUDE	DEPARTURE	NORTH	EAST	STATION
N 88 * 30 ' 0.0 " E	494.740	12.950	494.570	1000.000 1012.950	1000.000 1494.570	NEDLC37 INTRNGLN
N 2 * 57 ' 6.0 " E	31.980	31.937	1.646	1044.888	1496.217	AP2 TR61

BEARING	DISTANCE	LATITUDE	DEPARTURE	NORTH	EAST	STATION
N 37 * 10 ' 24.0 " E	101.370	80.772	61.250	1012.950 1093.723	1494.570 1555.821	INTRNGLN B01

BEARING	DISTANCE	LATITUDE	DEPARTURE	NORTH	EAST	STATION
S 53 * 5 ' 34.0 " E	96.770	- 58.112	77.378	1012.950 954.838	1494.570 1571.948	INTRNGLN B02

C.S. File No. 641-14

BEARING	DISTANCE	LATITUDE	DEPARTURE	NORTH	EAST	STATION
N 50 * 40 ' 16.4 " E	77.055	48.835	59.603	1044.888	1496.217	AP2 TR61
				1093.723	1555.821	B01

BEARING	DISTANCE	LATITUDE	DEPARTURE	NORTH	EAST	STATION
S 40 * 3 ' 48.9 " E	117.661	- 90.049	75.731	1044.888	1496.217	AP2 TR61
				954.838	1571.948	B02

BEARING	DISTANCE	LATITUDE	DEPARTURE	NORTH	EAST	STATION
S 84 * 49 ' 51.7 " W	498.243	- 44.888	- 496.217	1044.888	1496.217	AP2 TR61
				1000.000	1000.000	NEDLC37

BEARING	DISTANCE	LATITUDE	DEPARTURE	NORTH	EAST	STATION
N 80 * 25 ' 43.3 " E	563.667	93.723	555.821	1000.000	1000.000	NEDLC37
				1093.723	1555.821	B01

BEARING	DISTANCE	LATITUDE	DEPARTURE	NORTH	EAST	STATION
S 85 * 29 ' 6.8 " E	573.728	- 45.161	571.948	1000.000	1000.000	NEDLC37
				954.838	1571.948	B02

NE DLC 37 NE DLC 37

S ~~A~~ 88° 30' 00" W

494.74 FT

INT. RNG. LN'S INTRNGLN

94° 27' 06" RT

N 2° 57' 06" E

31.98 FT

APZ TR 61

NE DLC 37

S ~~A~~ 88° 30' 00" W

INT. RNG. LN'S.

128° 40' 24" RT

N 37° 10' 24" E

101.37 FT

B01

NE DLC 37

S ~~A~~ 88° 30' 00" W

INT. RNG. LN'S

218° 24' 26" RT

S 53° 05' 34" E

96.77 FT

B02

INVERSE

APZ TR 61

B01, B02,

NE DLC 37

NE DLS 37

B01, B02

NE DLC 37

COMPASS 13R63

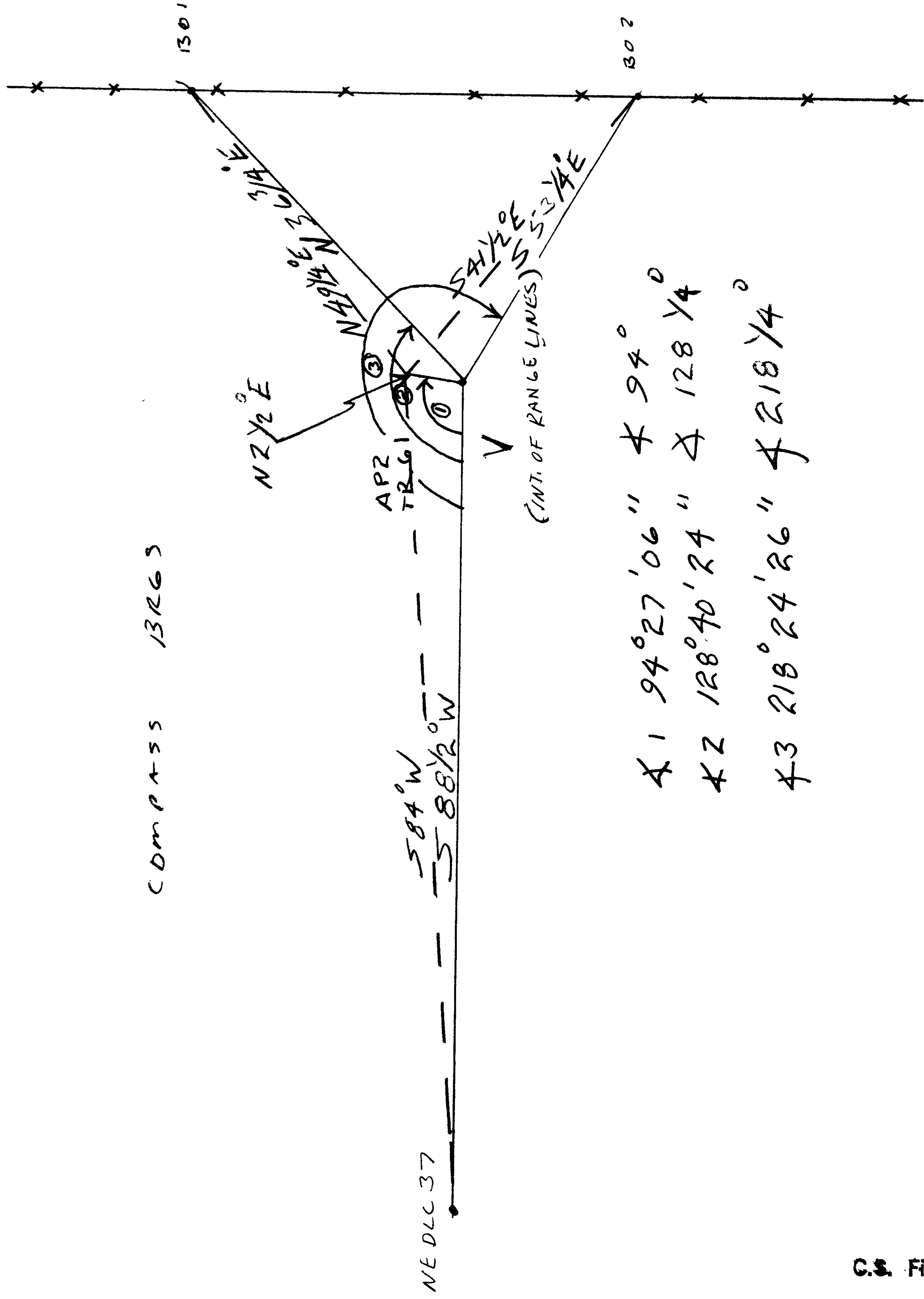

C.S. File No. 64/1