

FILED

Date: 5-23-95 By: JP

This survey consists of:

Map: \_\_\_\_\_

Narrative: \_\_\_\_\_

Corner Rpt: C.S. 63/161-25

OREGON CORNER RESTORATION FORM

Section 22 Township 30S Range 6W

County DOUGLAS Date 5-4-95

DOUGLAS COUNTY  
SURVEYOR

Corner Designation

$\frac{1}{4}$  ———  $\frac{15}{22}$

- Condition Report Only
- Not Found
- Renewed
- Unrecorded
- Surveyed In
- Referenced Out

Previous Renewals/Surveys, etc.

P.L.S.S. 440400

Monument(s) & Accessories Found: (Condition and Source)

- ✓ 1963 DCSO IPBC GOOD 8" ABOVE GROUND
- ✓ 26" OAK NSG 1/2 W 47 LBS GOOD HEALED FACE
- ✓ 24" OAK N75W 14 1/2 FT POOR FACE CHOPPED OUT
- ✓ 24" OAK S9E 32 1/2 FT GOOD HEALED FACE
- ✓ 28" OAK S80W 33 LBS GOOD FACE CHOPPED OUT

Monument Detail

Sketch

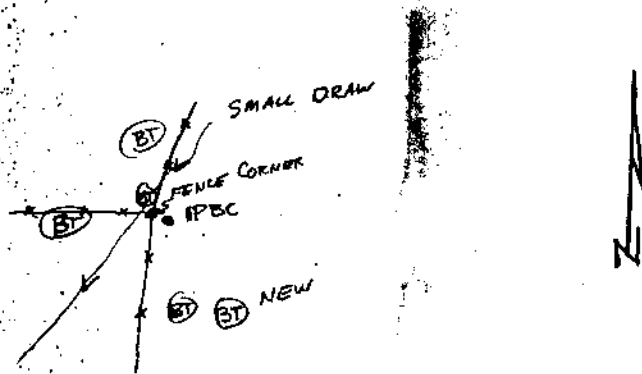

Monument Set (Procedures and Description)

\_\_\_\_\_  
 \_\_\_\_\_  
 \_\_\_\_\_

New Accessories

14" OAK S28E 40 1/2 FT SCRIBED " 1/4 S BT "

Location & Comments

Compass Declination 20°  
 Firm/Agency ROSEBURG FOREST PRODUCTS  
 Address P.O. Box 1088  
ROSEBURG OR 97470  
 Party Chief OLSON  
 Notes McMANIS  
 Witness \_\_\_\_\_

Surveyor's Seal

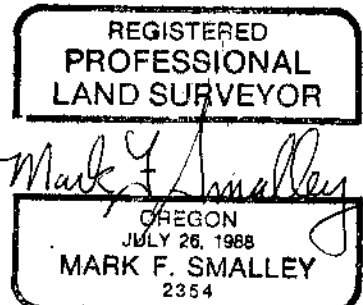

C.S. File No. 63/161-25

EXP 6-30-96