

M 121-69

FILED

Date: 4/24/95 By: JP

This survey consists of:

Map: M 121-69

Narrative: _____

Corner Rpt: (3) C.S. 63/161

OREGON CORNER RESTORATION FORM

Section 34 Township 23S Range 4W

County DOUGLAS Date 3/31/95

Corner Designation

CW 1/16 S 34

DOUGLAS COUNTY SURVEYOR

- Condition Report Only
- Not Found
- Renewed
- Unrecorded*
- Surveyed In
- Referenced Out

Previous Renewals/Surveys, etc. _____

NONE

Monument(s) & Accessories Found: (Condition and Source)

NONE

Monument Detail

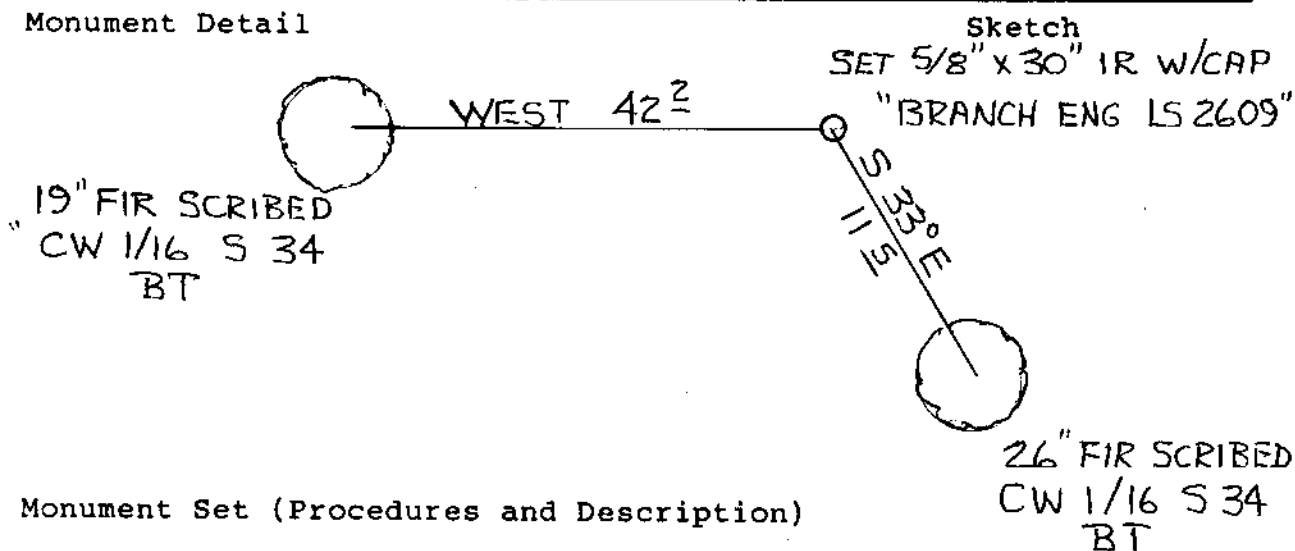

Monument Set (Procedures and Description)

SET 5/8" x 30" IR WITH YELLOW PLASTIC CAP "BRANCH ENG LS 2609" BY SURVEY. SEE RECORD OF SURVEY FILED SEPARATELY.

New Accessories

A 19" FIR BEARS WEST 42 1/2 FT SCRIBED "CW 1/16 S 34 BT"

A 26" FIR BEARS S 33 degrees E 11 5/8 FT SCRIBED "CW 1/16 S 34 BT"

Location & Comments

Surveyor's Seal

Compass Declination _____

Firm/Agency _____

BRANCH ENGINEERING

Address 310 N. 5TH ST.

SPRINGFIELD, OR

Party Chief T. MONTGOMERY

Notes _____

Witness G. CARTIER, LS 2658

REGISTERED PROFESSIONAL LAND SURVEYOR

OREGON JULY 20, 1993 DAVID L. BROWN 2609

EXPIRES 12/31/95