

CLYDE F. MULKINS

FILED

TIMBER CRUISING AND ENGINEERING
P.O. BOX 750 ■ COOS BAY, OR 97420 ■ (503)267-4304

Date: 2-22-95 By: BC
This survey consists of:
Map: _____
Narrative: _____
Corner Rpt: 63/161

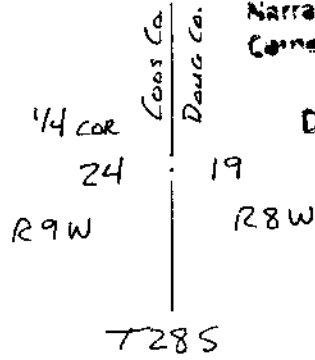

DOUGLAS COUNTY
SURVEYOR

CORNER REMONUMENTATION

1/4 CORNER SECTION 24, T.28S., R.9W., W.M., COOS CO.
& SECTION 19, T.28S., R.8W., W.M., DOUGLAS CO.

HISTORY:

THIS CORNER WAS RE-ESTABLISHED BY JOHN L. SAFSTROM, LS 477 IN 1961 BY SINGLE PROPORTION MEASUREMENT, COOS COUNTY SURVEYOR'S FILE PER BOOK 10, PAGES 59 AND 60.

FOUND MONUMENT:

1-1/2 INCH IRON PIPE 1 FOOT OUT OF GROUND

RECORD BT'S:

FOUND ROTTEN HEMLOCK STOB, RECORD 22" HEMLOCK, BEARS EAST, 28.8 FEET, 1961 SAFSTROM.

FOUND ROTTEN D. FIR STUMP, RECORD 48" D. FIR, BEARS S 52° W, 25.9 FEET, 1961 SAFSTROM.

NEW BT'S:

10" D. FIR, BEARS N 15° E, 28.4 FEET, SCRIBED "1/4 S19 BT"

7" TANOAK, BEARS EAST, 10.6 FEET, SCRIBED "1/4 S19 BT"

12" D. FIR, BEARS S 14° W, 17.0 FEET, SCRIBED "1/4 S24 BT"

14" D. FIR, BEARS S 66° W, 21.9 FEET, SCRIBED "1/4 S24 BT"

FOR: GEORGIA-PACIFIC CORP.
P.O. BOX 1528
COOS BAY, OR 97420

REGISTERED
PROFESSIONAL
LAND SURVEYOR

Clyde F. Mulkins
OREGON
JULY 14, 1982
CLYDE F. MULKINS
2008

OCTOBER 25, 1994

EXPIRES 12/31/1994

C.S. File No. 63/161

217

BOUNDARY SURVEY

PORTION OF SECTION 24
T28S, R9W W.M., COOS COUNTY, OR

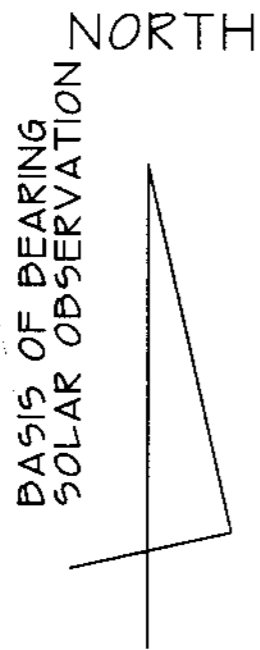

SURVEY FOR:
GEORGIA-PACIFIC CORPORATION
P.O. BOX 1528
COOS BAY, OR 97420

SURVEY BY:
CLYDE F. MULKINS
TIMBER CRUISING & ENGINEERING
P.O. BOX 750
COOS BAY, OR 97420

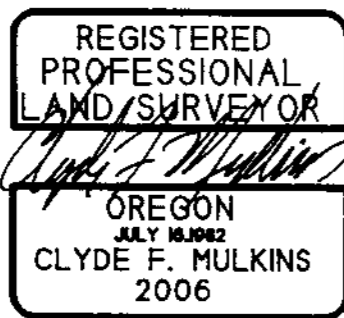

LEGEND

- ⊙ CORNERS FOUND AS SHOWN
- CORNERS SET 5/8" x 30" REDBAR WITH 2-1/2" ALUMINUM CAP MARKED AS SHOWN
- LINES RAN, MKD WITH RED RIBBON AND RED PAINTED BLAZES
- LINES NOT RAN - REMARKED WITH RED RIBBON AND RED PAINTED BLAZES

SCALE: 1 INCH = 400 FEET
NOVEMBER 30, 1994

FD A 1962 3 1/4' D.L.M. BRASS CAP AT THE CORNER OF SECTIONS 13, 14, 23, 24, T28S, R9W, W.M., FROM WHICH:
I FIND A 14' D-FIR WITH HEALED FACE BEARS S 55° W 13.2', NO RECORD
I FIND A 35' HEMLOCK SNAG WITH VISABLE SCRIBES, BEARS N 55° W 35.2' RECORD N55°W 47 LKS
I FIND A 10' D-FIR WITH HEALED FACE, BEARS N 49° W 15.7', NO RECORD
I FIND A 12' D-FIR WITH HEALED FACE, BEARS N 32° E 32.4', NO RECORD
I FIND A 9' D-FIR WITH HEALED FACE, BEARS S 54° E 31.0', NO RECORD

NARRATIVE

THE PURPOSE OF THIS SURVEY WAS TO MARK THE BOUNDARIES OF SECTION 24 AS SHOWN. THE WEST SECTION LINE WAS ESTABLISHED BY A CLOSED TRAVERSE. THE BASIS OF BEARING OF THIS LINE WAS A SOLAR OBSERVATION. THE W 1/4 CORNER WAS RE-ESTABLISHED BY PROPORTION MEASUREMENT WITHIN ONE FOOT OF AN OLD UNRECORDED SQUARED WOODEN STAKE LAYING ON THE GROUND, ITS POSITION WAS INDETERMINATE.

THE W 1/2 OF THE SOUTH SECTION LINE WAS TRAVERSED BETWEEN THE ORIGINAL GLO CORNER POSITIONS REMONUMENTED BY THE DLM IN 1962. THE BASIS OF BEARING FOR THIS LINE WAS THE ORIGINAL GLO SURVEY BEARING. THE E 1/2 OF THE SOUTH SECTION LINE WAS REMARKED USING OLD BLAZES AND FLAGGING BETWEEN ORIGINAL GLO CORNER POSITIONS.

THE S 1/2 OF THE EAST SECTION WAS TRAVERSED BETWEEN THE SE SECTION CORNER AND THE E 1/4 CORNER. THE E 1/4 CORNER WAS ESTABLISHED BY PROPORTION MEASUREMENT BY J.L. SAFSTROM IN SEPTEMBER 1961. THE BASIS OF BEARING FOR THIS LINE WAS THE ORIGINAL GLO SURVEY.

CONTROL SURVEYS FOR THIS SURVEY WERE: BOOK 10, PAGES 59 & 60; AND CORNER REMONUMENTATIONS PER BOOK 627, PAGES 51 THROUGH 54. THE DOUGLAS COUNTY SURVEYOR'S OFFICE REMONUMENTED THE SE SECTION CORNER IN 1957, FOR WHICH I DO NOT HAVE A COPY OF THEIR SHEET. ASSISTING ME WITH THIS SURVEY WERE JASON W. SMITH, FLOYD VANDERVELDEN LS 1047, TROY RAMBO AND RANDY MADDEN. THE FIELD WORK WAS PERFORMED BETWEEN SEPTEMBER 21 AND NOVEMBER 30, 1994. A TOPCON GT5-2B INSTRUMENT WAS USED FOR THIS SURVEY.

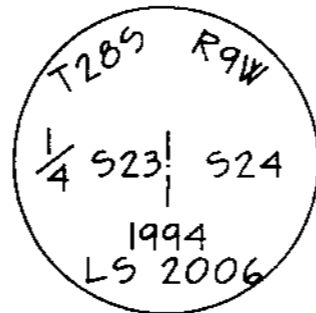

N 0°40'40"W
2674.77

1/4
5.23 5.24

AT THE 1/4 CORNER BETWEEN SECTIONS 23 AND 24, I FIND NO EVIDENCE OF THE ORIGINAL BEARING TREES. I SET A 5/8" x 30" REDBAR WITH A 2-1/2" ALUMINUM CAP MKD. AS SHOWN AT THE MIDDPOINT BETWEEN THE NW CORNER AND THE SW CORNER OF SECTION 24., FROM WHICH:
I FIND AN UNRECORDED 36' CEDAR STUMP MKD. 1/4 S BT' BEARS N 86° E 24.7'
I SCRIBE A 28' CEDAR 1/4 523 BT' BEARS N 05° W 9.3'
I SCRIBE A 12' HEMLOCK 1/4 523 BT' BEARS S 05° W 18.6'
I SCRIBE A 16' HEMLOCK 1/4 524 BT' BEARS S 31° E 13.6'

N 0°40'40"W
2674.77

FD. A 1962 3-1/4' D.L.M. BRASS CAP AT THE CORNER OF SECTIONS 23, 24, 25, 26, T28S, R9W, W.M., FROM WHICH:
I FIND A 60' D-FIR STUMP WITH SCRIBES VISABLE, BEARS N13°E 64.8', RECORD N17°E 95 LKS.
NO RECORD
I FIND A 32' HEMLOCK STUMP, BEARS S03°W 50.3', RECORD S05°W 75-1/2 LKS., NO MARKS OR FACE
I FIND A 16' D-FIR WITH HEALED FACE, BEARS S59°E 44.5' NO RECORD

FD. A 1962 3-1/4' D.L.M. BRASS CAP AT THE 1/4 CORNER OF SECTIONS 24 AND 25, T28S, R9W, W.M., FROM WHICH:
I FIND A 60' D-FIR WITH DARK SCRIBES VISABLE, BEARS S31°W 26.8', RECORD S32 1/2°W 39 LKS.
I FIND AN 8' HEMLOCK WITH HEALED FACE, BEARS S87°W 24.3', NO RECORD
I FIND A 28' HEMLOCK WITH HEALED FACE BEARS N 22°W 45.2', RECORD N21°W, 69 LKS.
I SCRIBE 1/4 S 25 BT ON AN 11' HEMLOCK, BEARS S78°W 41.2'

I FIND A 1 1/2' IRON PIPE AT EAST 1/4 CORNER OF SECTION 24, T28S, R9W, W.M., FROM WHICH:
I FIND A ROTTEN STOB, BEARS EAST 28.8'
I FIND A ROTTEN D-FIR STUMP, BEARS S52°W 25.9', NO MARKS VISABLE
I SCRIBE 1/4 519 BT ON A 10' D-FIR, BEARS N15°E 28.4'
I SCRIBE 1/4 S 19 BT ON A 7' TANOAK, BEARS EAST 10.6'
I SCRIBE 1/4 524 ON A 12' D-FIR, BEARS S14°W 17.0'
I SCRIBE 1/4 524 BT ON A 14' D-FIR, BEARS S66°W 21.9'

I FIND A 1957 2 1/2' DOUGLAS COUNTY BRASS CAP AT THE CORNER OF SECTIONS 24 AND 25, T28S, R9W AND SECTIONS 19 AND 30, T28S R8W, W.M., FROM WHICH:
I FIND A 20' HEMLOCK BEARS N45°E 39.3', RECORD N46°E 39.3', HEALED FACE
I FIND A 25' HEMLOCK, BEARS S80°E 17.2' RECORD S79°E 17.1', HEALED FACE
I FIND A 20' HEMLOCK BEARS S12°W 20.4', RECORD S12 1/2°W 30 1/2 LKS.
I SCRIBE S 24 BT ON AN 11' HEMLOCK, BEARS N39°W 21.0'

5.23 5.24
5.26 5.25

RECORD GLO 589°44'W 40.27 CHS.

2729.49

5. 24

1/4 COR 5. 25

RECORD GLO 589°44'W 40.27 CHS. 5. 24 5. 19

5. 25 5. 30

RECEIVED

DEC 13 1994
Filed Dec 13, 1994
Karlos E. Seidel
County Surveyor

MICROFILMED
MAP IS FOR RECORD ONLY

26868