

AFFIDAVIT OF CORRECTION (Plat)

I, Mark A. Heimburger, being duly sworn, depose and say that I am the surveyor who surveyed the plat of Green View Acres, as filed and recorded in Volume 18, Page 45 A & B, Douglas County, Oregon Plat Records; and

The following correction to said plat is necessary and is as follows:

- 1. In the dedication, the name appears as Green Acres Subdivision; it should read as Green View Acres.

The present fee owners of the property materially affected by said Affidavit are as follows:

- 1. Steven L. and Shannon L. Miles

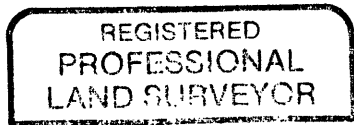

Mark A. Heimburger

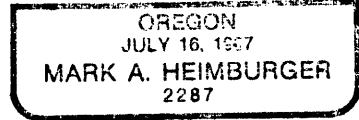

Exp. 6/30/97

Mark A. Heimburger

Mark A. Heimburger
Registered Professional Land Surveyor #2287
3076 N.E. Diamond Lake Blvd.
Roseburg, OR 97470

FILED

Date 9-28-95 By: JP
This survey consists of:
Map: Vol 18 Pg 45 A & B
Narrative: _____
Corner Rpt: _____

NOTARY CERTIFICATE

STATE OF OREGON)
) ss
COUNTY OF DOUGLAS)

DOUGLAS COUNTY
SURVEYOR

Subscribed and sworn to before me this 28th day of September, 1995.

Carole M. Cody
Notary Public for the State of Oregon

My Commission Expires 7/19/99



APPROVAL

I, Janet Lundeen, Douglas County Surveyor, do hereby certify that said affidavit of correction for Green View Acres has been examined by me and that it complies with O.R.S. 92.170.

STATE OF OREGON]
COUNTY OF DOUGLAS] ss.
I, GAY FIELDS, COUNTY CLERK AND RECORDER OF
CONVEYANCES, DO HEREBY CERTIFY THAT THIS
INSTRUMENT WAS RECORDED

95 SEP 28 PM 2:58

GAY FIELDS
DOUGLAS COUNTY CLERK

IN THE OFFICIAL RECORDS OF DOUGLAS COUNTY

BY *Gain Bennett*
DEPUTY

FEE PP

Janet Lundeen 9/28/95
Janet Lundeen
DOUGLAS COUNTY SURVEYOR

BANDED *Surveyor*