

~~M 118-62~~

November 5, 1993

CORNER UPDATE

SW 1/16 Corner Section 13, Twp 21 S, Rng 12 W, WM
Douglas County, Oregon

History:

Corner was established by Richard J Hintz, LS497 in survey to subdivide the SW1/4 of Section 13 for International Paper Co. Survey date was November and December 1981, plat date was December 1991.

Found Monument:

2-1/2 inch brass cap with 1-1/2 inch iron pipe,
marked: PLS 497
SW1/16 S13
1981
T21S R12W

Record BT's:

Fd. 44" Hemlock stump, bears N 71° W, 60.9 ft., tagged.
Gone 48" Spruce, bears S 14-3/4° E, 13.4 ft.

New BT's:

28" double Hemlock stump 4 ft. high with 6" spike in center of larger stump, bears S 80° W, 164.1 ft.
I scribe "SW1/16 BT" on 14" D.Fir, bears S 1° E, 102.9 ft. to spike side center.

Remarks:

Corner falls on north shoulder of Road No. 21-12-13.1 at a planned landing location for logging operations.

For: IP Timberlands Operating Co. LTD.
711 Port Dock Road
Reedsport, OR 97467

BY: Clyde F. Mulkins
Timber Cruising & Engineering
P.O. Box 750
Coos Bay, OR 97420

FILED

Date: 4/25/94 By: JP
This survey consists of:
Map: ~~M 118-62~~
Narrative: _____
Corner Rpt: C.S. 63/154

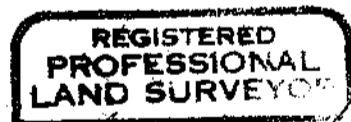

Clyde F. Mulkins



DOUGLAS COUNTY
SURVEYOR