

FILED *JP*

JUN 14 1993

OREGON CORNER RESTORATION FORM

Section 24 Township 22S Range 5W

COUNTY SURVEYOR
DOUGLAS COUNTY, ORE.

County DOUGLAS Date 8 JUNE 1993

Corner Designation

C.W. 1/16 Cor. SECTION 24

- Condition Report Only
- Not Found
- Renewed
- Unrecorded
- Surveyed In
- Referenced Out

Previous Renewals/Surveys, etc. NONE

Monument(s) & Accessories Found: (Condition and Source)

NONE

Monument Detail

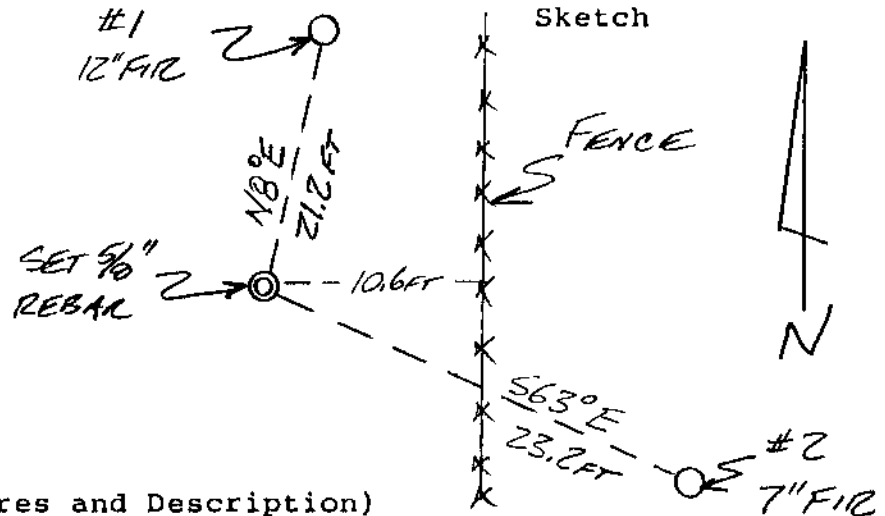

Monument Set (Procedures and Description)

SET 5/8" x 30" REBAR WITH YELLOW PLASTIC CAP MARKED "BRANCH ENG LS1138." CORNER WAS SET ON THE MIDPOINT OF THE LINE BETWEEN THE W 1/4 COR. & THE C 1/4 COR. OF SECTION 24.

New Accessories

#1 - A 12" FIR BEARS NB 8°E 21.2 FT. SCRIBED CW 1/16 S24 BT WITH PK NAIL & BRASS WASHER "LS1138".

#2 - A 7" FIR BEARS S63°E 23.2 FT. SCRIBED CW 1/16 S24 BT WITH PK NAIL & BRASS WASHER "LS1138".

Location & Comments

Surveyor's Seal

Compass Declination 20°E
 Firm/Agency BRANCH ENGINEERING
 Address 310 N 5TH ST. SPRINGFIELD, OR
 Party Chief T. MONTGOMERY
 Notes _____
 Witness R. ANDERSEN

REGISTERED
PROFESSIONAL
LAND SURVEYOR

James A. Branch
OREGON
SEPT. 23, 1977
JAMES A. BRANCH
1138

EXPIRES 31 DEC. '93
C.S. File No. 63/153-
52