

FILED *JP*

JUN 14 1993

OREGON CORNER RESTORATION FORM

COUNTY SURVEYOR
DOUGLAS COUNTY, ORE.

Section 24 Township 22S Range 5W

County DOUGLAS Date 8 JUNE 1993

Corner Designation

CENTER 1/4 COR. SECTION 24

- Condition Report Only
- Not Found
- Renewed
- Unrecorded
- Surveyed In
- Referenced Out

Previous Renewals/Surveys, etc. NONE

Monument(s) & Accessories Found: (Condition and Source)

NONE

Monument Detail

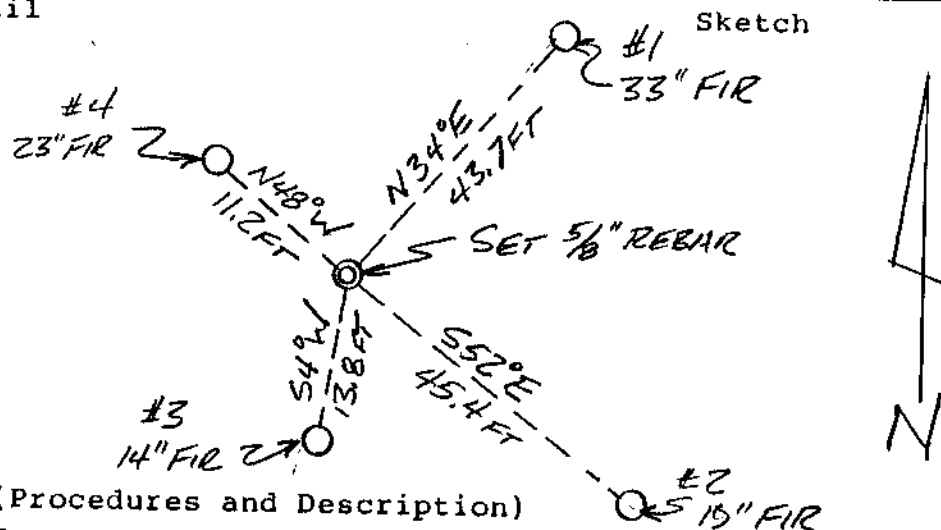

Monument Set (Procedures and Description)

SET 5/8\"/>

New Accessories

- #1 - A 33\"/>

Location & Comments

Compass Declination 20°E
 Firm/Agency BRANCH ENGINEERING
 Address 310 N 5th ST. SPRINGFIELD, OR
 Party Chief G. HOFFMAN
 Notes _____
 Witness T. MONTGOMERY

Surveyor's Seal

REGISTERED
PROFESSIONAL
LAND SURVEYOR

James A. Branch

OREGON
SEPT. 23, 1977
JAMES A. BRANCH
1138

EXPIRES 31 DEC. 1993

C.S. File No. 63/153-50