

FILED JP

OREGON CORNER RESTORATION FORM

JUN 14 1993

Section 24 Township 22S Range 5W

COUNTY SURVEYOR
DOUGLAS COUNTY, ORE.

County DOUGLAS Date 8 JUNE 1993

Corner Designation

N 1/16 CORNER SEC 23 & 24

- Condition Report Only
- Not Found
- Renewed
- Unrecorded
- Surveyed In
- Referenced Out

Previous Renewals/Surveys, etc. NONE

Monument(s) & Accessories Found: (Condition and Source)

NONE

Monument Detail

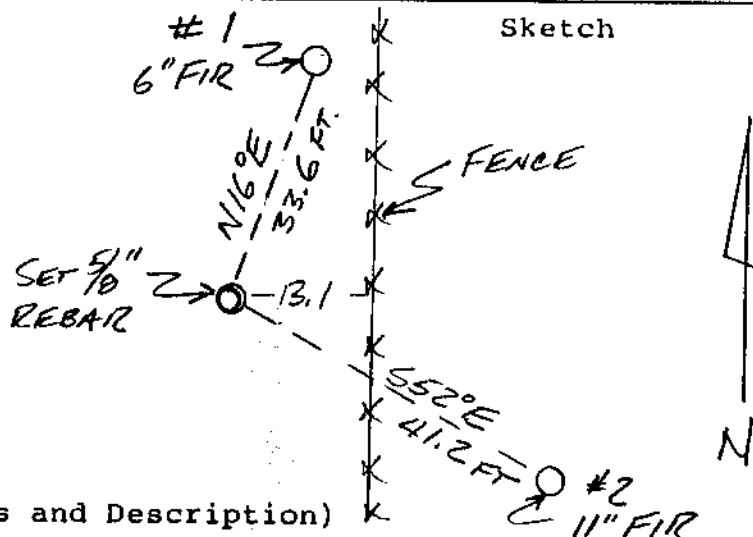

Monument Set (Procedures and Description)

SET 9/8" X 30" REBAR WITH YELLOW PLASTIC CAP MARKED "BRANCH ENG LS1138"
CORNER WAS SET ON LINE HALFWAY BETWEEN 1/4 CORNER FOR SECTION 23 & 24
AND THE CORNER OF SECTIONS 14, 13, 24 & 23.

New Accessories

#1 - A 6" FIR BEARS N16°E 33.6 FT SCUBED N1/16S24BT WITH PK NAIL
& BRASS WASHER "LS1138."

#2 AN 11" FIR BEARS S52°E 41.2 FT SCUBED N1/16S24BT WITH PK NAIL
& BRASS WASHER "LS1138."

Location & Comments

Surveyor's Seal

Compass Declination 20°E

Firm/Agency BRANCH
ENGINEERING

Address 310 N 5TH ST
SPRINGFIELD, OR

Party Chief T. MONTGOMERY

Notes

Witness R. ANDREAGEN

REGISTERED
PROFESSIONAL
LAND SURVEYOR

OREGON
SEPT. 23, 1977
JAMES A. BRANCH
1138

EXPIRES 31 DEC 1993
C.S. File No. 63/LS3-49