

OREGON CORNER RESTORATION FORM

FILED *JP*

Section 22 Township 31S Range 8W

DEC 21 1993

County DOUGLAS Date 12/13/93

COUNTY SURVEYOR  
DOUGLAS COUNTY, ORE.

Corner Designation

$5\frac{1}{16}$  21 | 22

- Condition Report Only
- Not Found
- Renewed
- Unrecorded
- Surveyed In
- Referenced Out

Previous Renewals/Surveys, etc. M65-49

Monument(s) & Accessories Found: (Condition and Source)

FOUND 8" CHINQUAPIN, N15 1/2 W 15<sup>7</sup>

7" CHINQUAPIN, S81 E 12<sup>0</sup>

Monument Detail

Sketch



Monument Set (Procedures and Description)

SET 5/8" x 36" I. Rod w/ Aluminium Cap

Set at record distance and bearing from BTs

New Accessories

NONE

Location & Comments

CORNER WAS DESTROYED RECENTLY BY CAT MAKING A FIRE TRAIL

Compass Declination \_\_\_\_\_  
 Firm/Agency ROSEBURG RESOURCES, CO.  
 Address P.O. Box 1088 Roseburg, OR 97470  
 Party Chief Bill Olson  
 Notes \_\_\_\_\_  
 Witness Ralph McMahis

Surveyor's Seal

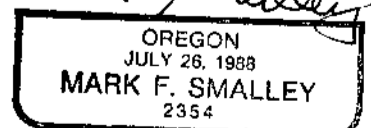
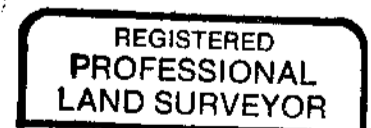

RENEW 12/21/94

C.S. File No. 63/153 - 46