

M 117-76

FILED *AP*

OREGON CORNER RESTORATION FORM

NOV 4 1993

Section 24 Township 315 Range 6W

COUNTY SURVEYOR
DOUGLAS COUNTY, ORE.

County Douglas Date Oct. 29, 1993

Corner Designation

T315		
R6W	513 518	R5W
	524 519	

- Condition Report Only
- Not Found
- Renewed
- Unrecorded
- Surveyed In
- Referenced Out

Previous Renewals/Surveys, etc. Douglas County Surveyor's Office, John Powell, May & June 1966, CS File 54/25.

Monument(s) & Accessories Found: (Condition and Source)

- Found 2 1/2" Brass Cap on a 1" Iron Pipe from which a:
- 1 1/2" Iron Pipe bears N44°E, 17 feet.
- 8" D. Fir BT, face overgrown, bears N47°E, 29 1/2 feet
(record N44°E, 30 ± feet)
- 12" Live Oak BT, face overgrown, bears S65°E, 36 ± feet.
- 11" Live Oak BT, scribes visible, bears N7°E, 25 ± feet,
(record North, 25 1/2 feet.)
- 11" Live Oak BT Stump, scribes visible, bears S42°W, 14 ± feet.

Monument Detail

Sketch

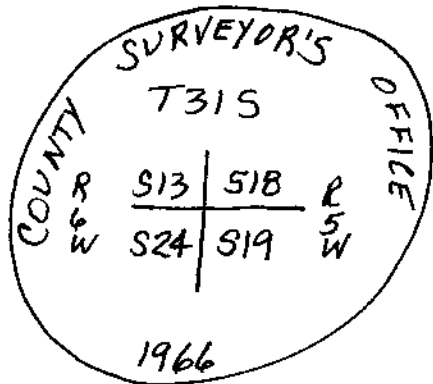

~~Monument Set (Procedures and Description)~~

Additional Accessories Found:

- 12" Live Oak BT, face rotted out, bears N47°E, 25 ± feet,
(record N43°E, 26 ± feet).

New Accessories

- 12" D. Fir BT, I scribed "T315, R6W, 524, BT" bears
S68°W, 60 ± feet.
- 10" Live Oak BT, I scribed "T315, R6W, 513, BT"
bears N32°W, 48 ± feet.

Location & Comments

Corner lies North, Compass Declination 20°E
230 feet above Firm/Agency Shaner
spur logging road. Engineering, Inc.
 Address P.O. Box 1430
Roseburg, Oregon 97470
 Party Chief B.A. Shaner
 Notes " "
 Witness John Wright
Clem Berlier

Surveyor's Seal

REGISTERED
PROFESSIONAL
LAND SURVEYOR

Bruce A Shaner

OREGON
OCT. 4, 1957
BRUCE A. SHANER
430

Expires Dec. 31, 1994

C.S. File No. 63/153-45