

M 117-76

FILED *JP*

OREGON CORNER RESTORATION FORM

NOV 4 1993

Section 24 Township 31S Range 6W

COUNTY SURVEYOR
DOUGLAS COUNTY, ORE.

County Douglas Date Oct. 29, 1993

Corner Designation

$\frac{1}{4}$ $\frac{513}{524}$

- Condition Report Only
- Not Found
- Renewed
- Unrecorded
- Surveyed In
- Referenced Out

Previous Renewals/Surveys, etc.

Original Survey by U.S. Govt. Land Office, 1882.

Monument(s) & Accessories Found: (Condition and Source)

None. (Made several diligent searches.)

Monument Detail

Sketch



Set $\frac{5}{8}$ " Iron Rod with $1\frac{1}{2}$ " Aluminum Cap
 in Steep, Rocky Cutbank of Mainline Logging Road,
 (No way to install Brass Cap.)
 Monument Set (Procedures and Description)

As above. Corner was surveyed in & set by
proportioning found distance & bearing with U.S.
G.L.D. records. See Survey File, Douglas County
Surveyor's Office, No. M. 117-76.

New Accessories: From Corner set, a:

- 10" D. Fir BT, I scribed "1/4 513 BT" bears N35°E, 32± feet.
- 10" D. Fir BT, I scribed "1/4 513 BT" bears N83°E, 40± feet.
- 14" D. Fir BT, I scribed "1/4 524 BT" bears S38°E, 41± feet.
- 10" D. Fir BT, I scribed "1/4 524 BT" bears S2½°W, 78± feet.
- 6 Foot Steel Fence Post, I set, bears East, 0± feet.

Location & Comments

Corner is on West Compass Declination 20°E
cutbank of U.S. Firm/Agency Shaner
B.L.M. Road No. Engineering, Inc.
30-6-35.D. Address P.O. Box 1430

Roseburg, Oregon 97470
 Party Chief B.A. Shaner
 Notes " "

Witness John Wright
Clem Berlier

Surveyor's Seal

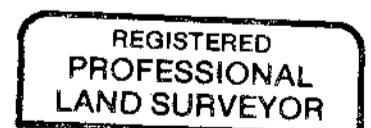

Bruce A. Shaner

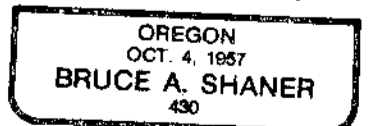

Expires Dec. 31, 1994

C.S. File No. 63/153-42