

FILED ~~8~~

OREGON CORNER RESTORATION FORM

SEP 2 1993

Section 28 Township 31S Range 5W

COUNTY SURVEYOR
DOUGLAS COUNTY, ORE.

County Douglas Date May 19, 1993

Corner Designation

E 1/4 S, Sec. 28
or 1/4 S, 28 & 27

- Condition Report Only
- Not Found
- Renewed
- Unrecorded
- Surveyed In
- Referenced Out

Previous Renewals/Surveys, etc.

Renewed by Victor King, 1959 and by Douglas County Surveyor, 1966 (Powell).

Monument(s) & Accessories Found: (Condition and Source)

I found both original corner stone (24" x 12" x 8" with "1/4" scribed on it) and Brass Cap (see below) lying loose on steep rocky slope. I placed them in ground at proper position, and from which Brass Cap is:

Original Corner Stone (as above) lies in ground on North Side of Brass Cap.

60" (orig. 44") D. Fir BT, bark scribes visible, bears N80°E, 17 1/2 feet (orig. 17 1/2 feet) to face of tree.

Monument Detail

Sketch

54" Pine BT Stump, scribes visible, bears N60°W (Powell erroneously called it N65°^E), 30 1/2 feet to face of stump.

20" W. Fir BT, face overgrown, bears N39°W (Record N43°W), 103 3 feet to center of tree. (Record 104 3 feet).

Monument



2 1/2" Brass Cap on a 1" Iron Pipe

Monument Set (Procedures and Description)

Set Steel Fence Post South, 0 5 feet, of Brass Cap.

New Accessories

16" W. Fir BT, I scribed "1/4 S27 BT" bears N6°E, 43 3 feet to center of tree.

Location & Comments

See aerial photo. Presently on West edge of old growth D. Fir stand.

Compass Declination 20°E

Firm/Agency Shaner Engineering, Inc.

Address P.O. Box 1430 Roseburg, Oregon 97470

Party Chief B. Shaner

Notes " "

Witness C. Berlier & J. Wright

Surveyor's Seal

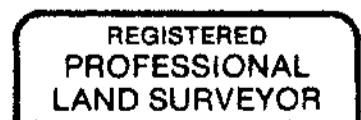

Bruce A. Shaner

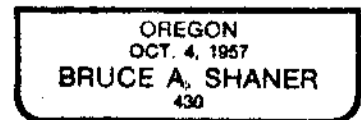

Expires Dec 31, '94

C.S. File No. 63/153-35