

R.M. 3-79

FILED JP

OREGON CORNER RESTORATION FORM
Donation Land Claim No. 39
in Section 16 Township 29S Range 4W

SEP 2 1993

COUNTY SURVEYOR
DOUGLAS COUNTY, ORE.

County Douglas Date Aug 28, '93

Corner Designation

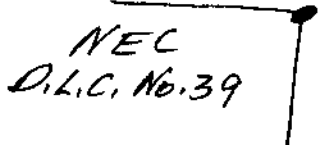

- Condition Report Only
- Not Found
- Renewed
- Unrecorded
- Surveyed In
- Referenced Out

Previous Renewals/Surveys, etc.

Byron, Deputy County Surveyor, 1963; Powell, Deputy County Surveyor, 1969.

Monument(s) & Accessories Found: (Condition and Source)

Found 2 1/2" Brass Cap on a 1" Iron Pipe, from which a:
16" D. Fir BT, face overgrown, bears S24°W, 50.0 feet.
16" D. Fir BT, " " , bears N41°W, 21.2 feet.

Monument Detail

Sketch

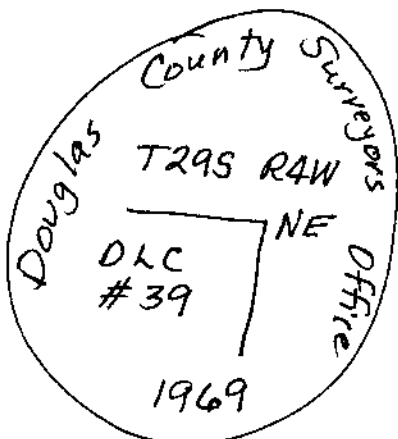

Monument Set (Procedures and Description)

None.

New Accessories

None.

Location & Comments

At fence corner,
fence going West
and South.

Compass Declination 20 1/2° E

Firm/Agency Shaner

Address P.O. Box 1430

Roseburg, OR 97470

Party Chief B. Shaner

Notes " "

Witness J. Wright

Surveyor's Seal

REGISTERED
PROFESSIONAL
LAND SURVEYOR

Bruce A. Shaner

OREGON
OCT. 4, 1957
BRUCE A. SHANER
430

Expires Dec 31, '94

C.S. File No. 63/153