

M 112-78

FILED *SC*

OREGON CORNER RESTORATION FORM

JUL 23 1993

Section 30 Township 2B5 Range BW

COUNTY SURVEYOR
DOUGLAS COUNTY, ORE.

County Douglas Date July 5, 1993

Corner Designation

19/20
30/29

- Condition Report Only
- Not Found
- Renewed
- Unrecorded
- Surveyed In
- Referenced Out

Previous Renewals/Surveys, etc.

See Corner Renewal Report by Douglas County Deputy
Surveyor Larry E. Monrean, Oct. 8, 1985.

Monument(s) & Accessories Found: (Condition and Source)

See above report. I carefully checked every thing
and it all is exactly same.

BA Shaner

Monument Detail

Sketch

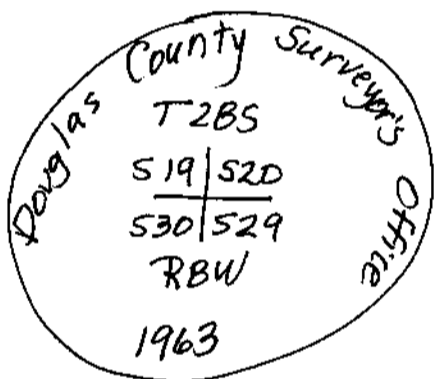

Monument Set (Procedures and Description)

None.

New Accessories

None.

Location & Comments

Corner is about
500 feet, N10°W,
from switchback
in old logging
road.

Compass Declination 20 1/2° E

Firm/Agency

Shaner Engineering, Inc.

Address P.O. Box 1430

Roseburg, Oregon 97470

Party Chief B. Shaner

Notes " "

Witness Jack Wright.

Clem Berlier

Surveyor's Seal

REGISTERED
PROFESSIONAL
LAND SURVEYOR

Bruce A. Shaner

OREGON
OCT. 4, 1957
BRUCE A. SHANER
430

EXPIRES 12-31-94

C.S. File No. 63/153-18