

OREGON CORNER RESTORATION FORM

FILED JP

Section 14 Township 20S Range 8W

MAR 9 1993

County Douglas Date 01-21-93

COUNTY SURVEYOR  
DOUGLAS COUNTY, ORE.

CORNER DESIGNATION

West  $\frac{1}{4}$  Corner  
Section 14

- Condition
- Not Found
- Renewed
- Unrecorded
- Surveyed In
- Referenced Out

Previous Renewals/Surveys, etc. Original G.L.O. Survey by William P. Wright in 1883-1884. 1953-1954 B.L.M. Survey by Thomas Tillman and a 1967 B.L.M. Remonumentation Survey.

Monument(s) & Accessories Found: (Condition and Source)

Found 1954 G.L.O. Brass Cap set firmly in the ground.  
Also found 6' steel fence post beside brass cap. No 1954 bearing trees found.

Monument Detail

Sketch

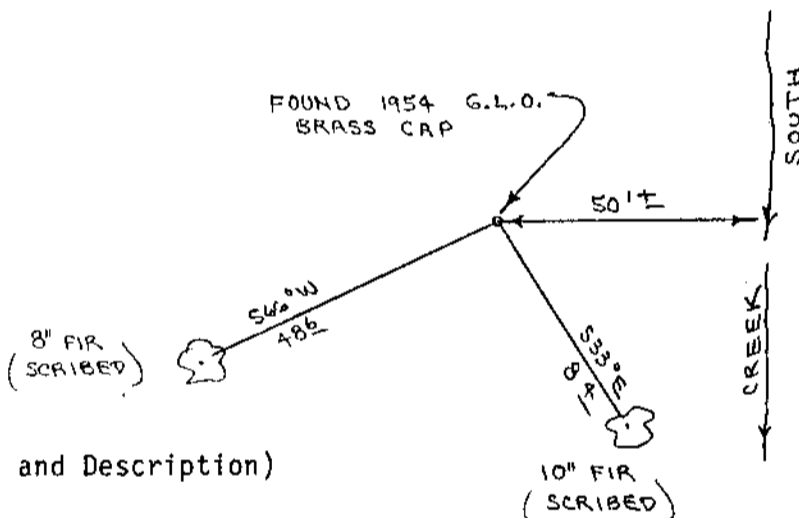

Monument Set (Procedures and Description)

New Accessories

Set 8" Fir, S66W, 48.6' (Scribed/Painted Red)  
10" Fir, S33E, 8.4' (Scribed/Painted Red)  
Painted both bearing trees red.

Location & Comments

Corner lies on S.E. slope about 50' West of Creek. Compass Declination 20 $\frac{1}{2}$   
Creek bears North-South Firm/Agency Roberts  
Surveying, Inc. Address 29 West 29th St.  
Eugene, Oregon 97405 Party Chief Stuart Duce  
Notes Witness Brad Cole

Surveyor's Seal

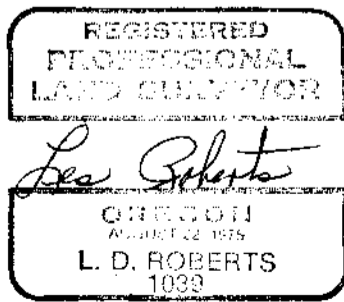

MAR 9 1993

OREGON CORNER RESTORATION FORM

Section 10 Township 20S Range 8W

COUNTY SURVEYOR  
DOUGLAS COUNTY, ORE.

County Douglas Date 01-18-93

CORNER DESIGNATION

S.E. Corner  
Section 10

- Condition Report Only
- Not Found
- Renewed
- Unrecorded
- Surveyed In
- Referenced Out

Previous Renewals/Surveys, etc. Original G.L.O. Survey by William P. Wright in 1883-1884. 1953-1954 B.L.M. Survey by Thomas Tillman and a 1967 B.L.M. Remonumentation Survey.

Monument(s) & Accessories Found: (Condition and Source)

Found 1954 G.L.O. Brass Cap set firmly in the ground.  
20" Fir Stump, S30W, 27.5' (Scar Vis.), 1954 BT. Record S30W, 27.7'  
22" Fir Stump, S32E, 4.5' (Scar Vis.), 1954 BT. Record S313/4E, 4.6'  
40" Fir, N4E, 18.0' (Scar Vis.), 1967 BT. Record N43 1/2 E, 17.8'  
Painted all bearing trees red.

Monument Detail

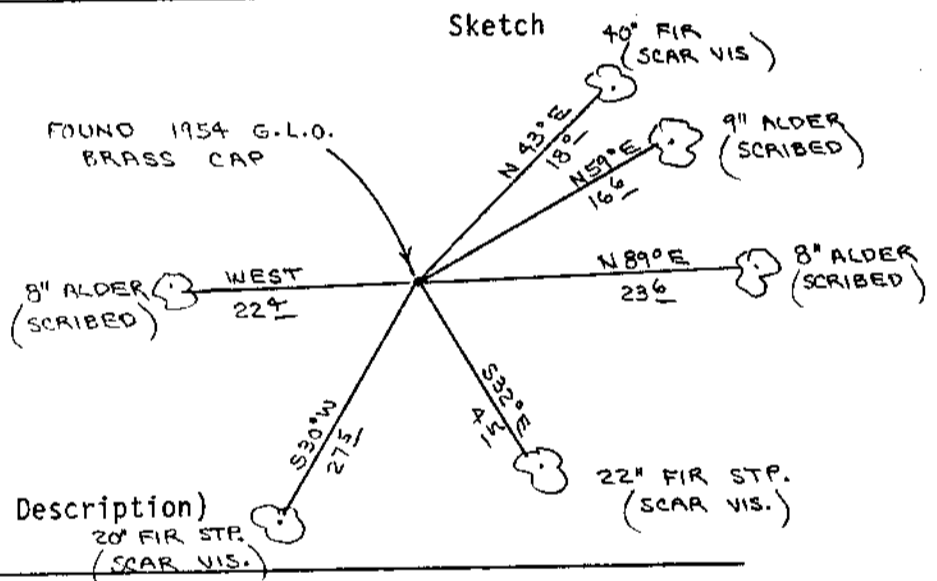

Monument Set (Procedures and Description)

New Accessories

Set 8" Alder, N89°E, 23.6' (Scribed/Painted Red)  
8" Alder, West, 22.4' (Scribed/Painted Red)  
9" Alder, N59°E, 16.6' (Scribed/Painted Red)  
Painted all bearing trees red.

Location & Comments

Corner lies on S.W. slope about 120' West of spur ridge. Ridge bears N10W and S10E. Compass Declination 20 1/2  
Firm/Agency Roberts Surveying, Inc.  
Address 29 West 29th St. Eugene, Oregon 97405  
Party Chief Ted Baker  
Notes  
Witness Stuart Duce

Surveyor's Seal

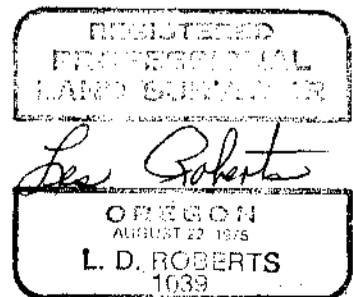

# 23  
+

MAR 9 1993

OREGON CORNER RESTORATION FORM

Section 14 Township 20S Range 8W

COUNTY SURVEYOR  
DOUGLAS COUNTY, ORE.

County Douglas Date 01-25-93

CORNER DESIGNATION

North  $\frac{1}{4}$  Corner  
Section 14

- Condition Report Only
- Not Found
- Renewed
- Unrecorded
- Surveyed In
- Referenced Out

Previous Renewals/Surveys, etc. Original G.L.O. Survey by William P. Wright in 1883-1884. 1953-1954 B.L.M. Survey by Thomas Tillman and a 1967 B.L.M. Remonumentation Survey.

Monument(s) & Accessories Found: (Condition and Source)

Found 1954 G.L.O. Brass Cap set firmly in the ground.

15" Fir Snag, S57W, 35.0' (Scar Vis.), 1954 BT. Record S57W, 35.6'

17" Fir Snag, N45W, 12.0' (Scar Vis.), 1954 BT. Record N43 $\frac{1}{2}$ W, 11.2'

12" Fir Snag, S75E, 33.3' (Scar Vis.), 1967 BT. Record S76E, 33.0'

20" Fir Snag, N34E, 17.5' (Scar Vis.), 1967 BT. Record N34 $\frac{1}{2}$ E, 17.2'

Painted all bearing trees red. Also found 6' steel fence post beside brass cap.

Monument Detail

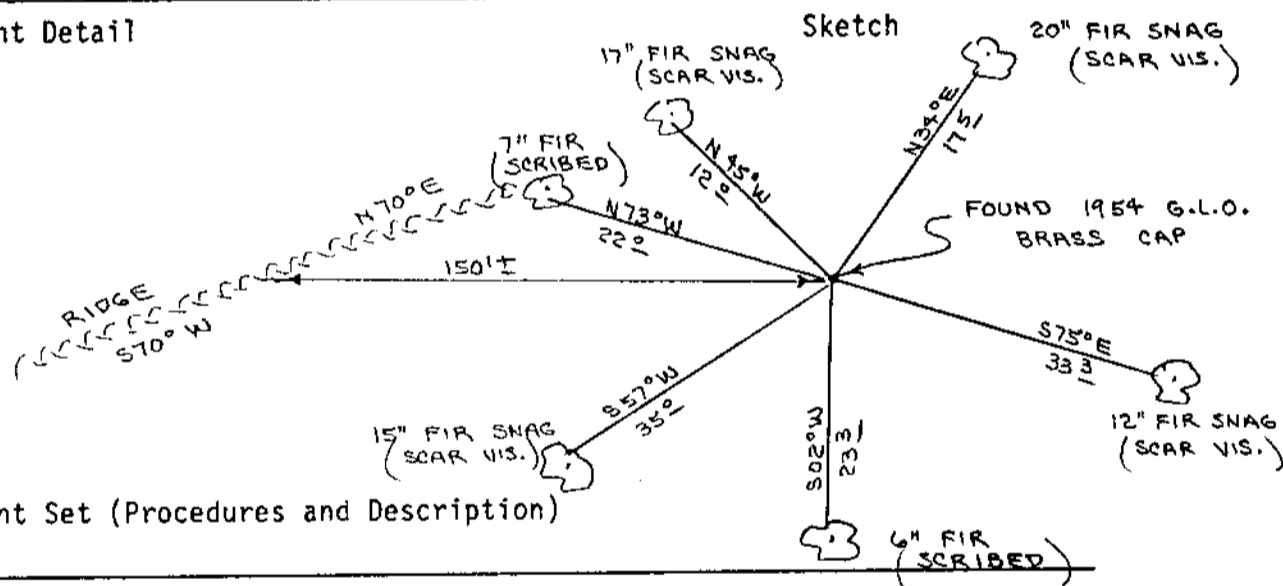

Monument Set (Procedures and Description)

New Accessories

Set 6" Fir, S02W, 23.3' (Scribed/Painted Red)

7" Fir, N73W, 22.0' (Scribed/Painted Red)

Painted all bearing trees red.

Location & Comments

Corner lies on South slope about 150' East of ridge. Compass Declination  $20\frac{1}{2}$

Ridge bears N70E and S70W Firm/Agency Roberts Surveying, Inc.

Address 29 West 29th St. Eugene, Oregon 97405

Party Chief Stuart Duce

Notes \_\_\_\_\_

Witness Brad Cole

Surveyor's Seal

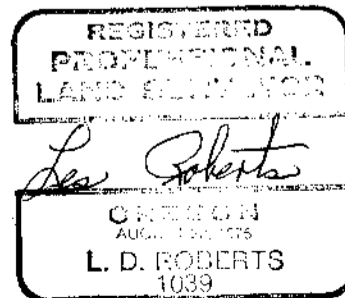

# 24

MAR 9 1993

OREGON CORNER RESTORATION FORM

Section 10 Township 20S Range 8W

COUNTY SURVEYOR  
DOUGLAS COUNTY, ORE.

County Douglas Date 01-18-93

CORNER DESIGNATION

South  $\frac{1}{4}$  Corner  
Section 10

- Condition Report Only
- Not Found
- Renewed
- Unrecorded
- Surveyed In
- Referenced Out

Previous Renewals/Surveys, etc. Original G.L.O. Survey by William P. Wright in 1883-1884. 1953-1954 B.L.M. Survey by Thomas Tillman and a 1967 B.L.M. remonumentation survey.

Monument(s) & Accessories Found: (Condition and Source)

Found 1954 G.L.O. Brass Cap set firmly in the ground.  
60" Downed Cedar, S22W, 47.0' (Scar Vis.), 1954 BT. Record S22W, 46.9' ✓  
66" Cedar, N56E, 24.6' (Scar Vis.), 1954 BT. Record N57E, 23.8' ✓  
Also found 6' steel fence post beside brass cap. Painted all bearing trees red.

Monument Detail

Sketch

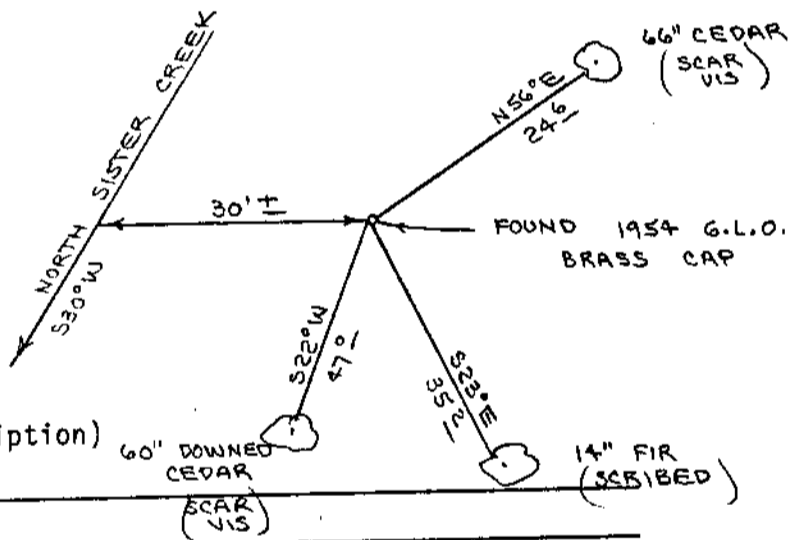

Monument Set (Procedures and Description)

New Accessories

Set 14" Fir, S23E, 35.2' (Scribed/Painted red). Painted all bearing trees red.

Location & Comments

Corner lies on N.W. slope Compass Declination 20 $\frac{1}{2}$   
 about 30' East on North Firm/Agency Roberts  
Sister Creek, Surveying, Inc.  
Address 29 West 29th St.  
Eugene, Oregon 97405  
Party Chief Ted Baker  
Notes  
Witness Stuart Duce.

Surveyor's Seal

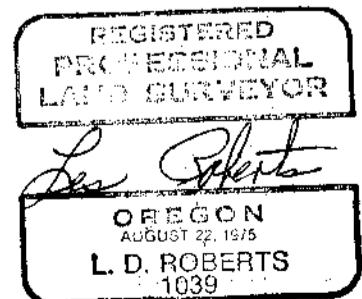

#21

MAR 9 1993

OREGON CORNER RESTORATION FORM

Section 14 Township 20S Range 8W

County Douglas Date 01-27-93

COUNTY SURVEYOR  
DOUGLAS COUNTY, ORE.

CORNER DESIGNATION

West 1/16 Corner, North  
Line Section 14

- Condition Report Only
- Not Found
- Renewed
- Unrecorded
- Surveyed In
- Referenced Out

Previous Renewals/Surveys, etc. Original G.L.O. Survey by William P. Wright in 1883-1884. 1953-1954 B.L.M. Survey by Thomas Tillman and a 1967 B.L.M. Remonumentation Survey.

Monument(s) & Accessories Found: (Condition and Source)

None

Monument Detail

Sketch

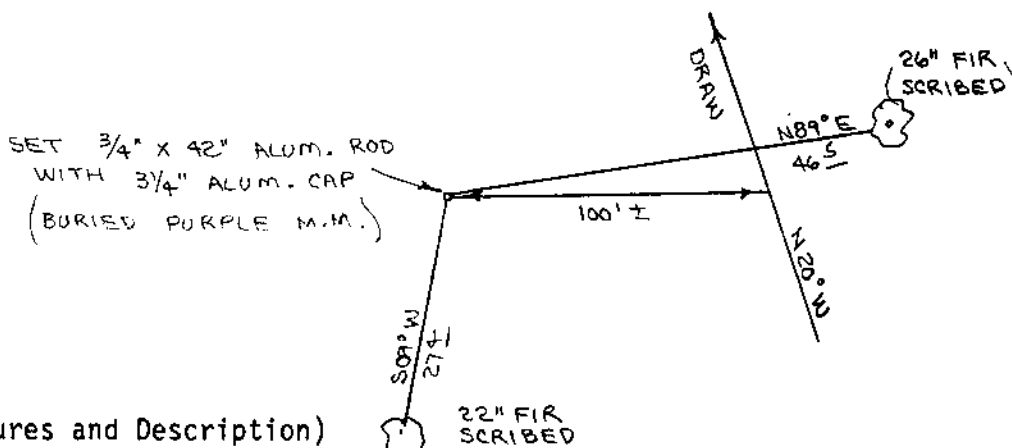

Monument Set (Procedures and Description)

Set 3/4" x 42" Aluminum Rod with a 3/4" Aluminum Cap. Buried purple magnetic marker under 42" Aluminum Rod. See filed survey for survey procedures.

New Accessories

- Set 22" Fir, S09W, 27.4' (Scribed/Painted Red)
- 26" Fir, N89E, 46.5' (Scribed/Painted Red)
- Set 72" Aluminum Post, with land monument survey sign attached to, beside brass cap. Painted both bearing trees red.

Location & Comments

Corner lies on N.E. slope about 30' West of draw.  
 Draw bears N20W and S20E  
 Compass Declination 20 1/2  
 Firm/Agency Roberts Surveying, Inc.  
 Address 29 West 29th St. Eugene, Oregon 97405  
 Party Chief Stuart Duce  
 Notes \_\_\_\_\_  
 Witness Brad Cole

Surveyor's Seal

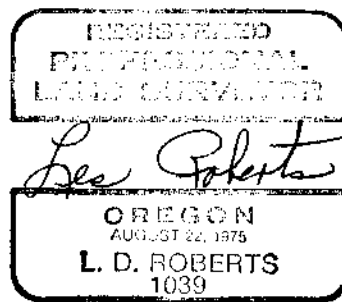

OREGON CORNER RESTORATION FORM

MAR 9 1993

Section 15 Township 20S Range 8W

COUNTY SURVEYOR  
DOUGLAS COUNTY, ORE.

County Douglas Date 01-29-93

CORNER DESIGNATION

East 1/16 Corner, North  
Line Section 15

- Condition Report Only
- Not Found
- Renewed
- Unrecorded
- Surveyed In
- Referenced Out

Previous Renewals/Surveys, etc. Original G.L.O. Survey by William P. Wright in 1883-1884. 1953-1954 B.L.M. Survey by Thomas Tillman and a 1967 B.L.M. Remonumentation Survey.

Monument(s) & Accessories Found: (Condition and Source)

None

Monument Detail

Sketch

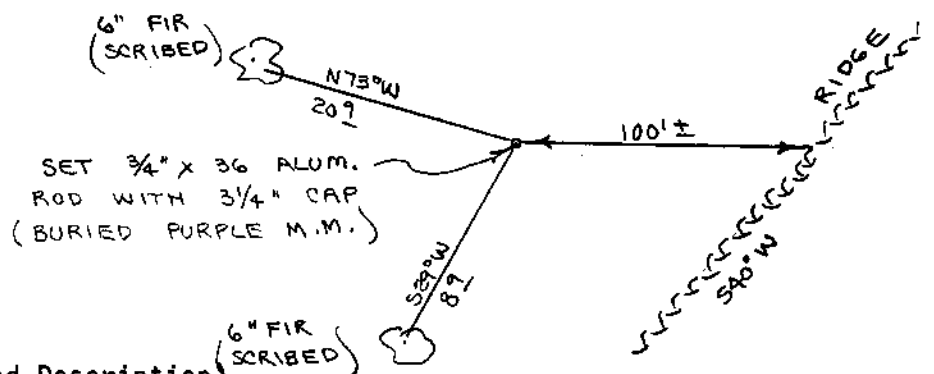

Monument Set (Procedures and Description)

Set 3/4" x 36" Aluminum Rod with a 3/4" Aluminum Cap. Buried purple magnetic marker under 36" Aluminum Rod. See filed survey for survey procedures.

New Accessories

- 6" Fir, S29W, 8.9' (Scribed/Painted Red)
- 6" Fir, N73W, 20.9' (Scribed/Painted Red)
- Set 72" Aluminum Post with land monument survey sign attached to, beside brass cap. Painted both bearing trees red.

Location & Comments

Corner lies on N.W. slope about 100' West of ridge. Ridge bears N40E and S40W Compass Declination 20 1/2  
Firm/Agency Roberts Surveying, Inc.  
Address 29 West 29th St. Eugene, Oregon 97405  
Party Chief Stuart Duce  
Notes  
Witness Brad Cole

Surveyor's Seal

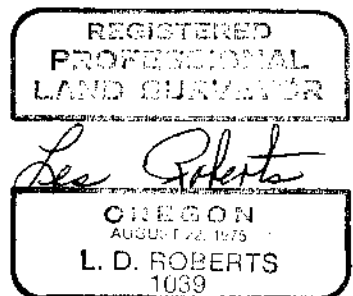

OREGON CORNER RESTORATION FORM

MAR 9 1993

Section 14 Township 20S Range 8W

COUNTY SURVEYOR  
DOUGLAS COUNTY, ORE.

County Douglas Date 01-28-93

CORNER DESIGNATION

North 1/16 Corner, West  
Line Section 14

- Condition Report Only
- Not Found
- Renewed
- Unrecorded
- Surveyed In
- Referenced Out

Previous Renewals/Surveys, etc. Original G.L.O. Survey by William P. Wright in 1883-1884. 1953-1954 B.L.M. Survey by Thomas Tillman and a 1967 B.L.M. Remonumentation Survey.

Monument(s) & Accessories Found: (Condition and Source)

None

Monument Detail

Sketch

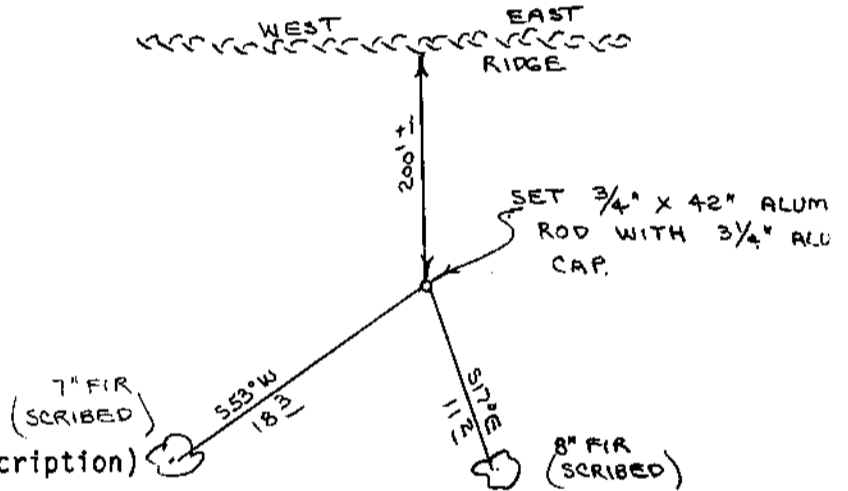

Monument Set (Procedures and Description)

Set 3/4" x 42" Aluminum Rod with a 3/4" Aluminum Cap. Buried purple magnetic marker under 42" Aluminum Rod. See filed survey for survey procedures.

New Accessories

- Set 7" Fir, S53W, 18.3' (Scribed/Painted Red)
- 8" Fir, S17E, 11.2' (Scribed/Painted Red)
- Set 72" Aluminum Post, with land monument survey sign attached to, beside brass cap. Painted both bearing trees red.

Location & Comments

Corner lies on South slope about 200' South of ridge. Compass Declination 20 1/2  
Ridge bears East-West Firm/Agency Roberts Surveying, Inc.  
Address 29 West 29th St. Eugene, Oregon 97405  
Party Chief Stuart Duce  
Notes  
Witness Brad Cole

Surveyor's Seal

