

Rm. 122 - COURTHOUSE  
ROSEBURG, OR 97470

DOUGLAS COUNTY SURVEYOR

PH. 672-3311  
EXT. 114

VISIT  
CORNER ~~RENEWAL~~ REQUEST

Section 31 Twp. 25 S Rge. 1 W

Date 3/17/92

Condition of Corner and Accessories: 1978 Cadastral Brass Cap on  
rock outcrops 60 feet North of main ridge top divide  
btw. Mace Mtn. & Rock Creek. ~~Cap~~ Shape

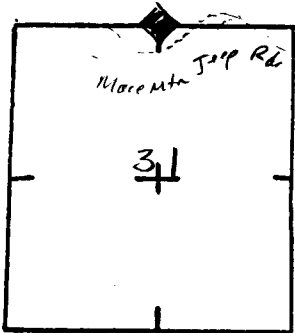

APR 2 1992  
COUNTY SURVEYOR  
DOUGLAS COUNTY, ORE.

TO REACH: (Please show approximate distances, clearcuts, roads, fences, etc.) 280 Ft. West of Mace  
Mtn. Jeep road. USFS marker on NW edge of Road.

(See MAP)

Notify immediately prior to renewal visit? Yes  No

Name Bill May

Notify following renewal visit? Yes  No

Address BLM

Is corner in immediate danger of being lost or disturbed? Yes  No

Telephone 440-4930 306

ADDITIONAL COMMENTS BLM plans to widen the Mace Mtn. Jeep road into an  
all weather logging road.

C.S. File No. 63/140-5



3-17-92

FILED

APR 2 1992

COUNTY SURVEYOR  
DOUGLAS COUNTY, ORE.

Douglas County Surveyor

Enclosed are visitation records for several corners I visited  
in the past year.

There is one Renewal request.

Bill May  
North Umpqua Resource Area  
BLM  
Roseburg  
6-440-4930 Ext. 306

*Rec'd 3/18/92*

*Treat as corner reports  
Per ED*

U.S. File No. 63/140