

Rm. 122 - COURTHOUSE
ROSEBURG, OR 97470

DOUGLAS COUNTY SURVEYOR

Ph. 672-3311
EXT. 114

CORNER RENEWAL REQUEST

Section 29 Twp. 25S Rge. 1W

Date 3/17/92

Condition of Corner and Accessories: 1961 County Surveyor Brass Cap.
and BT's in good shape. Champions logger saved
this corner and BT's

FILED

APR 2 1992

COUNTY SURVEYOR
DOUGLAS COUNTY, ORE

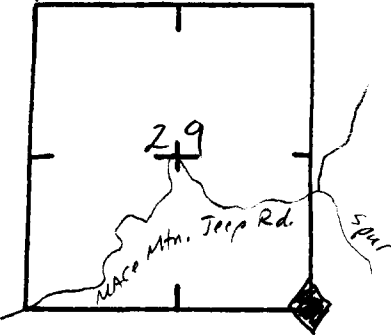

TO REACH: (Please show approximate distances, clearcuts, roads, fences, etc.) 1,200 ft. South of Mace
mtn Jeep road. About 500 ft SW of landing @ end of Spur in
SWSW, sec. 28
(see map)

Notify immediately prior to renewal visit? Yes No

Notify following renewal visit? Yes No

Is corner in immediate danger of being lost or disturbed? Yes No

Name Bill May

Address BLM

Telephone 440-4930 306

ADDITIONAL COMMENTS _____

C.S. File No. 63/40-4

VICINITY MAP MACE MTN. T25S, R1W, WM.

LEGEND

- EXISTING ROAD
- - - ROAD TO BE CONST.
- o-o EXISTING LOCKED GATE
- HOUSES
- ⊙ DISPOSAL SITE
- ▒ MANT. STOCKPILE
- ▬ EXISTING PAVED ROADS

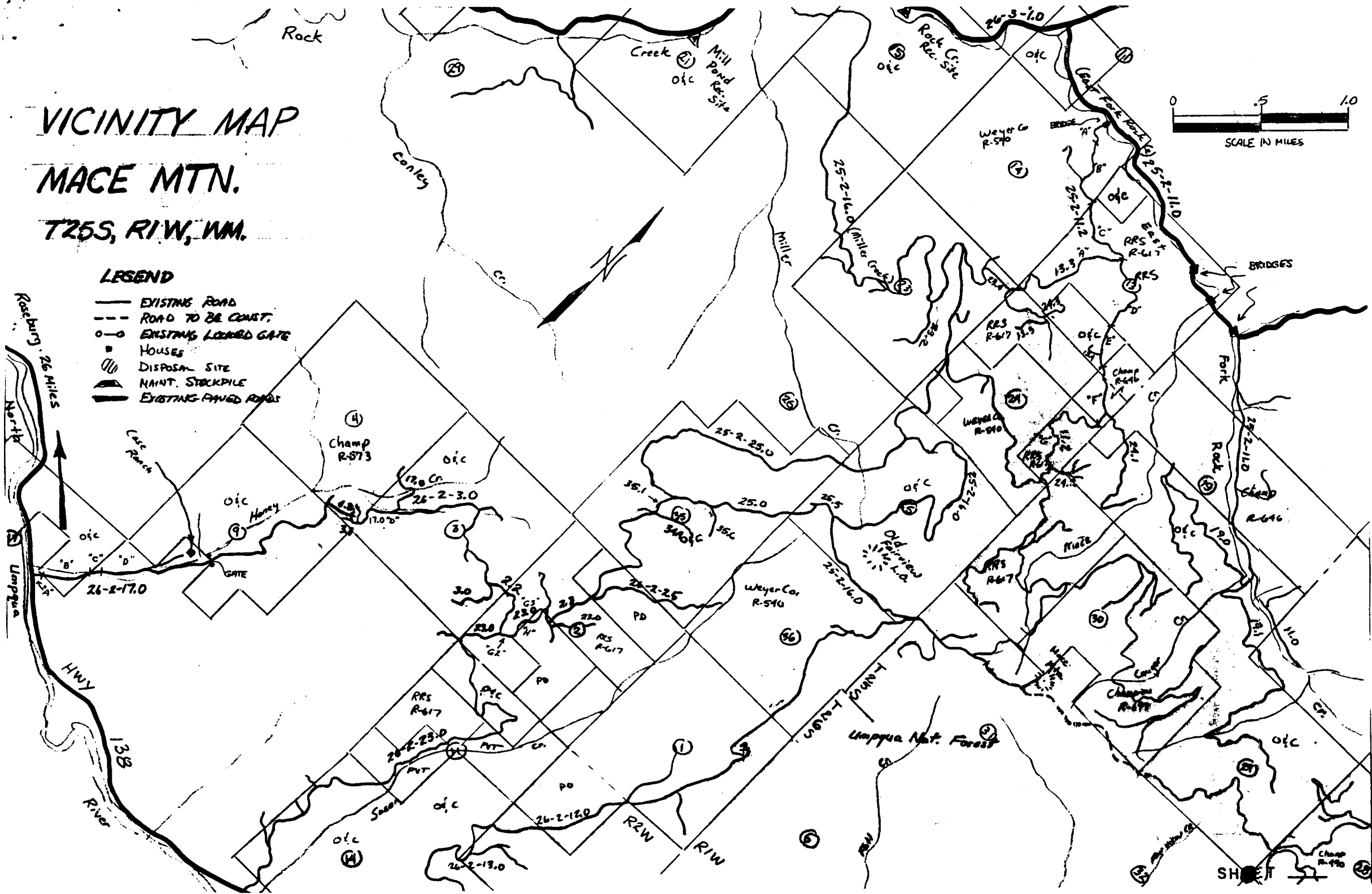
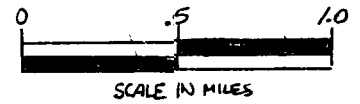

C.S. File No. 63/140

SHEET

3-17-92

FILED

th
APR 2 1992

Douglas County Surveyor

COUNTY SURVEYOR
DOUGLAS COUNTY, ORE.

Enclosed are visitation records for several corners I visited
in the past year.

There is one Renewal request.

Bill May
North Umpqua Resource Area
BLM
Roseburg
6-440-4930 Ext. 306

Rec'd 3/18/92

*Treat as corner reports
Per ED*

U.S. File No. 63/140

✓