

Rm. 122 - COURTHOUSE
ROSEBURG, OR 97470

DOUGLAS COUNTY SURVEYOR

PH. 672-3311
EXT. 114

^{V. 377}
CORNER RENEWAL REQUEST

Section 15 Twp. 24S Rge. 2W

Date 3/17/92

Condition of Corner and Accessories: 1969 DC Surveyor Brass Cap
in good condition.

Hemlock BT OK

50" Doug-fir BT (approx N83E 40') OK

FILED

APR 2 1992

COUNTY SURVEYOR
DOUGLAS COUNTY, ORE.

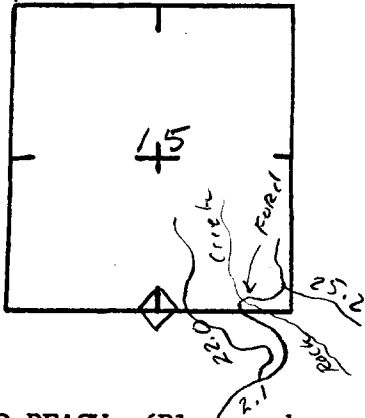

TO REACH: (Please show approximate distances, clearcuts, roads, fences, etc.) Follow Cat Trail West
about 400 ft 24-2-22.0 Road. See MAP

Notify immediately prior to renewal visit? Yes No

Notify following renewal visit? Yes No

Is corner in immediate danger of being lost or disturbed? Yes No

Name Bill May

Address BLM

777 NW GU Blvd

Telephone 440-4930

ADDITIONAL COMMENTS _____

C.S. File No. 62/11/92-2

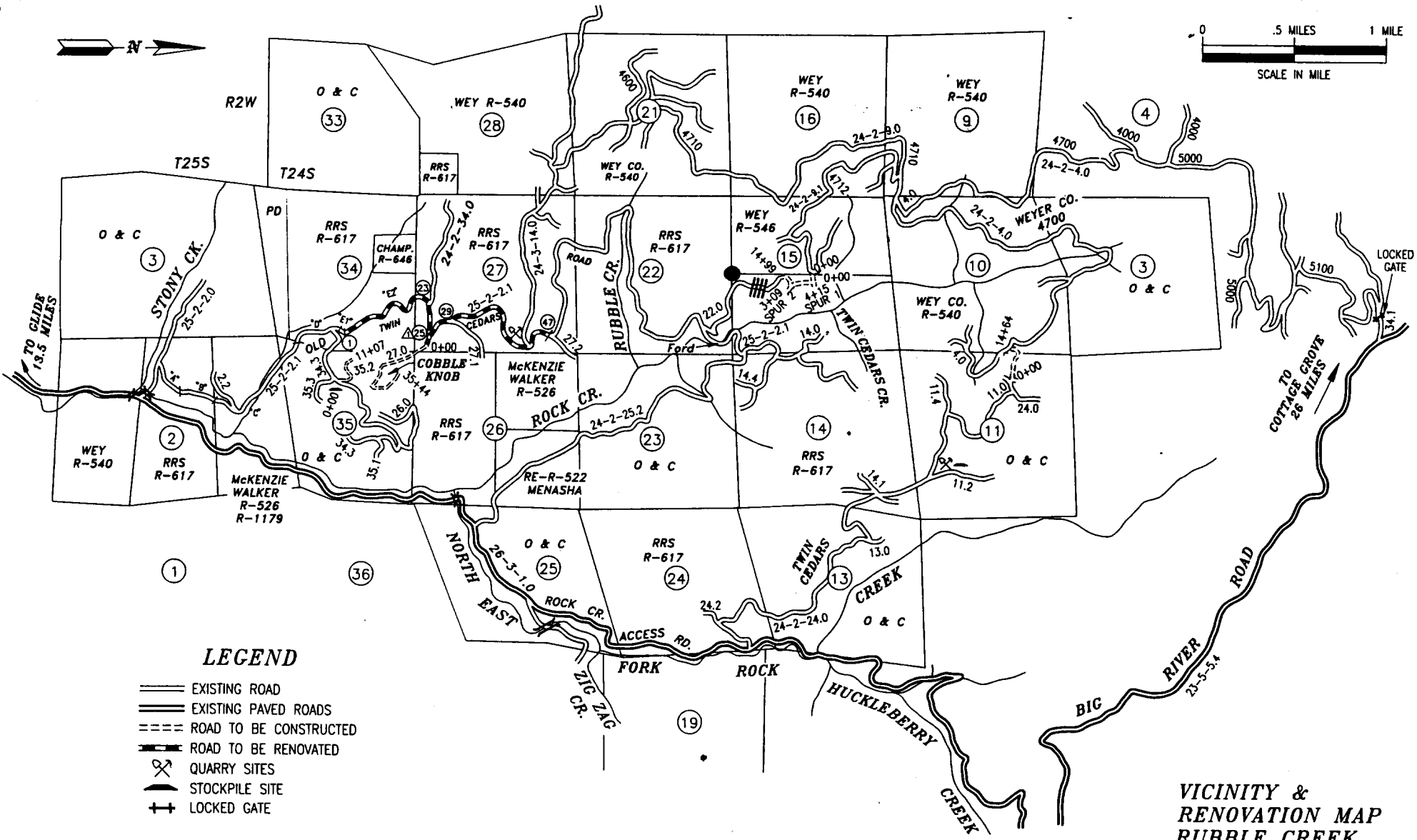
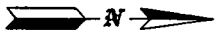

LEGEND

- EXISTING ROAD
- == EXISTING PAVED ROADS
- === ROAD TO BE CONSTRUCTED
- ROAD TO BE RENOVATED
- ⊗ QUARRY SITES
- STOCKPILE SITE
- + LOCKED GATE

VICINITY &
RENOVATION MAP
RUBBLE CREEK
T24S, R2W, W.M.

C.S. File No. 63/140

SHEET _____

3-17-92

FILED

th
APR 2 1992

Douglas County Surveyor

COUNTY SURVEYOR
DOUGLAS COUNTY, ORE.

Enclosed are visitation records for several corners I visited
in the past year.

There is one Renewal request.

Bill May
North Umpqua Resource Area
BLM
Roseburg
6-440-4930 Ext. 306

Rec'd 3/18/92

*Treat as corner reports
Per ED*

U.S. File No. 63/140