

FILED

JK
OCT 6 1992

M115-63

OREGON CORNER RESTORATION FORM

Section 26 Township 21S Range 7W

COUNTY SURVEYOR
DOUGLAS COUNTY, ORE.

County Douglas Date 07-07-92

CORNER DESIGNATION

Center 1/4 Corner
Section 26

- Condition Report Only
- Not Found
- Renewed
- Unrecorded
- Surveyed In
- Referenced Out

Previous Renewals/Surveys, etc. No previous surveys.

Monument(s) & Accessories Found: (Condition and Source)

None

Monument Detail

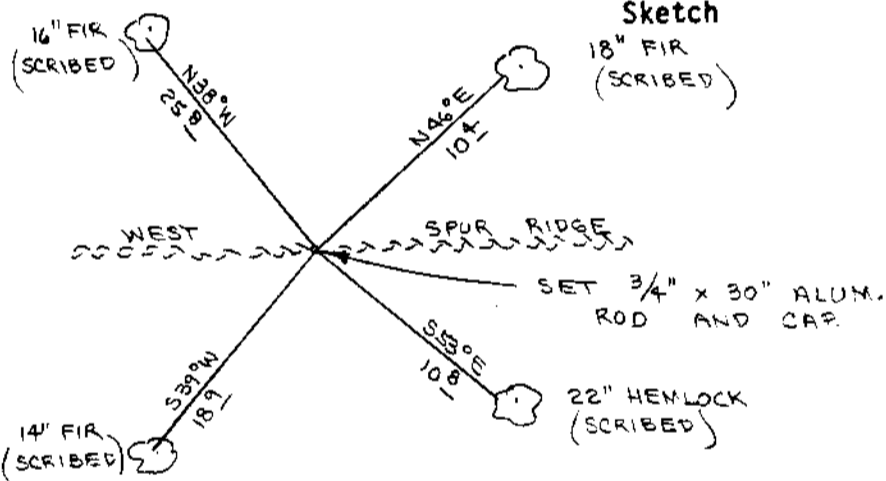

Monument Set (Procedures and Description)

Set 3/4" x 30" aluminum rod with 3 1/8" aluminum cap. Buried purple magnetic marker under 30" aluminum rod. Set 72" aluminum post, with land monument survey sign bolted to, beside aluminum rod. See filed survey for survey procedures.

New Accessories

- 14" Fir , S39W, 18.9' (Scribed/Painted Red/Brass Washers)
- 16" Fir , N38W, 25.8' (Scribed/Painted Red/Brass Washers)
- 18" Fir , N46E, 10.4' (Scribed/Painted Red/Brass Washers)
- 22" Hemlock, S55E, 10.8' (Scribed/Painted Red/Brass Washers)

Location & Comments

Corner lies on top of spur ridge. Ridge bears East & West.

Compass Declination 20 1/2

Firm/Agency Roberts Surveying, Inc.

Address 29 West 29th St. Eugene, Oregon 97405

Party Chief Stuart Duce

Notes _____

Witness Rick Jones

Surveyor's Seal

REGISTERED
PROFESSIONAL
LAND SURVEYOR

L. D. Roberts
OREGON
ACCOUNT 1975
L. D. ROBERTS
1039

C.S. File No. 63/138-22

FILED

M115-23

vh
OCT 6 1992

OREGON CORNER RESTORATION FORM

Section 26 Township 21S Range 7W

COUNTY SURVEYOR
DOUGLAS COUNTY, ORE.

County Douglas Date 07-02-92

CORNER DESIGNATION

West 1/16 Corner, South
Line Section 26.

- Condition Report Only
- Not Found
- Renewed
- Unrecorded
- Surveyed In
- Referenced Out

Previous Renewals/Surveys, etc. 1883 G.L.O. Survey by Laban Wheeler.
1981 B.L.M. Cadastral Survey.

Monument(s) & Accessories Found: (Condition and Source)

None

Monument Detail

Sketch

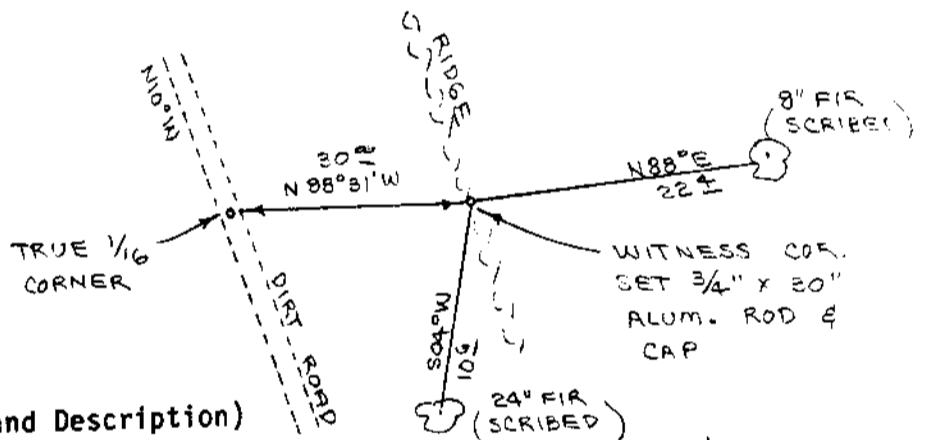

Monument Set (Procedures and Description)

Set 3/4" x 30" aluminum rod with 3/4" aluminum cap for witness corner to West 1/16 corner. True corner bears N88°31' W, 30.00 feet. True 1/16 corner falls in dirt road that is to be reconstructed. Set 72" aluminum post, with land monument survey sign bolted to, beside aluminum rod. See filed survey for survey procedures. Buried purple magnetic marker under 30" aluminum rod.

New Accessories

- 8" Fir, N88E, 22.4' (Scribed/Painted Red/Brass Washers)
- 24" Fir, S04W, 10.6' (Scribed/Painted Red/Brass Washers)

Location & Comments

Corner lies on top of
ridge and about 30' East
of dirt road. Ridge bears
North-South.

Compass Declination 20 1/2
Firm/Agency Roberts
Surveying, Inc.
Address 29 West 29th St.
Eugene, Oregon 97405
Party Chief Stuart Duce
Notes _____
Witness Rick Jones

Surveyor's Seal

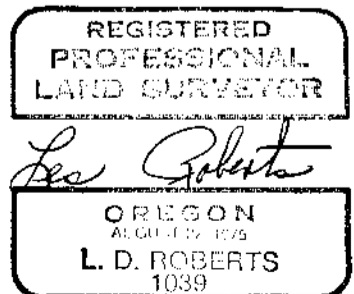

FILED

OCT 6 1992

M115-63

OREGON CORNER RESTORATION FORM

Section 26 Township 21S Range 7W

County Douglas Date 07-06-92

COUNTY SURVEYOR
DOUGLAS COUNTY, ORE.

CORNER DESIGNATION

South 1/16 Corner, West
Line Section 26

- Condition Report Only
- Not Found
- Renewed
- Unrecorded
- Surveyed In
- Referenced Out

Previous Renewals/Surveys, etc. 1883 G.L.O. Survey by Laban Wheeler.

Monument(s) & Accessories Found: (Condition and Source)

None

Monument Detail

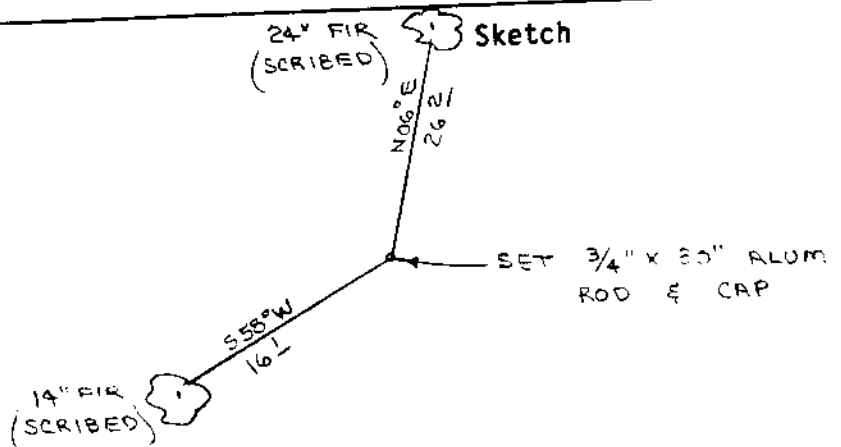

Monument Set (Procedures and Description)

Set 3/4" x 30" aluminum rod with 3/4" aluminum cap. Buried purple magnetic marker under 30" aluminum rod. Set 72" aluminum post, with land monument survey sign bolted to, beside aluminum rod. See filed survey for survey procedures.

New Accessories

- 14" Fir, S58W, 16.1' (Scribed/Painted Red/Brass Washers)
- 24" Fir, N06E, 26.2' (Scribed/Painted Red/Brass Washers)

Location & Comments

Compass Declination 20 1/2
 Firm/Agency Roberts
Surveying, Inc.
 Address 29 West 29th St.
Eugene, Oregon 97405
 Party Chief Stuart Duce
 Notes _____
 Witness Rick Jones

Surveyor's Seal

M115-63

FILED

JK

OCT 6 1992

OREGON CORNER RESTORATION FORM

Section 26 Township 21S Range 7W
County Douglas Date 06-11-92

COUNTY SURVEYOR
DOUGLAS COUNTY, ORE.

CORNER DESIGNATION

C.S. 1/16 Corner
Section 26

- Condition Report Only
- Not Found
- Renewed
- Unrecorded
- Surveyed In
- Referenced Out

Previous Renewals/Surveys, etc. No previous surveys.

Monument(s) & Accessories Found: (Condition and Source)
None

Monument Detail

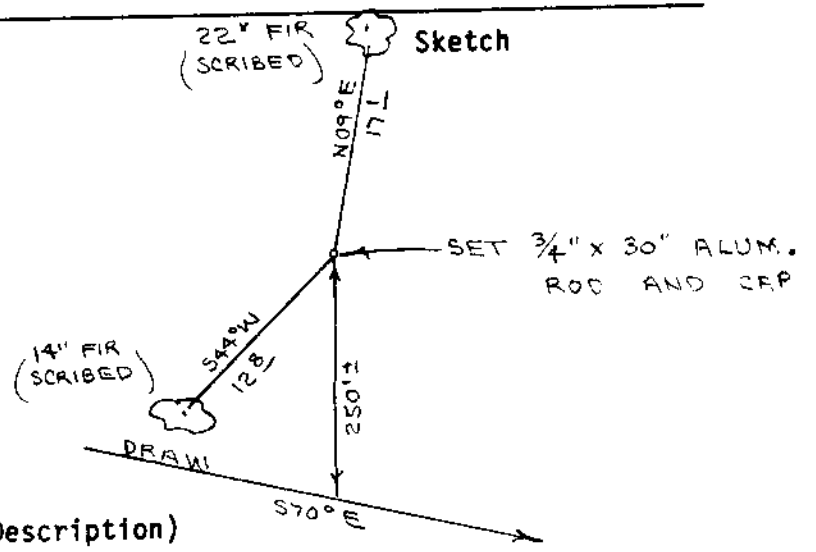

Monument Set (Procedures and Description)
Set 3/4" x 30" aluminum rod with 3/4" aluminum cap. Buried purple magnetic marker under 30" aluminum rod. Set 72" aluminum post, with land monument survey sign bolted to, beside aluminum rod. See filed survey for survey procedures.

New Accessories

- 14" Fir, S44W, 12.8' (Scribed/Painted Red/Brass Washers)
- 22" Fir, N09E, 17.1' (Scribed/Painted Red/Brass Washers)

Location & Comments

Corner lies on steep East Compass Declination 20 1/2
slope about 250' North of Firm/Agency Roberts
Draw. Draw bears S70E. Surveying Inc.
Address 29 West 29th St.
Eugene, Oregon 97405
Party Chief Stuart Duce
Notes
Witness Tim Bageant

Surveyor's Seal



C.S. File No. 63/138-22

M 115-63

FILED

JK

OREGON CORNER RESTORATION FORM

OCT 6 1992

Section 26 Township 21S Range 7W

COUNTY SURVEYOR
DOUGLAS COUNTY, ORE.

County Douglas Date 07-02-92

CORNER DESIGNATION

West 1/4 Corner
Section 26

- Condition Report Only
- Not Found
- Renewed
- Unrecorded
- Surveyed In
- Referenced Out

Previous Renewals/Surveys, etc. 1883 G.L.O. Survey by Laban Wheeler.
See corner renewal #28 in 1958.

Monument(s) & Accessories Found: (Condition and Source)

Found 1958 Douglas County Brass Cap set firmly in the ground.

50" Fir Stump, N71E, 41.0' (Scar Vis.), 1883 BT. Rec. N71E, 40.9'

66" Cedar Stump, S89W, 36.0' (Scribe Vis.), 1883 BT. Rec. West, 35.6'

20" Hemlock, S39W, 5.8' (Scar Vis.), 1958 BT. Rec. S39W, 5.9'

24" Cedar, N17E, 96.8' (Scribe Vis.), 1958 BT. Rec. N18E, 97.5'

Monument Detail

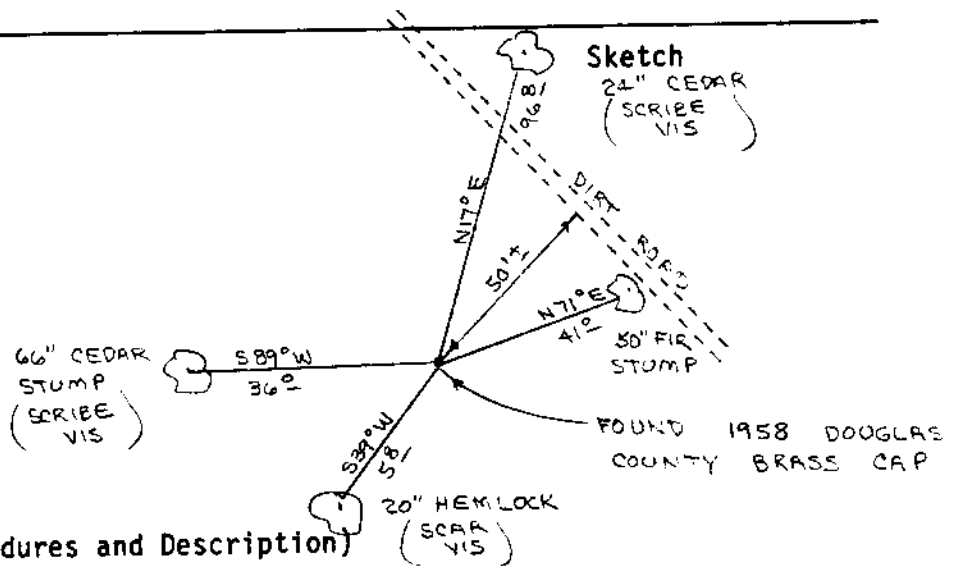

Monument Set (Procedures and Description)

New Accessories

Set 72" aluminum post, with land monument survey sign bolted to, beside
brass cap. Painted all bearing trees red.

Location & Comments

Corner lies on flat Compass Declination 20 1/2

ground about 50' West of Firm/Agency Roberts

dirt logging road. Road Surveying, Inc.

bear N20W and S20E, Address 29 West 29th St,

Eugene, Oregon 97405

Party Chief Les Roberts

Notes

Witness Stuart Duce.

Surveyor's Seal

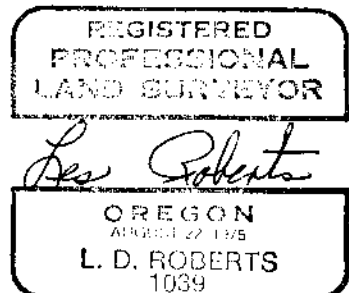

C.S. File No. 63/138-22
E

M115-63

FILED

jh

OCT 6 1992

OREGON CORNER RESTORATION FORM

Section 26 Township 21S Range 7W

County Douglas Date 07-07-92

COUNTY SURVEYOR
DOUGLAS COUNTY, ORE.

CORNER DESIGNATION

C.E. 1/16 Corner
Section 26

- Condition Report Only
- Not Found
- Renewed
- Unrecorded
- Surveyed In
- Referenced Out

Previous Renewals/Surveys, etc. No previous surveys.

Monument(s) & Accessories Found: (Condition and Source)

None

Monument Detail

Sketch

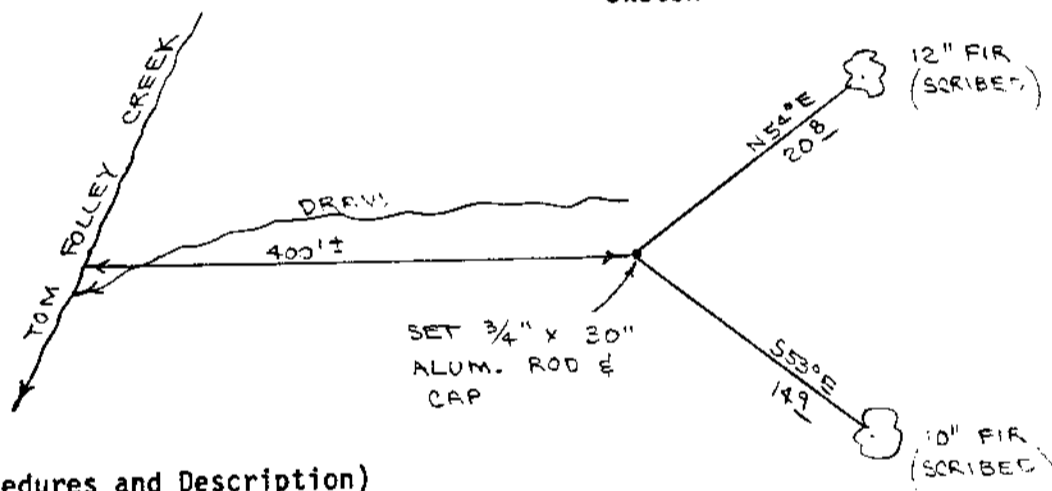

Monument Set (Procedures and Description)

Set 3/4" x 30" aluminum rod with 3/4" aluminum cap. Buried purple magnetic marker under 30" aluminum rod. Set 72" aluminum post, with land monument survey sign bolted to, beside aluminum rod. See filed survey for survey procedures.

New Accessories

- 10" Fir, S53E, 14.9' (Scribed/Painted Red/Brass Washers)
- 12" Fir, N54E, 20.8' (Scribed/Painted Red/Brass Washers)

Location & Comments

Corner lies on North slope about 400 feet East of Big Tom Folley Creek

Compass Declination 20 1/2

Firm/Agency Roberts Surveying, Inc.

Address 29 West 29th St. Eugene, Oregon 97405

Party Chief Stuart Duce

Notes

Witness Rick Jones

Surveyor's Seal

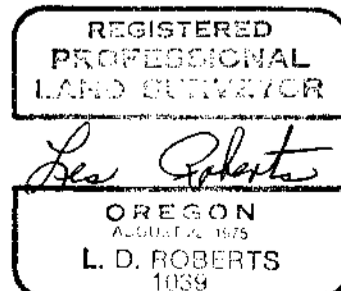

M 115-63

FILED

sh

OCT 6 1992

OREGON CORNER RESTORATION FORM

Section 26 Township 21S Range 7W

County Douglas Date 06-05-92

COUNTY SURVEYOR
DOUGLAS COUNTY, ORE.

CORNER DESIGNATION

South 1/4 Corner
Section 26

- Condition Report Only
- Not Found
- Renewed
- Unrecorded
- Surveyed In
- Referenced Out

Previous Renewals/Surveys, etc. 1883 G.L.O. Survey by Laban Wheeler.
1981 B.L.M. Cadastral Survey.

Monument(s) & Accessories Found: (Condition and Source)

Found 1981 B.L.M. Brass Cap set firmly in the ground.
22" Fir. N51E, 32.0' (Scar Vis.), 1981 BT. Record N51 1/2 E, 31.7'
24" Fir. S36E, 42.9' (Scar Vis.), 1981 BT. Record S35E, 42.5'

Monument Detail

Sketch

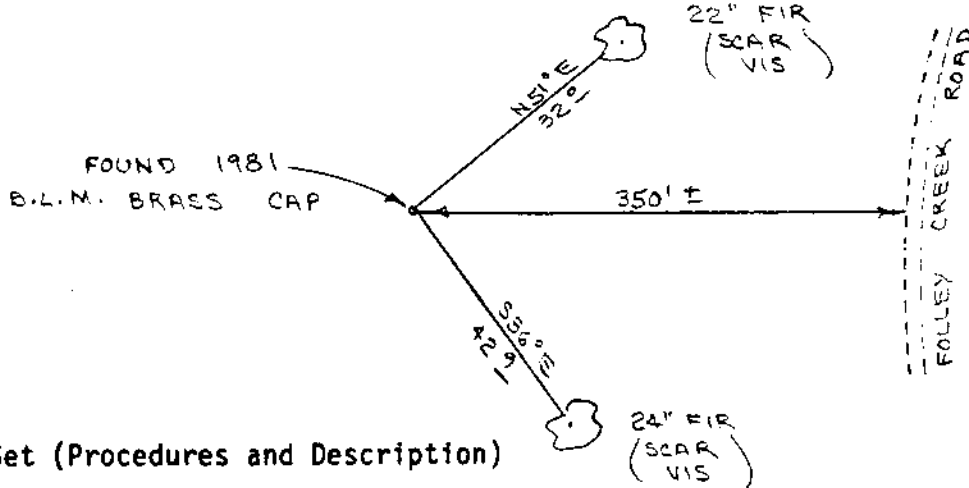

Monument Set (Procedures and Description)

New Accessories

Set 72" aluminum post, with land monument survey sign bolted to, beside
brass cap. Painted all bearing trees red.

Location & Comments

Corner lies on steep East Compass Declination 20 1/2
slope about 350 feet West Firm/Agency Roberts
of Big Tom Folley Creek Surveying Inc.
Road. Address 29 West 29th St,
Eugene, Oregon 97405
Party Chief Ted Baker
Notes _____
Witness Stuart Duce

Surveyor's Seal

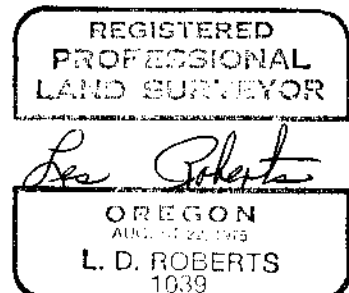

C.S. File No. 63/138-22

M 115-63

FILED

JH

OCT 6 1992

OREGON CORNER RESTORATION FORM

Section 26 Township 21S Range 7W

County Douglas Date 06-30-92

COUNTY SURVEYOR
DOUGLAS COUNTY, ORE.

CORNER DESIGNATION

S.W. Corner
Section 26

- Condition Report Only
- Not Found
- Renewed
- Unrecorded
- Surveyed In
- Referenced Out

Previous Renewals/Surveys, etc. 1883 G.L.O. Survey by Laban Wheeler.
1981 B.L.M. Cadastral Survey. See renewal #17 in 1957.

Monument(s) & Accessories Found: (Condition and Source)

- Found 1957 Douglas County Brass Cap set firmly in the ground.
- 16" Yew, S67W, 21.2' (Scar Vis.), 1883 BT. Record S66W, 21.1'
- 38" Fir Stump, S41E, 38.0' (No Marks), 1883 BT. Record S41E, 37.6'
- 44" Fir, N63W, 24.0' (Scar Vis.), 1883 BT. Record N65W, 23.1'
- 14" Fir, N14W, 10.1' (Scar Vis.), 1957 BT. Record N14W, 10.4'
- 20" Hemlock, N34E, 44.6' (Scar Vis.), 1957 BT. Record N33E, 45.6'
- 24" Hemlock, S16W, 40.1' (Scar Vis.), 1957 BT. Record S15 1/2 W, 40.8'
- 28" Fir, S84E, 44.1' (Scar Vis.), 1957 BT. Record S85E, 45.2'

Monument Detail

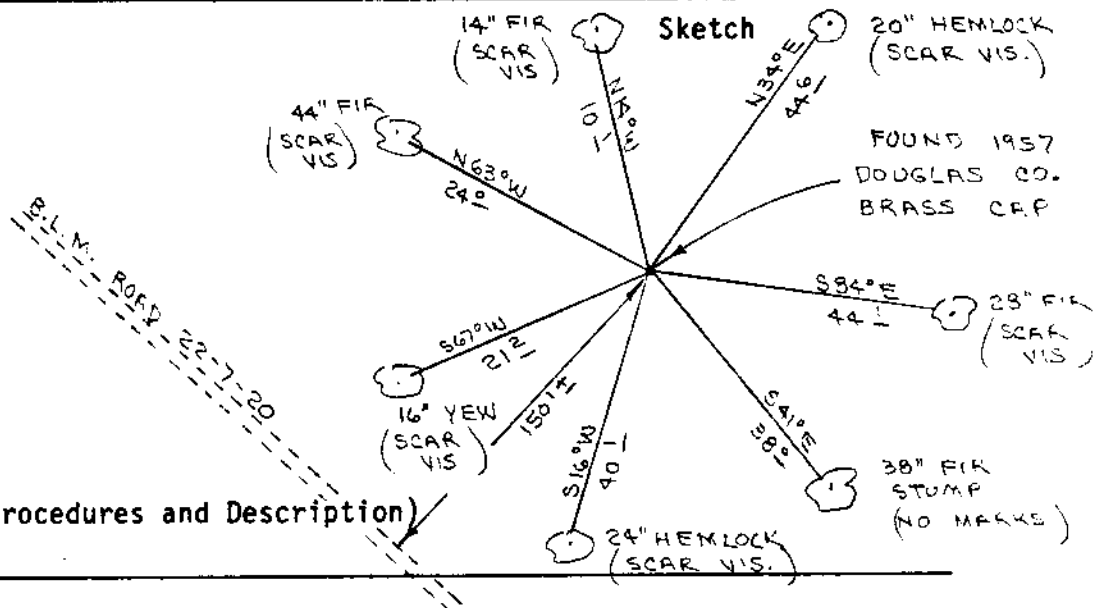

Monument Set (Procedures and Description)

New Accessories

Set 72" aluminum post, with land monument survey sign bolted to, beside
brass cap. Painted all bearing trees red.

Location & Comments

Corner lies on S.E. slope about 150' from B.L.M. Road 22-7-20.
Compass Declination 20 1/2
Firm/Agency Roberts Surveying, Inc.
Address 29 West 29th St. Eugene, Oregon 97405
Party Chief Ted Baker
Notes
Witness Stuart Duce

Surveyor's Seal



C.S. File No. 63/138-22

M115-63

FILED

oh

OCT 6 1992

OREGON CORNER RESTORATION FORM

Section 26 Township 21S Range 7W

County Douglas Date 06-07-92

COUNTY SURVEYOR
DOUGLAS COUNTY, ORE.

CORNER DESIGNATION

North 1/4 Corner
Section 26

- Condition Report Only
- Not Found
- Renewed
- Unrecorded
- Surveyed In
- Referenced Out

Previous Renewals/Surveys, etc. 1883 G.L.O. Survey by Laban Wheeler.
See renewal #48 in 1960, renewal #51 in 1961 and renewal #116 in 1984.

Monument(s) & Accessories Found: (Condition and Source)

- Found 1" x 1" x 36" "T" iron set by Wilford Haines in 1960.
- 26" Maple, N15E, 22.0' (No Marks), 1883 BT. Record N14E, 24.4'
- 54" Fir Snag, S01W, 38.0' (Bark Scribe), 1883 BT. Record South, 42.2'
- 16" Fir Stump, N11W, 58.5' (No Marks), 1961 BT. Record N11W, 58.8'
- 6" Fir, N54W, 20.3' (Scar Vis.), 1984 BT. Record N54 1/2 W, 20.1'
- 16" Cedar, S57E, 54.0' (Scar Vis.), 1984 BT. Record S57 1/2 E, 53.9'

Monument Detail

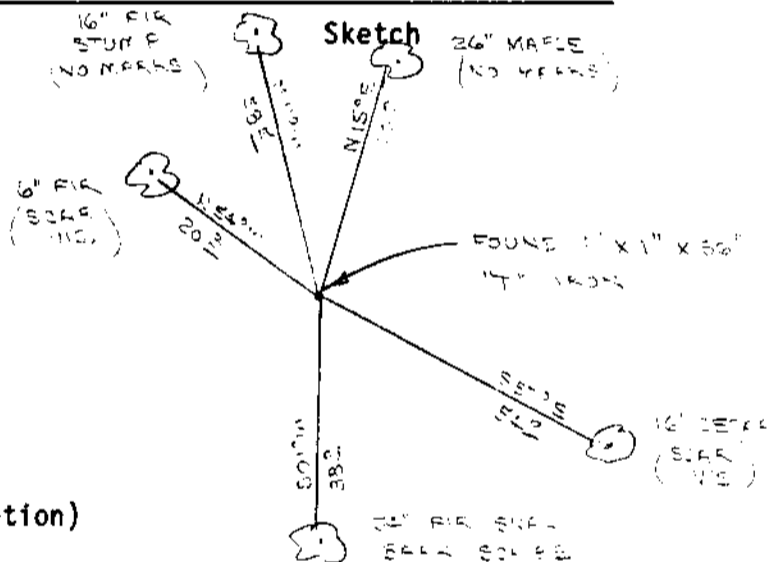

Monument Set (Procedures and Description)

New Accessories

Set 72" aluminum post, with land monument survey sign bolted to, beside
"T" iron. Painted all bearing trees red.

Location & Comments

Corner lies on very steep North slope at the head of a small draw. Compass Declination 20 1/2

Firm/Agency Roberts Surveying, Inc.

Address 29 West 29th St. Eugene, Oregon 97405

Party Chief Les Roberts

Notes

Witness Stuart Duce

Surveyor's Seal

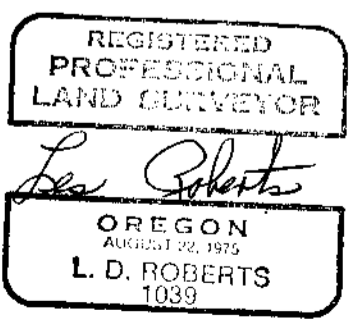

M 115-63

FILED

JK

OCT 6 1992

OREGON CORNER RESTORATION FORM

Section 26 Township 21S Range 7W

County Douglas Date 06-05-92

COUNTY SURVEYOR
DOUGLAS COUNTY, ORE.

CORNER DESIGNATION

East 1/4 Corner
Section 26

- Condition Report Only
- Not Found
- Renewed
- Unrecorded
- Surveyed In
- Referenced Out

Previous Renewals/Surveys, etc. 1883 G.L.O. Survey by Laban Wheeler.
1981 B.L.M. Cadastral Survey.

Monument(s) & Accessories Found: (Condition and Source)

Found 1981 B.L.M. Brass Cap set firmly in the ground.

5" Fir, N50W, 15.7' (Scar Vis.), 1981 BT. Record N49W, 15.8'

24" Fir, N64E, 18.3' (Scar Vis.), 1981 BT. Record N65 1/2 E, 18.1'

Monument Detail

Sketch

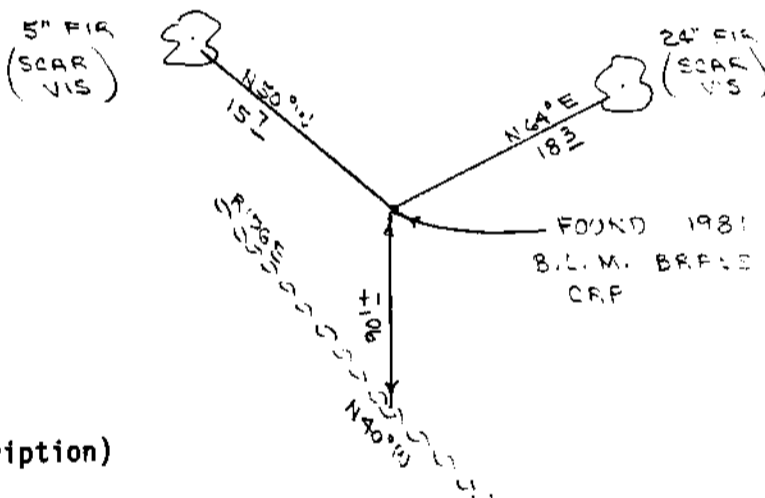

Monument Set (Procedures and Description)

New Accessories

Set 72" aluminum post, with land monument survey sign bolted to, beside
brass cap. Painted all bearing trees red.

Location & Comments

Corner lies on N.W. slope Compass Declination 20 1/2
about 90 feet North of spur Firm/Agency Roberts
ridge. Ridge bears N40W. Surveying, Inc.
Address 29 West 29th St.
Eugene, Oregon 97405
Party Chief Ted Baker
Notes _____
Witness Stuart Duce

Surveyor's Seal

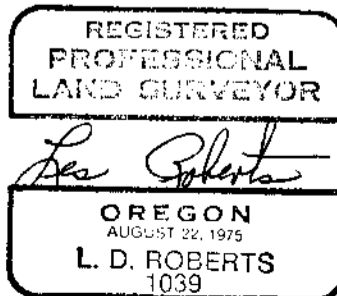

C.S. File No. 63/38-22