

1992-0063

FILED NW

OREGON CORNER RESTORATION FORM

SEP 23 1992

Section 14 & 15 Township 26 S Range 6 W

COUNTY SURVEYOR
DOUGLAS COUNTY, ORE.

County Douglas Date August 27, 1992

Corner Designation

1/4 Section Corner 15 & 14

- Condition Report Only
- Not Found
- Renewed
- Unrecorded
- Surveyed In
- Referenced Out

Previous Renewals/Surveys, etc.

Byren, March 12, 1959

Monument(s) & Accessories Found: (Condition and Source)

Found 1" Iron Pipe with 2 1/2" Brass Cap, from which a:
26" W. Oak BT, original BT, bears S58°E, 112.9 feet,
face overgrown.
24" W. Oak BT, now stump, bears N31 1/2°E, 99.7 feet.
24" B. Oak BT, N33°W, 55.8 feet, now gone.
24" B. Oak BT, S58°W, 28.0 feet, face overgrown.

Monument Detail

Sketch

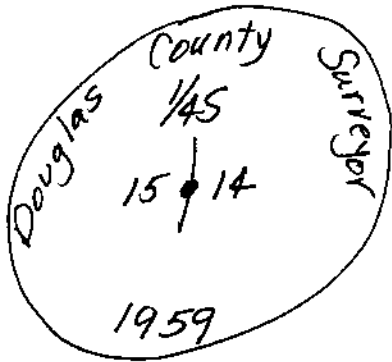

Monument Set (Procedures and Description)

None.

New Accessories

12" Oak BT, I scribed "S15 1/4 S BT", bears
N11°W, 68.0 feet.
12" Oak BT, I scribed "S14 1/4 S BT" bears
N73°E, 43.3 feet.

Location & Comments

Corner falls in
N & S fence line.

Compass Declination 20 1/2° E

Firm/Agency

Shaner Engineering, Inc.

Address P.O. Box 1430

Roseburg, OR 97470

Party Chief B. Shaner

Notes " "

Witness Jack Wright

Surveyor's Seal

REGISTERED
PROFESSIONAL
LAND SURVEYOR

Bruce A Shaner

OREGON
OCT. 4, 1957
BRUCE A. SHANER
430

1992-0063

FILED NW

OREGON CORNER RESTORATION FORM

SEP 23 1992

Section 14 Township 26S Range 6W

COUNTY SURVEYOR
DOUGLAS COUNTY, ORE.

County Douglas Date August 27, 1992

Corner Designation

Section Corner $\frac{15}{22} | \frac{14}{23}$

- Condition Report Only
- Not Found
- Renewed
- Unrecorded
- Surveyed In
- Referenced Out

Previous Renewals/Surveys, etc.

Byron, Feb. 11, 1959

Shaner, Nov. 5, 1982

Monument(s) & Accessories Found: (Condition and Source)

Found 1" Iron Pipe with 2 1/2" Brass Cap, from which a:

- 52" Oak BT, N25 1/2° W, 207.4 feet, now down & rotten.
- 32" Oak BT, N68° E, 46.2 feet, now down & rotten.
- 26" Oak BT, S76 3/4° E, 39.1 feet, healed over face.
- 26" Oak BT, S69° W, 23.7 feet, healed over face.
- 18" Oak BT, N61° E, 17.8 feet, " " "
- 16" Oak BT, N88° W, 44.2 feet, " " "

Monument Detail

Sketch

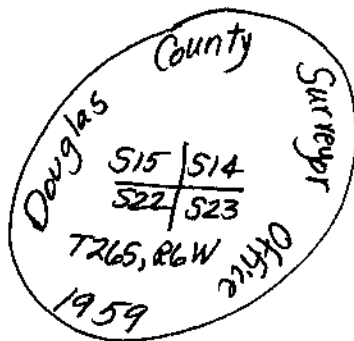

Monument Set (Procedures and Description)

None.

New Accessories

None.

Location & Comments

At fence corner
E, W & N.

Compass Declination 20 1/2° E

Firm/Agency Shaner Engineer-
ing, Inc.

Address P.O. Box 1430

Roseburg, OR 97470

Party Chief B. Shaner

Notes " "

Witness John A. Wright

Surveyor's Seal

REGISTERED
PROFESSIONAL
LAND SURVEYOR

Bruce A Shaner

OREGON
OCT. 4, 1957
BRUCE A. SHANER
430