

FILED

jh

OREGON CORNER RESTORATION FORM

JUN 12 1991

Section 33 Township 31s Range 8w

County Douglas Date 5/23/91

COUNTY SURVEYOR
DOUGLAS COUNTY, ORE.

Corner Designation

T 31 S R 8 W
S 28
1/4
S 33

- Condition Report Only
- Not Found
- Renewed
- Unrecorded
- Surveyed In
- Referenced Out

Previous Renewals/Surveys, etc. SEE Corner Renewal # 70, T. 31 S., R. 8 W., W.M.
Tied to by Howard Johnstone in 1981, SEE M 87-74

Monument(s) & Accessories Found: (Condition and Source) At corner found Brass Cap attached to a 1 inch iron pipe, Corner now has a 5 inch bend to the West, due to recent logging activity, I dug down around the iron pipe and it appears to be in the original place, as I found traces of flagging at various levels in the dirt, Pipe at 12 inches down is straight into the ground.
An orig. 57" now 66" D. Fir bears N 55° E., 26.8 ft not 25.1 ft., with visible scribe " 1/4 S28 CS BT " in unhealed blaze. BT alive and well. NOTE BT has 2 arrows chopped on its side, one at approx. center and one at a distance that would fit the 25.1 ft. recorded distance.
Laurel BT has been destroyed by recent logging activity.

Monument Detail

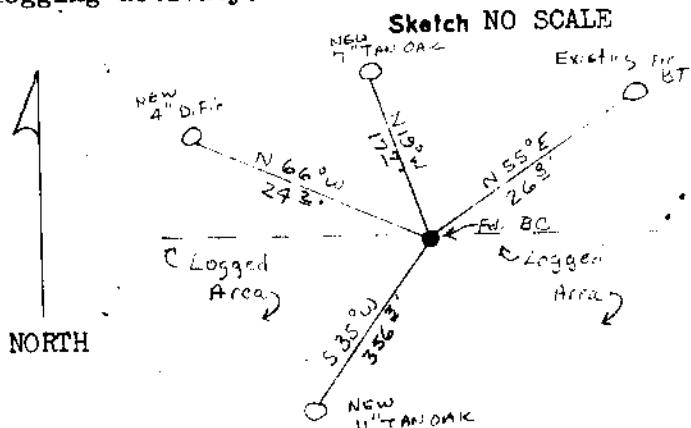
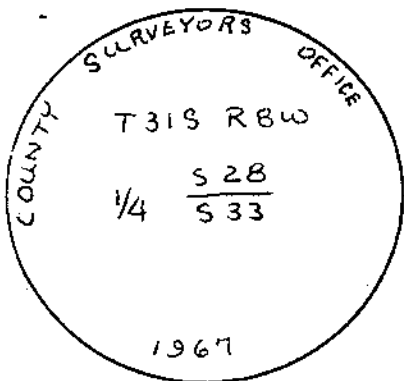

Monument Set: (Procedures and Description) At Corner, added rock mound 5" tall with 2 ft. diam. at base. Also placed a 6 ft. tall steel fence post, set 18" into ground, 1 foot North of Corner.

New Accessories New Bearing Trees:

A D. Fir, 4" diam., bears N 66° W, 24.2 ft. dist., mkd. " X BT "

A Tan Oak, 7" diam., bears N 19° W, 17.7 ft. dist., mkd. " 1/4 S28 BT "

A Tan Oak, 11" diam., bears S 35° W, 356.3 ft. dist., mkd. " 1/4 S33 BT "

11" Live Oak is closest tree in the Southwest quad.

No trees in Southeast quad.

Location & Comments

Corner is approx. 300 feet East from the end of B.L.M. Road # 32-8-4.2

Compass Declination 18° E

Firm/Agency PLS 2391
Raymond F. Brown

Address P.O. Box 539
Canyonville, OR. 97417

Party Chief R. Brown

Notes B. Landrum

Witness G. Perkins

Surveyor's Seal



C.S. File No. 63/129-10A

#824

C

FILED

jh

JUN 12 1991

OREGON CORNER RESTORATION FORM

Section 11 Township 32s Range 8w

County Douglas Date 5/23/91

COUNTY SURVEYOR
DOUGLAS COUNTY, ORE.

Corner Designation

S $\frac{1}{16}$

S 11 | S 12

- Condition Report Only
- Not Found
- Renewed
- Unrecorded
- Surveyed In
- Referenced Out

Previous Renewals/Surveys, etc. Corner set by B.L.M. 1975 in a Dependent Resurvey, Portion of Subdivisional Lines, T. 32 S., R. 8 W., W.M.

Monument(s) & Accessories Found: (Condition and Source) Found B.L.M. Brass Cap in good condition.

Bearing Trees:

An orig. 15" Sugar Pine now 22", bears N 40° 45' E, 72.60 ft with healed blaze, in good shape.

An orig. 23" Doug. Fir now 28" diam. stump, 6'-6" tall, bears N 87° 30' W, 115.30 ft. to center of stump, with healed blaze.

Monument Detail

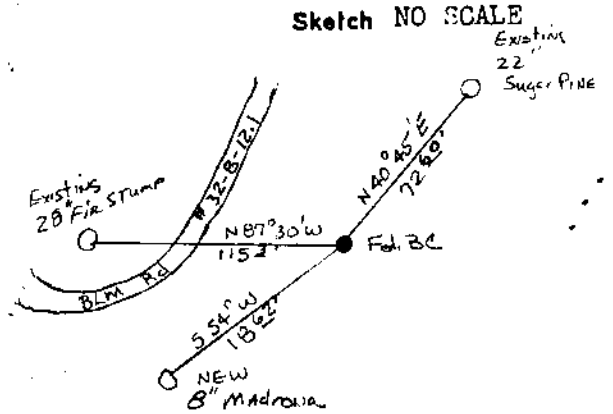
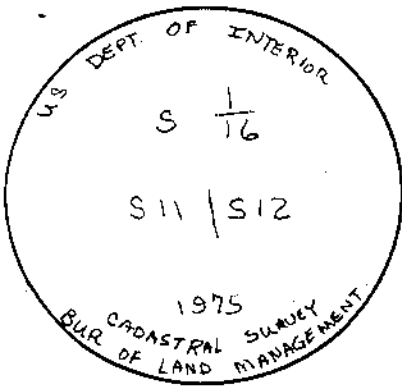

Monument Set: (Procedures and Description) At corner, placed 6 foot tall steel fence post, set 18" into ground, 1 foot West of corner.

New Accessories New Bearing Trees:

A Madrona, 8" diam., bears S 54° W, 18.62 ft. dist., mkd. "S1/16 S11 BT". Found existing Fir stump has been debarked, treated with a copper naphthanate solution and will be capped with galvanized metal by 7/01/91.

Location & Comments

Compass Declination 18° E
 Firm/Agency PLS 2391
Raymond F. Brown
 Address P.O. Box 539
Canyonville, OR. 97417
 Party Chief R. Brown
 Notes B. Landrum
 Witness G. Perkins

Surveyor's Seal



FILED

JK

JUN 12 1991

OREGON CORNER RESTORATION FORM

Section 7 Township 32s Range 8w

County Douglas Date 5/23/91

COUNTY SURVEYOR
DOUGLAS COUNTY, ORE.

Corner Designation

T 32 S R 8 W
1/4 $\frac{S 6}{S 7}$

- Condition Report Only
- Not Found
- XX Renewed
- Unrecorded
- Surveyed In
- Referenced Out

Previous Renewals/Surveys, etc. Corner set by B.L.M. 1975 in a Dependent Resurvey. Portion of Subdivisional Lines, T. 32 S., R. 8 W., W.M.

Monument(s) & Accessories Found: (Condition and Source) Found B.L.M. Brass Cap in good condition.

Bearing Trees:

An orig. 6" now 12" D. Fir, bears N 28° W, 34.66 ft with healed double blaze, in good shape. Added metal tag.

An orig. 54" now 54" D. Fir stump, 3 foot tall, bears S 20° E, 26.73 ft with partly healed blaze, some scribing visible. Stump to short and damaged for capping, has metal tag.

Monument Detail

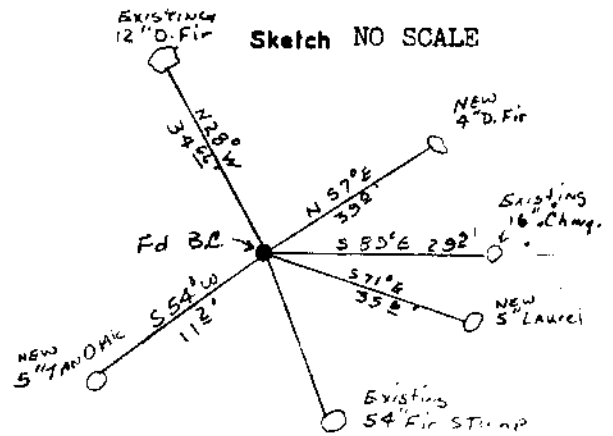
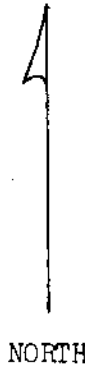
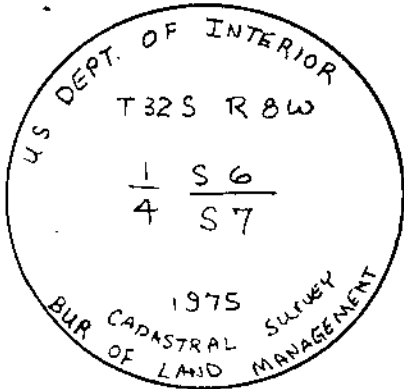

Monument Set: (Procedures and Description) At corner, placed 6 foot tall steel fence post, set 18" into ground, 1 foot Southwest of corner.

New Accessories New Bearing Trees:

A D.Fir, 4" diam., bears N 57° E, 39.0 ft. dist., mkd. "1/4 S6 BT" with tag.

A Laurel, 5" diam., bears S 71° E, 35.6 ft. dist., mkd. "1/4 S7 BT" with tag.

A Tan Oak, 5" diam., bears S 54° W, 11.2 ft. dist., mkd. "1/4 S7 BT" with tag.

Found existing Boundary Tree: A Chinquapin, 16" diam., bears S 89° E, 29.9 ft. dist., has line blaze marks and metal Boundary tag.

Location & Comments

Compass Declination 18° E
 Firm/Agency PLS 2391
Raymond F. Brown
 Address P.O. Box 539
Canyonville, OR. 97417
 Party Chief R. Brown
 Notes B. Landrum
 Witness G. Perkins

Surveyor's Seal



Raymond F. Brown

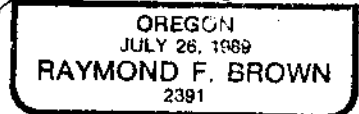

U.S. FILE NO. 63/129-10
c