

M 111-9

FILED

DEC 11 1990

OREGON CORNER RESTORATION FORM

Section 30 Township 21S Range 11W

County Douglas Date 06-27-90

COUNTY SURVEYOR
DOUGLAS COUNTY, ORE.

CORNER DESIGNATION

East 1/16 Corner
Section 30

- Condition Report Only
- Not Found
- Renewed
- Unrecorded
- Surveyed In
- Referenced Out

Previous Renewals/Surveys, etc. 1891 G.L.O. Survey by William Thiel, Survey M62-1 by Hintz in 1976, Survey M70-10 by Hintz in 1978, Survey M70-74 by Hintz in 1979, Survey M88-52 by Hintz in 1981 and Survey M92-12 by Hintz

Monument(s) & Accessories Found: (Condition and Source) in May of 1982.

Found 1 1/4" iron pipe with brass cap as set by Richard Hintz in Survey M70-74.

30" Cedar Stump, S20W, 30.3' (No Marks), 1979 BT. Record S20W, 30.6'

42" Fir Stump, N74E, 27.8' (No Marks), 1979 BT. Record N75 1/2 E, 44.3'

This corner falls 0.20' North and 0.43' West of my computed position for said 1/16 corner.

Monument Detail

Sketch

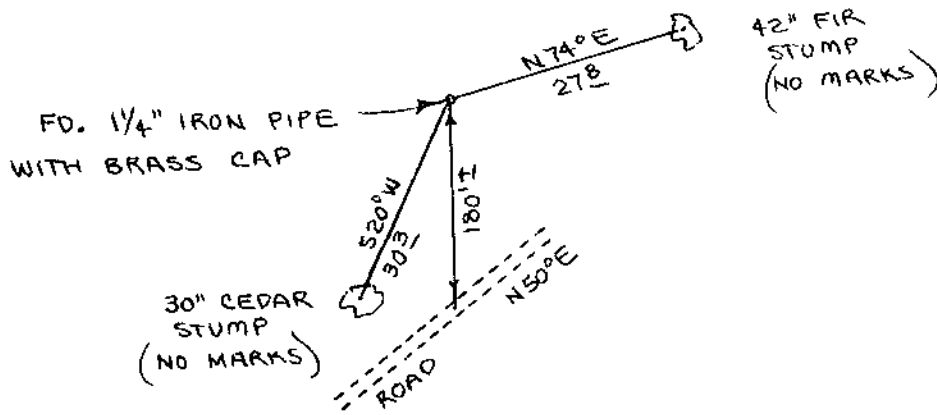

Monument Set (Procedures and Description)

New Accessories

Location & Comments

Corner lies on a North slope about 180' North of road. Compass Declination 20 1/2

Firm/Agency Roberts

Surveying Inc.

Address 29 West 29th St.

Eugene, Oregon 97405

Party Chief Les Roberts

Notes Ted Baker

Witness _____

Surveyor's Seal

REGISTERED
PROFESSIONAL
LAND SURVEYOR

Les Roberts
OREGON
AUGUST 22 1975
L. D. ROBERTS
1039