

M 111-9

FILED

rk

DEC 11 1990

OREGON CORNER RESTORATION FORM

Section 30 Township 21S Range 11W

County Douglas Date 07-02-90

COUNTY SURVEYOR
DOUGLAS COUNTY, ORE.

CORNER DESIGNATION

C.W. 1/16 Corner
Section 30.

- Condition Report Only
- Not Found
- Renewed
- Unrecorded
- Surveyed In
- Referenced Out

Previous Renewals/Surveys, etc. Survey M70-10 by Richard Hintz in 1978,
Survey M70-74 by Richard Hintz in 1979 and Survey M92-12 by Richard Hintz
in May of 1982.

Monument(s) & Accessories Found: (Condition and Source)

Found 1 1/4" iron pipe with brass cap as set by Richard Hintz in Survey M92-12.
Brass cap stamped "P.L.S. 497" and dated 1978.

24" Maple, N69E, 92.0' (Scribe Vis.), 1982 BT. Record N69 1/4 E, 92.3'

26" Spruce, N04E, 65.0' (Scribe Vis.), 1982 BT. Record N04 1/4 E, 65.1'

This corner falls 0.22' South and 0.24' East of my computed position for
said 1/16 corner. No new corner set.

Monument Detail

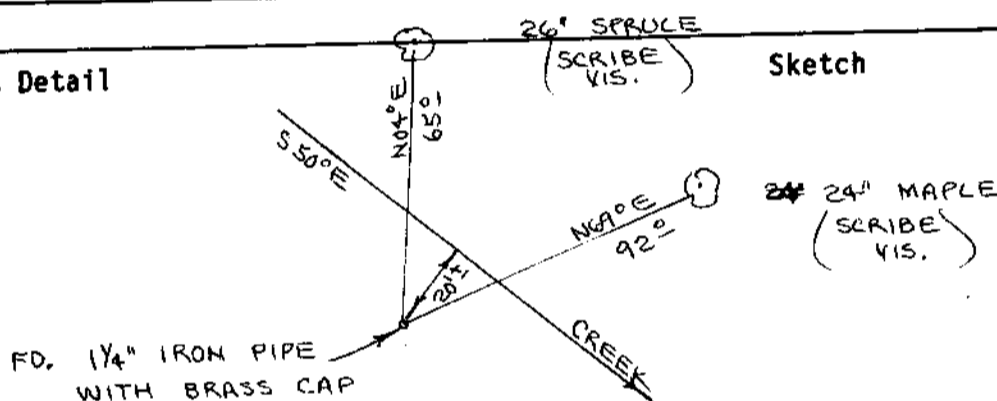

Sketch

Monument Set (Procedures and Description)

New Accessories

Set 60", Aluminum Post, with land monument survey sign bolted to, beside
iron pipe. Painted all bearing trees red.

Location & Comments

Corner lies on a N.E. slope about 20' Southwesterly of
a small creek. Compass Declination 20 1/2
Firm/Agency Roberts
Surveying Inc.

Address 29 West 29th St.
Eugene, Oregon 97405

Party Chief Ted Baker

Notes

Witness Harvey Christensen

Surveyor's Seal

REGISTERED
PROFESSIONAL
LAND SURVEYOR

Les Roberts

OREGON
AUGUST 20, 1975
L. D. ROBERTS
1039

C.S. File No. 63/126-17