

M111-10

FILED

DEC 11 1990

OREGON CORNER RESTORATION FORM

Section 11 Township 21S Range 11W

County Douglas Date 09-24-90

COUNTY SURVEYOR  
DOUGLAS COUNTY, ORE.

CORNER DESIGNATION

East 1/4 Corner  
Section 11

- Condition Report Only
- Not Found
- Renewed
- Unrecorded
- Surveyed In
- Referenced Out

Previous Renewals/Surveys, etc. 1891 G.L.O. Survey by William Theil, Survey M3-18 by Robert Kintigh in 1956, and Survey M96-23 by Ronald Stuntzner in 1984.

Monument(s) & Accessories Found: (Condition and Source)

Found 36" Fir Stump, S45 1/2 E, 6.6' (Scribe Vis.), 1891 B.T.

Found 5/8" Iron pin with 1 1/2" aluminum cap as set in survey M96-23.

3/4" iron pin was set by single proportionate measure and 1891 original B.T. was not found in survey M96-23.

Monument Detail

Sketch

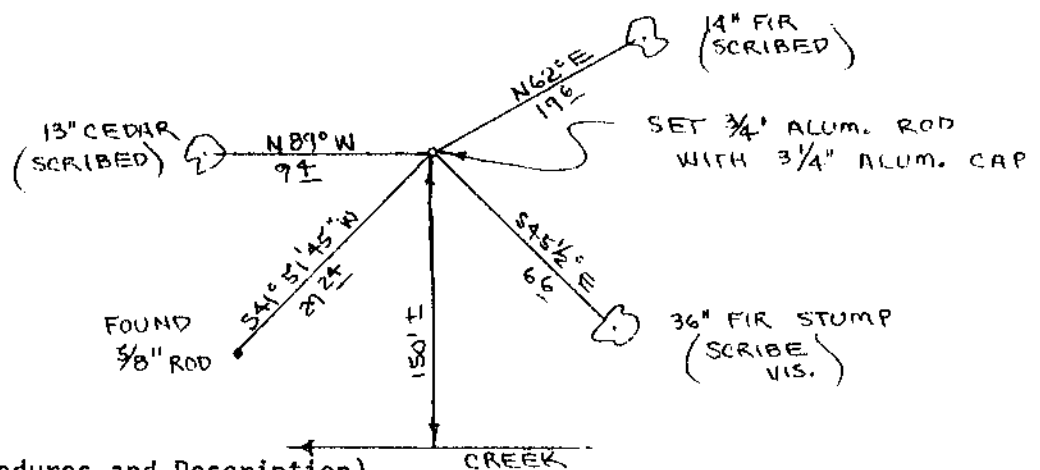

Monument Set (Procedures and Description)

Set 3/4" aluminum rod with 3 1/2" aluminum cap. Rod was set N45 1/2 W, 6.6 feet, center measure, from found 36" fir stump. Buried purple magnetic marker under 36" aluminum rod. Set 60" aluminum post, with land monument survey sign attached to, beside aluminum rod. 3/8" iron pin set in survey M96-23 bears S 41° 51' 45" W, 29.24'

New Accessories

13" Cedar, N89W, 9.4' (Scribed/Painted Red)

14" Fir, N62E, 19.6' (Scribed/Painted Red)

Location & Comments

Corner lies on a South slope about 150' North of Creek. Creek bears East and West.

Compass Declination 20 1/2  
Firm/Agency Roberts Surveying Inc.  
Address 29 West 29th St. Eugene, Oregon 97405  
Party Chief Ted Baker  
Notes \_\_\_\_\_  
Witness Harvey Christensen

Surveyor's Seal

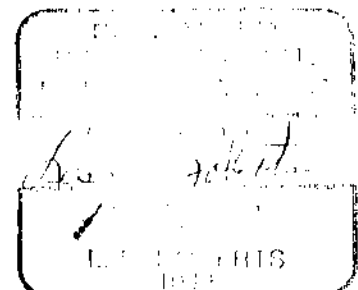

C.S. 1112 NO. 63/126-2