

# 1/16 SECTION LINE SURVEY

COUNTY SURVEYORS FILE DATA  
DO NOT REMOVE FROM OFFICE

FILED

SEP 17 1990

COUNTY SURVEYOR  
DOUGLAS COUNTY, ORE.

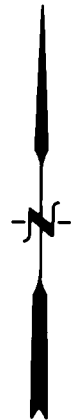

Located in:  
S.E. 1/4, SECTION 8,  
TOWNSHIP 28 SOUTH, RANGE 7 WEST,  
WILLAMETTE MERIDIAN, DOUGLAS COUNTY, OREGON.

AUGUST, 1990  
SCALE: 1" = 200'

Showing:  
THE SETTING OF A WITNESS CORNER  
N 89° 43' 39" W 100.24 FEET FROM THE S.E. 1/16  
CORNER TO SECTION 8, T. 28 S., R. 7 W., W.M.

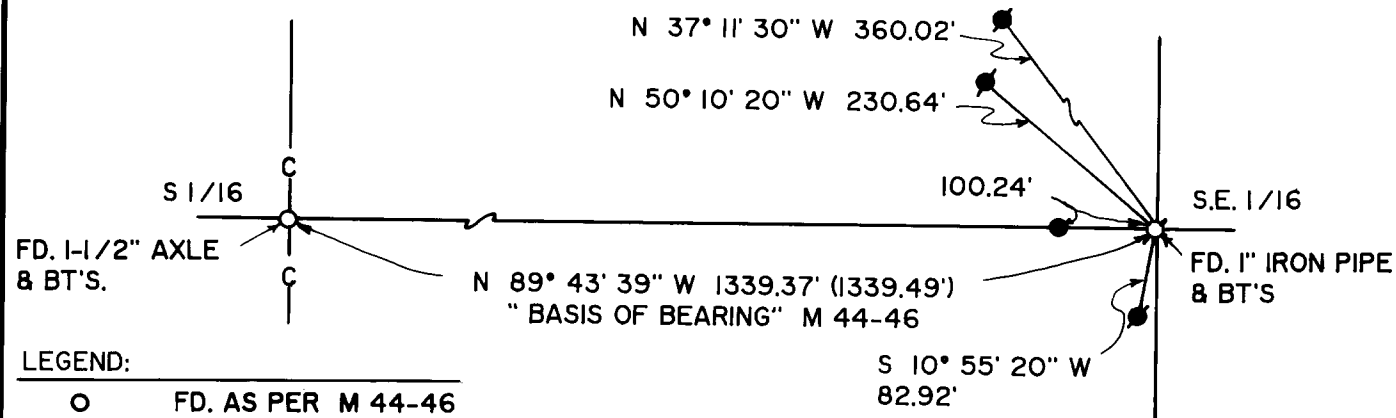

Prepared for:  
HUFFMAN & WRIGHT LOGGING  
P.O. BOX 910  
CANYONVILLE, OR. 97417

Prepared by:  
RAYMOND F. BROWN - P.L.S. 2391  
P.O. BOX 539  
CANYONVILLE, OR. 97417  
Phone: (503) 839-6185

LEGEND:

- FD. AS PER M 44-46
- ⊘ FD. AS PER M 44-46, REMOVED 8/10/90
- SET 5/8" X 30" IRON ROD WITH PLASTIC CAP ATTACHED MKD. " R. BROWN PLS 2391".
- SET 2" X 36" IRON PIPE WITH BRASS CAP ATTACHED MKD. " LS 2391, WC, SE 1/16, ↓, S 8, 1990". FROM WHICH A 12" MADRONA BEARS S 14° 16' W 40.8' FROM WHICH A 10" FIR BEARS N 32° 55' W 36.6'. BOTH BEARING TREES MKD. " X BT ".
- ( ) RECORD AS PER M 44-46.

REGISTERED  
PROFESSIONAL  
LAND SURVEYOR

*Raymond F. Brown*

OREGON  
JULY 26, 1989  
RAYMOND F. BROWN  
2391

NARRATIVE:

PURPOSE OF THE SURVEY WAS TO SET A WITNESS CORNER FOR THE S.E. 1/16 CORNER TO SECTION 8. FIELD INVESTIGATION LOCATED THE SAID FOUND CORNERS. A WITNESS CORNER WAS SET BECAUSE SAID S.E. 1/16 CORNER FALLS IN A CUT BANK OF A NEW LOGGING ROAD. THE SAID SET 5/8" IRON RODS WERE SET PRIOR TO EXCAVATION AND THE WITNESS CORNER WAS SET AFTER ROAD CONSTRUCTION. M 44-46 WAS USED AS CONTROL.