

FILED

NOV 15 1990

OREGON CORNER RESTORATION FORM

Section 11 Township 20S Range 9 W

County Douglas Date 11-09-90

COUNTY SURVEYOR
DOUGLAS COUNTY, ORE.

CORNER DESIGNATION

East 1/16 Corner, South
Line Section 11

- Condition Report Only
- Not Found
- Renewed
- Unrecorded
- Surveyed In
- Referenced Out

Previous Renewals/Surveys, etc. 1954 B.L.M. Survey, 1972 Dick Hintz
Survey in Section 12 and a 1986 Don Branch Survey

Monument(s) & Accessories Found: (Condition and Source)

Found 3" International Paper Aluminum Cap on a 5/8" aluminum rod.
31" Fir Stump, S88W, 39.0' (Scribe Vis.), 1986 BT. Record S88W, 39.0'
31" Fir Stump, N20 1/2 E, 56.9' (Scribe Vis.), 1986 BT. Record N20 1/2 E, 56.8'

Monument Detail

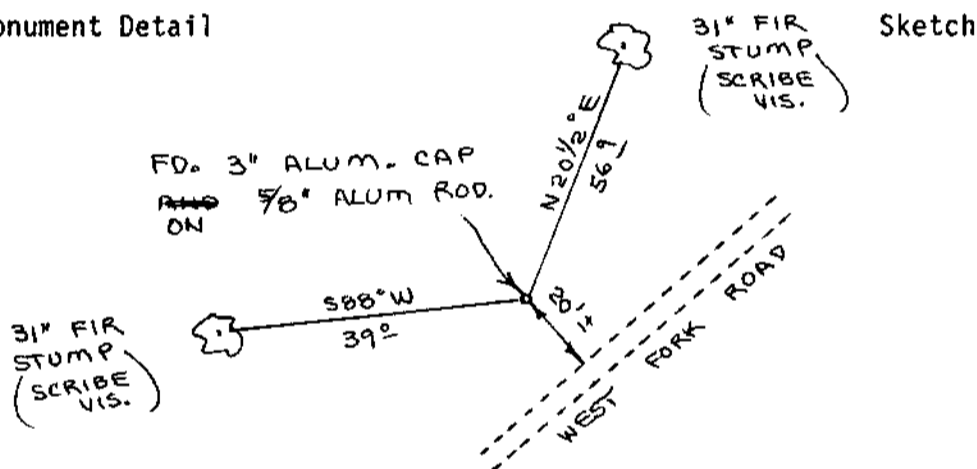

Monument Set (Procedures and Description)

New Accessories

Placed 48" x 48" square sheet of aluminum on top of S.W. bearing tree
as per B.L.M. specification. Soaked top of stump with Cuprinol wood
preservative.

Location & Comments

Corner lies 20' North- Compass Declination 20 1/2
westerly of West Fork Firm/Agency Roberts
Road Surveying Inc.
Address 29 West 29th
Street, Eugene, Oregon
Party Chief Ted Baker
Notes
Witness Harvey Christensen

Surveyor's Seal

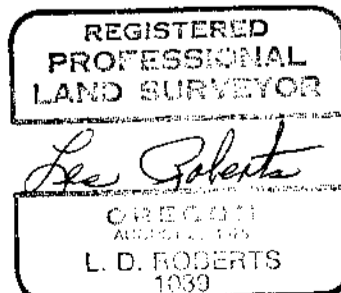

O.S. File No. 63/104-65