

OREGON CORNER RESTORATION FORM

FILED

JK

Section 6 Township 235 Range SW

NOV 5 1990

County DOUGLAS Date 6/90

COUNTY SURVEYOR
DOUGLAS COUNTY, ORE.

Corner Designation

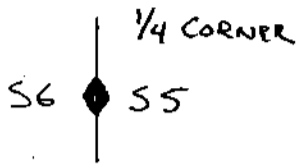

- Condition Report Only
- Not Found
- Renewed
- Unrecorded
- Surveyed In
- Referenced Out

Previous Renewals/Surveys, etc. _____

Monument(s) & Accessories Found: (Condition and Source)

- ✓ CORNER IS A 3 1/2" ALUMINUM CAP 0.4 FT ABOVE GROUND IN GOOD CONDITION
- ✓ 7" D.F. BEARS N56°W 13.2 FT; WALL HEADED FACE & BLM B.T. TAG
- ✓ 19" D.F. BEARS S14°E 29.1 FT; WALL HEADED FACE & BLM B.T. TAG
- METAL FENCE POST BEARS SOUTH 0.2 FT.

Monument Detail

Sketch

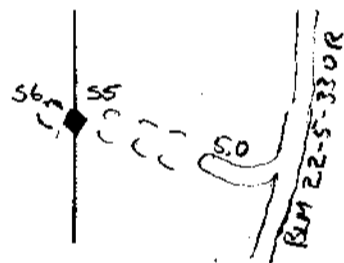
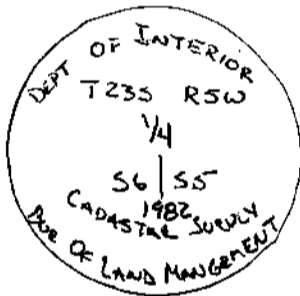

Monument Set (Procedures and Description)

New Accessories

PAINTED FACES AND WROTE B.T. ON TREE TRUNKS OF ALL B.T.'S
WITH FLOUR ORANGE PAINT.

Location & Comments

CORNER LIES ON CREST Compass Declination 19 1/2
OF MAIN RIDGE BEARING Firm/Agency LOWE ROUS
N20°W TIMBER COMPANY
 Address P.O. BOX 1127
ROSBURG
 Party Chief KEVIN HOFFINE
 Notes _____
 Witness _____

Surveyor's Seal

REGISTERED
PROFESSIONAL
LAND SURVEYOR

Ken W. Hoffine

OREGON
JULY 18, 1987
KEN W. HOFFINE
2291