

FILED

*JK*

NOV 5 1990

OREGON CORNER RESTORATION FORM

Section 26 Township 22S Range 7W

County DOUGLAS Date 3/90

COUNTY SURVEYOR  
DOUGLAS COUNTY, ORE.

Corner Designation

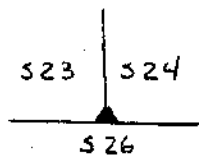

- Condition Report Only
- Not Found
- Renewed
- Unrecorded
- Surveyed In
- Referenced Out

Previous Renewals/Surveys, etc. \_\_\_\_\_

Monument(s) & Accessories Found: (Condition and Source)

- 172 - CORNER IS A 1" I.P. WITH DOUGLAS COUNTY SURVEYOR BRASS CAP, WITH A 1"x1" T-IRON SET BY HAINES ALONG SIDE. CORNER IS IN GOOD CONDITION.
- #125 Rec 15 N31 1/2° E - 26" DE BEARS N 31 1/2° E, 29' FT. HEALED FACE WITH BOTH COUNTY AND BLM B.T TAGS - ORIGINAL B.T.
- Ren #125 ✓ 34" DE BEARS S 23° E 13.3' FT. WELL HEALED FACE WITH BOTH COUNTY AND BLM B.T TAGS
- No Record - 8" MAPLE BEARS WEST 152.5 FT. SCRIBING VISIBLE NO B.T. TAG. SO BUT UP A LARGE ROCK TIMBER LOCATION TAG WITH ABOVE INFORMATION

Monument Detail

Sketch

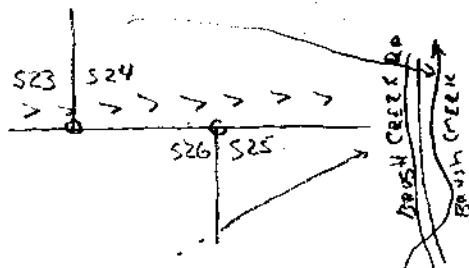
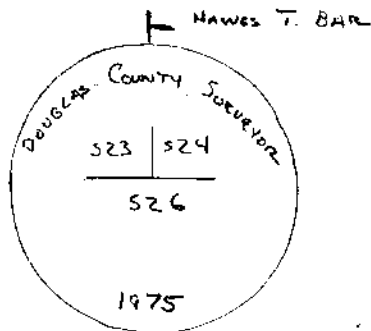

Monument Set (Procedures and Description)

\_\_\_\_\_  
 \_\_\_\_\_  
 \_\_\_\_\_  
 \_\_\_\_\_

New Accessories

WE PAINT FACES AND PAINT B.T. ON TREE TRUNKS OF ALL B.T.'S WITH FLUOR RED PAINT

Location & Comments

CORNER SITS ON STEEP Compass Declination 19 1/2°  
S.E. SLOPE APPROX Firm/Agency LOWE ROCK  
400 FT WEST OF CORNER TIMBER COMPANY  
COR. FOR S 25 AND Address P.O. Box 1127  
S 26 ROSEBURG  
Party Chief KEN HOFFINE  
Notes  
Witness GARY ANGIOLAT

Surveyor's Seal

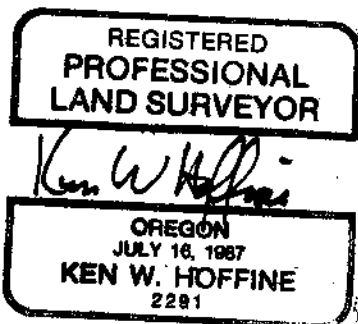

#1944

C